

PROPRIETARY ITEM - EXCEPT FOR USES EXPRESSLY GRANTED IN WRITING INFORMATION DISCLOSED HEREON IS CONFIDENTIAL AND ALL RIGHTS RESERVED BY SOUTHCO, INC.

DRAWING NUMBER		SCALE		DATE		MATERIAL		FINISH/COLOR		DRAWING CHKD	
J-H3-50-101-0		MILLIMETERS		15 MAY 08		STEEL		ZINC PLATE		IR ACH DNS	
DRAWING NUMBER		SCALE		DATE		MATERIAL		FINISH/COLOR		DRAWING CHKD	
J-H3-50-101-0		MILLIMETERS		15 MAY 08		STAINLESS		PASSIVATED		IR ACH DNS	
DRAWING NUMBER		SCALE		DATE		MATERIAL		FINISH/COLOR		DRAWING CHKD	
J-H3-50-101-0		MILLIMETERS		15 MAY 08		ZAMAC 3		BLACK POWDERCOAT		IR ACH DNS	
DRAWING NUMBER		SCALE		DATE		MATERIAL		FINISH/COLOR		DRAWING CHKD	
J-H3-50-101-0		MILLIMETERS		15 MAY 08		ZAMAC 3		NATURAL		IR ACH DNS	
DRAWING NUMBER		SCALE		DATE		MATERIAL		FINISH/COLOR		DRAWING CHKD	
J-H3-50-101-0		MILLIMETERS		15 MAY 08		ZAMAC 3		CHROME PLATE		IR ACH DNS	
DRAWING NUMBER		SCALE		DATE		MATERIAL		FINISH/COLOR		DRAWING CHKD	
J-H3-50-101-0		MILLIMETERS		15 MAY 08		ZAMAC 3		NATURAL/BLACK		IR ACH DNS	

ALL DIMENSIONS WITHOUT TOLERANCES ARE FOR REFERENCE ONLY.

A3 PAPER SIZE THIRD ANGLE PROJECTION SHEET 1 OF 2

PART NUMBER: H3-50-**A** **LL**-0 **FF**

- PADLOCK/SERIES:
- 1 = NO PADLOCK, MULTIPoint, GEARBOX
 - 2 = PADLOCK, MULTIPoint, GEARBOX
 - 3, 4 = ACTUATOR VERSIONS
- LOCKING OPTIONS:
- 00 = NO LOCK PROVIDED (DIN ONLY)
 - 01 = CH751
 - 02 = 300
 - 03 = 333
 - 04 = NON LOCKING
 - 20 = NON LOCKING DIN WITH DETENT
 - 21 = DIN CH751
 - 22 = DIN 300
 - 23 = DIN 333
 - 24 = DIN, W/O LOCK PLUG
 - 40 = TOOL, 3mm DOUBLE BIT
 - 41 = TOOL, 5mm DOUBLE BIT
 - 42 = TOOL, TELCORDIA 216 (BELL CORE)
 - 43 = TOOL, ELECTRONICS KEY
 - 45 = TOOL, 8mm HEX RECESS
 - 47 = TOOL, 8mm TRIANGLE
 - 70 = DIN TOOL, 3mm DOUBLE BIT
 - 71 = DIN TOOL, 5mm DOUBLE BIT
 - 72 = DIN TOOL, TELCORDIA 216
 - 73 = DIN TOOL, ELECTRONICS KEY
 - 77 = DIN TOOL, 8mm TRIANGLE
 - 78 = DIN TOOL, 7mm SQUARE
- ASSEMBLY FINISH:
- 44 = SATIN CHROME
 - 50 = BLACK POWDER COAT
- OTHERS AVAILABLE UPON REQUEST
- COVERED IN J-H3-50-301-0 OR J-H3-50-301-1

SEE SHEET 2 FOR VIEWS OF DIN AND TOOL ACCESS VERSIONS

GRIP TABLE
CAM
PART No. E5-61YY

YY	GRIP	YY	GRIP
09	24.9	16	38.9
10	26.9	17	40.9
11	28.9	18	42.9
12	30.9	19	44.9
13	32.9	20	46.9
14	34.9	21	48.9
15	36.9	22	50.9

SEE J-E5-61-A

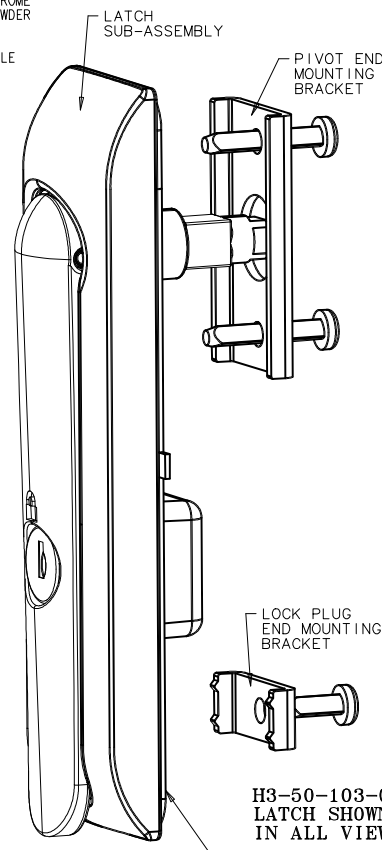

H3-50-103-0XX LATCH SHOWN IN ALL VIEWS

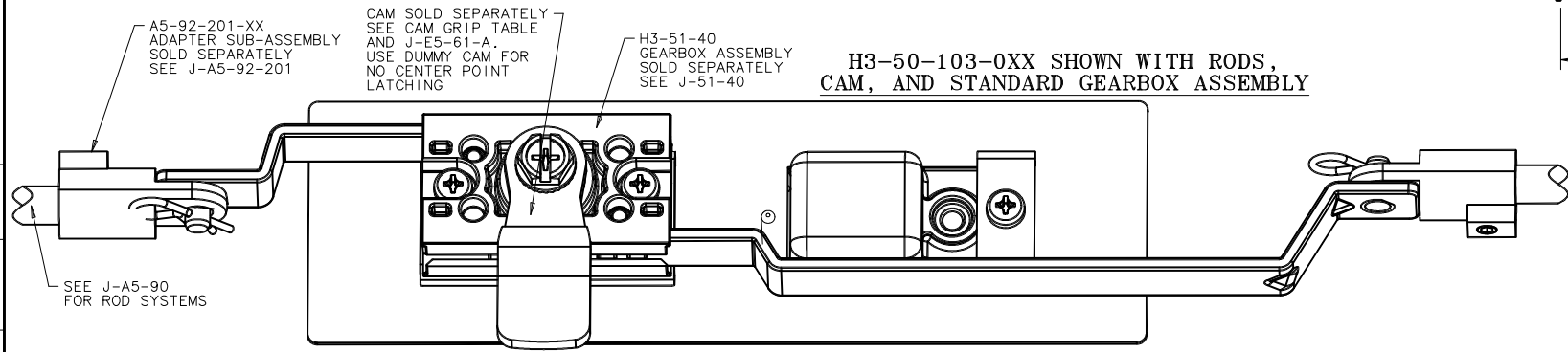
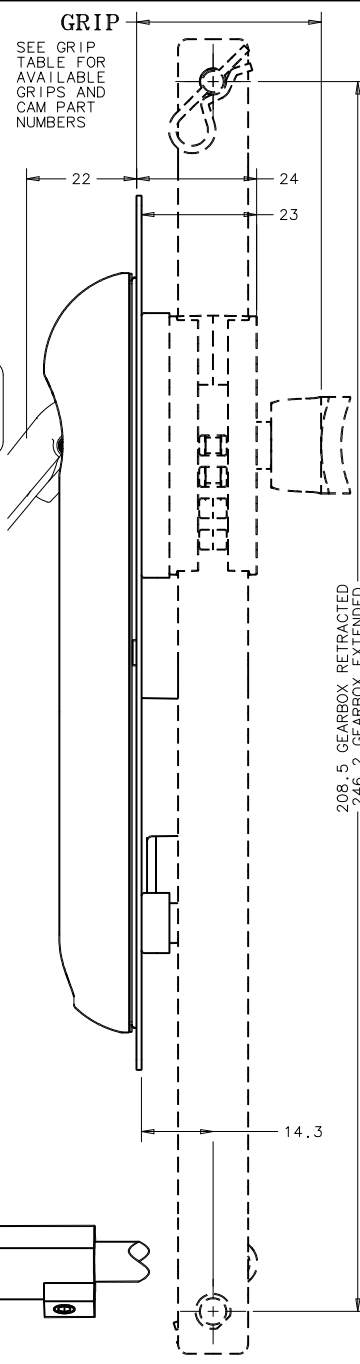
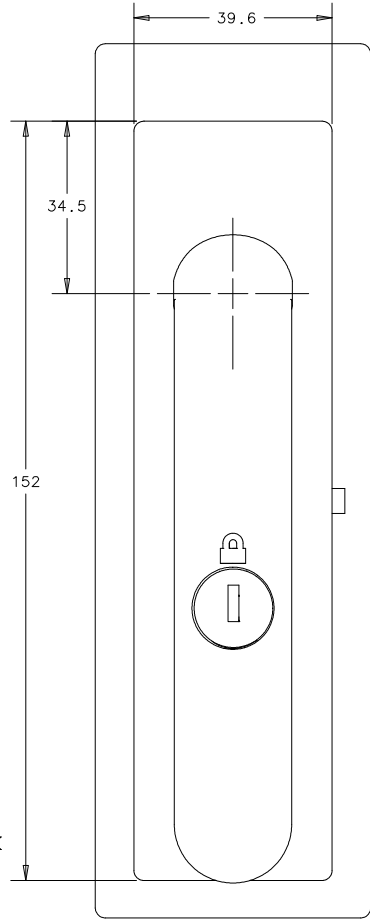

A	103NOV2008	IR/DLH	RELEASED FOR PRODUCTION
B	125NOV2008	IR/A	CH
C	04 FEB 09	IR/A	CH
D	22SEP2014	OMS/RGL	PRN: P2014-1872
E	22APR2016	OMS/MLS	PRN: P2016-0894
F	03AUG2016	OMS/LCK	PRN: P2016-1781

DESCRIPTION	MATERIAL	FINISH/COLOR	DESCRIPTION	FINISH/COLOR
HANDLE	ZAMAC 3	BLACK POWDERCOAT	HANDLE COVER	DISC SPRING
HOUSING		NATURAL	DUMMY CAM	M4x0.7 SCREWS
TOOL ACTUATOR		CHROME PLATE	CAM SCREW	HANDLE PIN
SHAFT		NATURAL/BLACK	PAWLL SPRING	RETAINER
LOCKING PAWL				
LOCK PLUG				
DIN LOCK ASSY	SANTOPRENE			
PANEL GASKET	BUNA-N			
HANDLE BUMPER				
SHAFT O-RING				

DATE	15 MAY 08	
DRAWN	CHKD	SCALE
IR	ACH	DNS
DRAWING NUMBER		
J-H3-50-101-0		
MILLIMETERS		
ALL DIMENSIONS WITHOUT TOLERANCES ARE FOR REFERENCE ONLY.		
A3 PAPER SIZE		
THIRD ANGLE PROJECTION		
SHEET 2 OF 2		

PROPRIETARY ITEM - EXCEPT FOR USES EXPRESSLY GRANTED IN WRITING INFORMATION DISCLOSED HEREON IS CONFIDENTIAL AND ALL RIGHTS PATENT AND OTHERWISE ARE RESERVED BY SOUTHCO, INC.

PROPER CAM & GEARBOX INSTALLATION FOR ROTATING HANDLE CCW TO OPEN

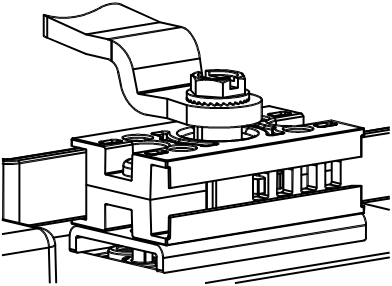

PANEL PREPARATION

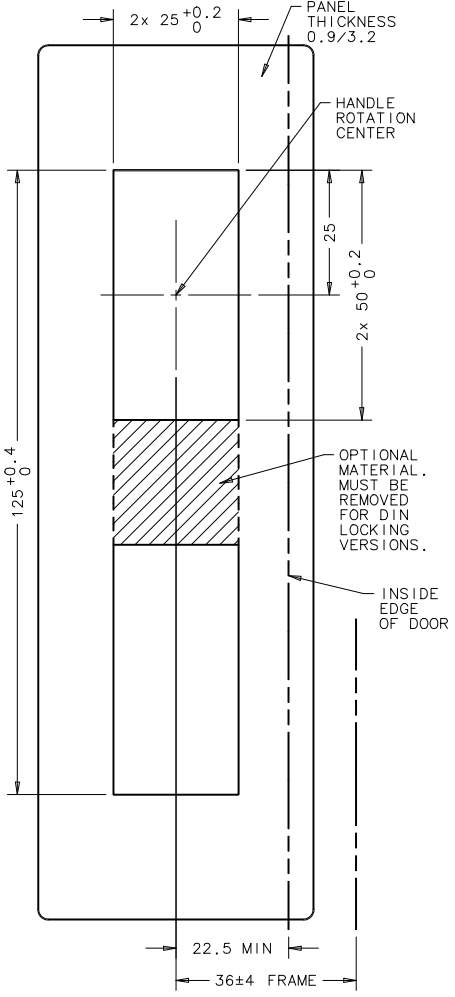

NOTES:

- ALL LATCH COMPONENTS ARE RoHS COMPLIANT.
- LATCH INSTALLATION:
 - PREPARE A BURR FREE PANEL OPENING AS SHOWN.
 - INSTALL LATCH SUB-ASSEMBLY FROM THE FRONT SIDE OF THE PANEL AND HOLD IN PLACE.
 - FROM THE BACK SIDE OF THE PANEL, SLIDE THE PIVOT END MOUNTING BRACKET ONTO THE HANDLE SHAFT.
 - SECURE THE PIVOT END MOUNTING BRACKET IN PLACE WITH TWO OF THE M4x0.7x12 SCREWS PROVIDED. ATTACH THE LOCK PLUG END MOUNTING BRACKET TO THE HOUSING AS SHOWN. MAX MOUNTING BRACKET SCREW TORQUE 1.5 N-m.
 - PLACE THE GEARBOX ASSEMBLY ONTO HANDLE SHAFT. PLEASE NOTE THAT THE GEARBOX ORIENTATION ALSO SETS THE LATCH OPENING DIRECTION. THE DIRECTION CAN BE EASILY CHANGED FROM CW TO OPEN TO CCW TO OPEN BY SIMPLY REMOVING THE GEARBOX AND REINSTALLING WITH THE LONG ARM ON THE OPPOSITE DIRECTION FROM WHAT IS SHOWN. SECURE THE GEARBOX IN PLACE WITH THE TWO M4x0.7x25 SCREWS PROVIDED. MAX SCREW TORQUE 1.5 N-m.
 - PLACE CAM ONTO HANDLE SHAFT. SECURE CAM TO SHAFT USING M6x1x12 SCREW. MAX SCREW TORQUE 2.0 N-m.
 - CYCLE THE LATCH FROM OPEN TO CLOSE TO MAKE SURE EVERYTHING MOVES FREELY.
 - FOR TWO POINT LATCHING (NO CENTER LATCHING), A 'DUMMY CAM' MUST BE USED TO MAINTAIN PROPER ASSEMBLY SPACING. IN SOUTHCO COSMETIC SPECIFICATIONS:
- COSMETIC SPECIFICATION:
 - S-121-01 FOR CHROME PLATING
 - S-121-02 FOR ZINC PLATING
 - S-121-03 FOR POWDER COATING
 - S-121-05 FOR STAINLESS STEEL PARTS

HARDWARE PACK

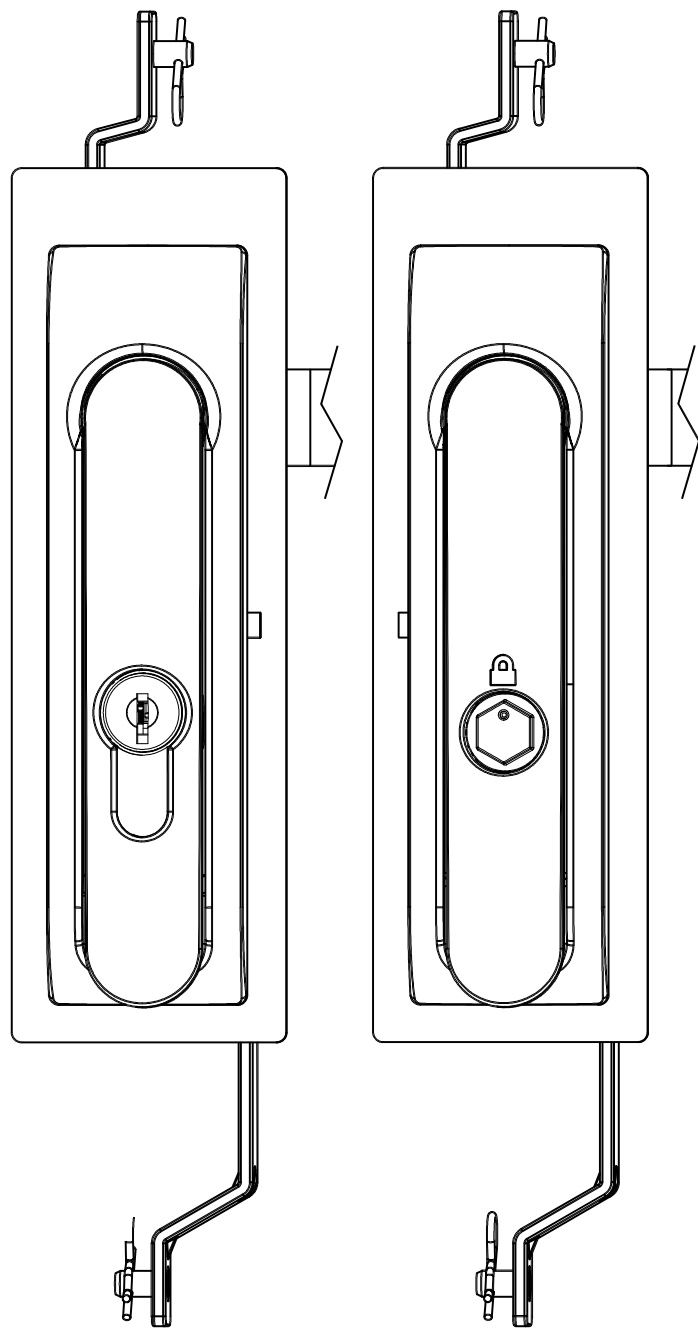
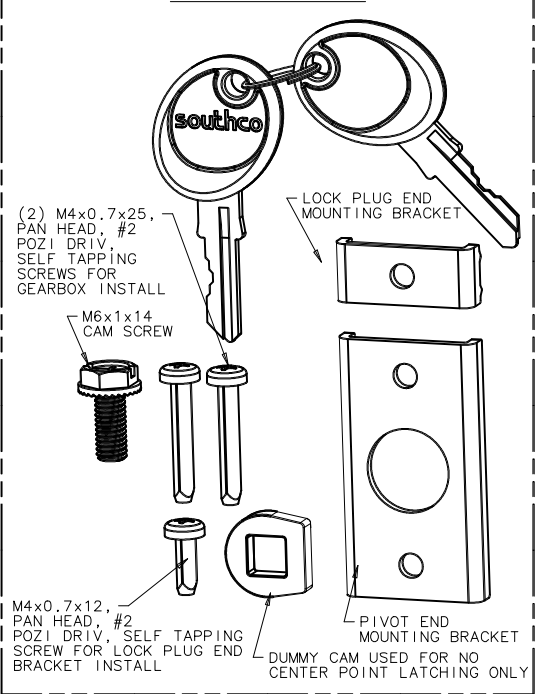

H3-50-123-0XX
333 DIN WITH
H3-51-40 GEARBOX

H3-50-142-0XX
BELLCORE/TELCORDIA 216
WITH H3-51-40 GEARBOX