

southco®

PROPRIETARY ITEM - EXCEPT FOR USES EXPRESSLY GRANTED IN WRITING INFORMATION DISCLOSED HEREON IS CONFIDENTIAL AND ALL RIGHTS PATENT AND OTHERWISE ARE RESERVED BY SOUTHCO, INC.

FLEXIBLE DRAW LATCH - CONCEALED MOUNTING (M5 THREAD)

DATE	DRAWN	CHKD	SCALE
9-24-90	pek		1:1

DRAWING NUMBER

J-F7-52

REV	DATE	DRAWN/CHKD	DESCRIPTION	PART NUMBER					
A	12JAN93	KPL	PRN: S-1-03	F7-52					
B	10SEP97	BRK	PRN: F7-41A						
C	19OCT2002	AJH/DLH	PRN: P2002-0790						
D	20APR2012	CMS/JCK	PRN: P2012-0532						

MILLIMETERS

ALL DIMENSIONS WITHOUT TOLERANCES ARE FOR REFERENCE ONLY.

THIRD ANGLE PROJECTION

A4 PAPER SIZE

- NOTES:
- LATCH ASSEMBLY CONSISTS OF:
SUB-ASSEMBLY:
HANDLE - TPE, BLACK
BRACKET - GLASS REINFORCED NYLON, BLACK.
KEEPER - GLASS REINFORCED NYLON, BLACK
 - LATCH SUB-ASSEMBLY AND KEEPER SHIPPED SEPARATELY, BULK. FOR LATCHES PACKAGED ONE PER BAG, ADD -P TO PART NUMBER.
 - MOUNT USING (3) M5 THREAD SCREWS (NOT SUPPLIED). SCREW LENGTH = PANEL THICKNESS PLUS 12.7.

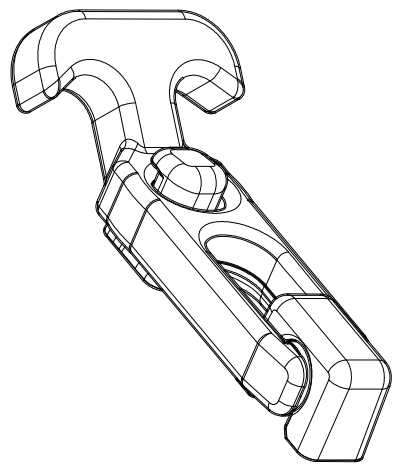
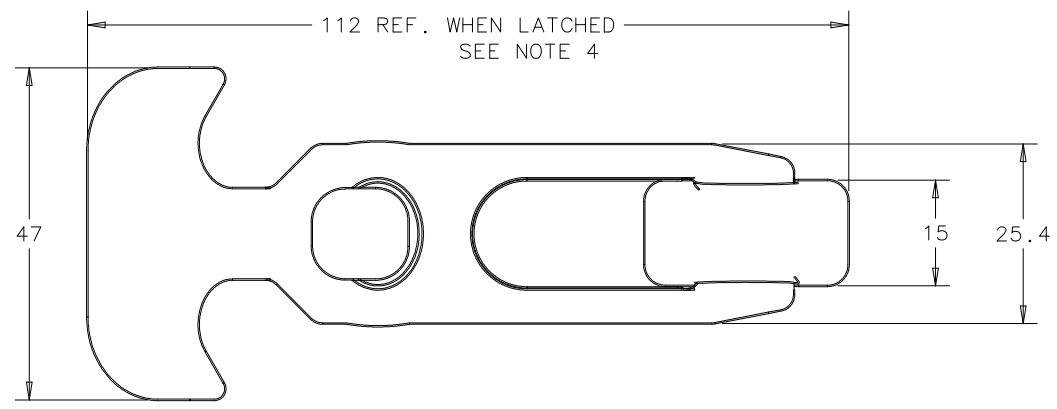

SCALE .75:1

