

6

5

4

3

2

1

PART NUMBER: E5-4-WW3-YY1

ACTUATION STYLE
(SEE BELOW)

SEE NOTE 3

CAM TYPE
(SEE GRIP TABLE)

WW

ACTUATION STYLES:

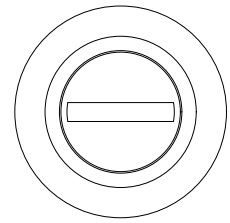

SLOTTED
WW=00

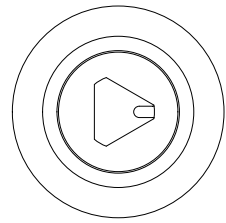

TRIANGULAR 8mm
WW=03

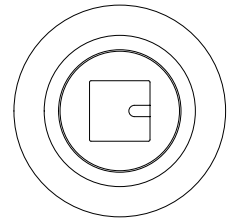

SQUARE 8mm
WW=05

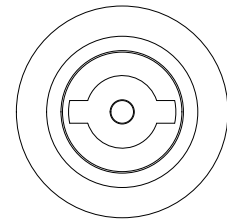

DOUBLE BIT 3mm
WW=06

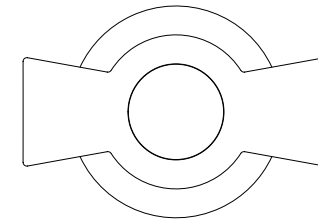

WING KNOB
WW=30

REVISION HISTORY			
REV	DATE	BY	DESCRIPTION
D	27JUL2016	DMS/YGC	PRN: P2016-1751

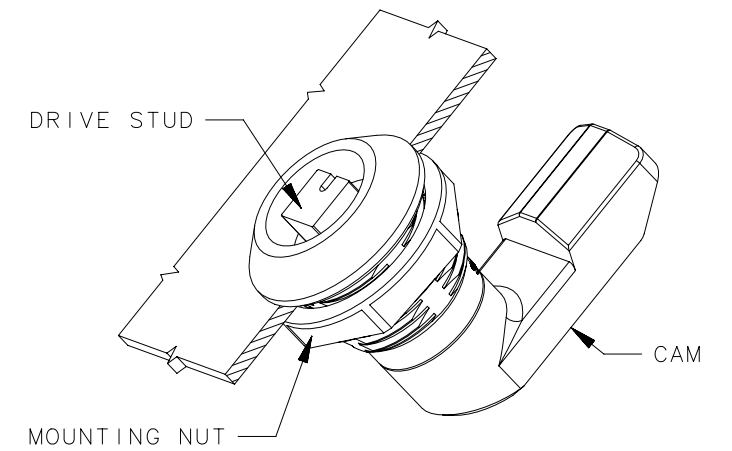

TOTAL GRIP	YY	L	MAXIMUM DOOR THICKNESS FOR ASSEMBLED LATCH					
			1mm	2mm	3mm	4mm	5mm	6mm
			16	16	28.6	✓	✓	✓
18	18	28.6	✓	✓	✓	✓	✓	✓
20	20	28.6	✓	✓	✓	✓	✓	✓
22	22	32.6	✓	✓	✓	✓	✓	✓
24	24	34.6	✓	✓	✓	✓	✓	✓
25	25	35.6	✓	✓	✓	✓	✓	✓
26	26	36.6	✓	✓	✓	✓	✓	✓
28	28	38.6	✓	✓	✓	✓	✓	✓
30	30	40.6	✓	✓	✓	✓	✓	✓
32	32	42.6	✓	✓	✓	✓	✓	✓
34	34	44.6	✓	✓	✓	✓	✓	✓
36	36	46.6	✓	✓	✓	✓	✓	✓

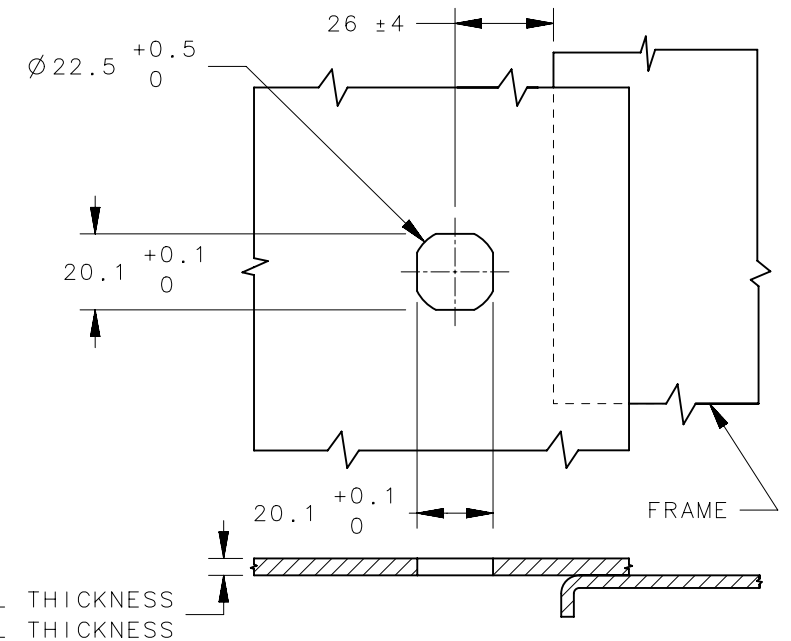
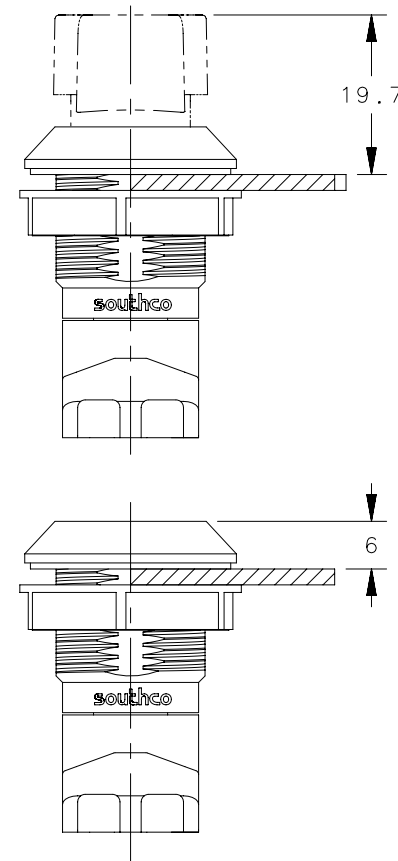
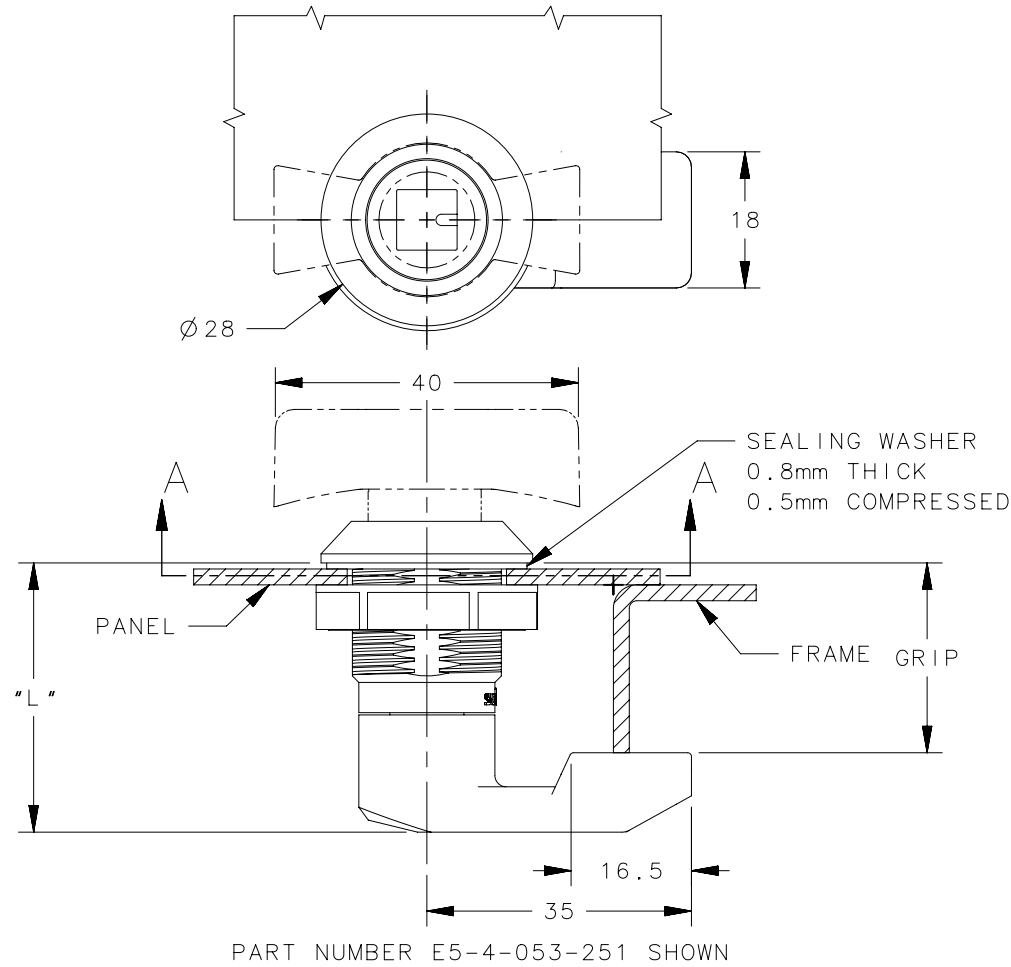

6mm MAX PANEL THICKNESS
1mm MIN PANEL THICKNESS

NOTES:

- SEE SHEET 2 FOR INSTALLATION INSTRUCTIONS.
- COSMETIC SPECIFICATION: ALL SURFACES ABOVE A-A CONFORM TO CLASS "C" DESIGNATION AS DESCRIBED IN SOUTHCO COSMETIC SPECIFICATIONS: S-121-04
- MATERIAL AND FINISH:
 - HOUSING, DRIVE STUD, CAM AND MOUNTING NUT: GLASS FILLED NYLON BLACK.
 - CAM MOUNTING SCREW: STAINLESS STEEL, PASSIVATE.
 - SEALING WASHER: NITRILE RUBBER.

THIRD ANGLE PROJECTION	
MILLIMETERS [IN]	
TOLERANCES UNLESS OTHERWISE NOTED	
ALL DIMENSIONS WITHOUT TOLERANCES ARE FOR REFERENCE ONLY.	
PER ASME Y14.5M-1994	

 CONNECT • CREATE • INNOVATE			
DESCRIPTION: E5 QUAD LATCH PLASTIC			
SIZE: A3	SYSTEM: NX	DWG NO.: J-E5-4	
DRAWN BY: GKW/YGC	DATE: 20FEB2015	SCALE: 1:1	SHEET: 1 OF 2

6

5

4

3

2

1

6

5

4

3

2

1

INSTALLATION METHOD 1

USE WHEN PANEL THICKNESS IS EQUAL TO OR LESS THAN MAXIMUM THICKNESS SHOWN IN GRIP TABLE.

1. PLACE SEALING WASHER ONTO LATCH HOUSING.
2. TILT LATCH THROUGH MOUNTING HOLE.
3. INSTALL MOUNTING NUT AND TIGHTEN TO:
4.25 N.m MAX.

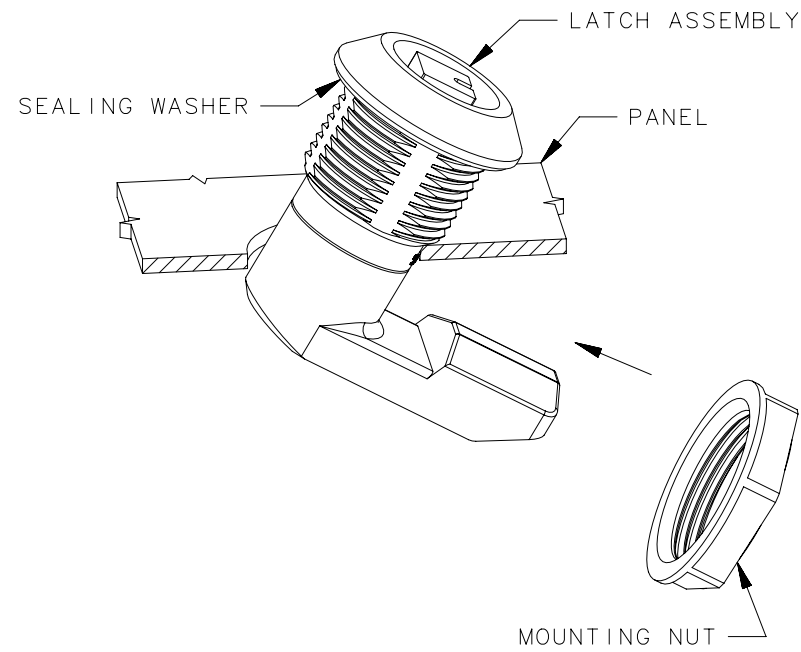

INSTALLATION METHOD 2

REQUIRED WHEN PANEL THICKNESS EXCEEDS MAXIMUM THICKNESS SHOWN IN GRIP TABLE.

1. REMOVE SCREW FROM HOUSING, DETACHING CAM FROM LATCH ASSEMBLY.
2. PLACE SEALING WASHER ONTO LATCH HOUSING AND PLACE THROUGH MOUNTING HOLE.
3. INSTALL MOUNTING NUT AND TIGHTEN TO:
4.25 N.m MAX.
4. RE-ATTACH CAM TO LATCH ASSEMBLY. ENSURE CAM TIP POINTING TO PROPER ORIENTATION.
5. INSTALL SCREW AND TIGHTEN TO : 2 N.m.

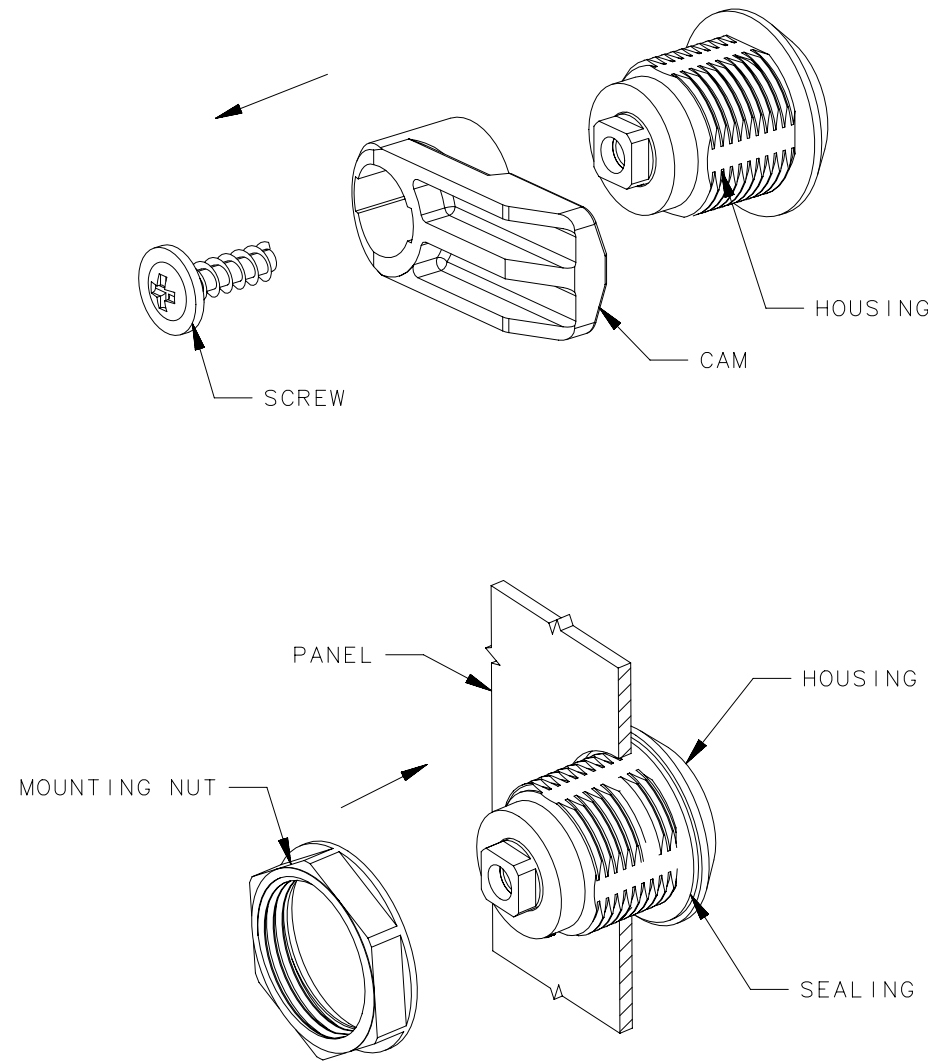

REVISION HISTORY			
REV	DATE	BY	DESCRIPTION
D	27JUL2016	DMS/YGC	PRN: P2016-1751

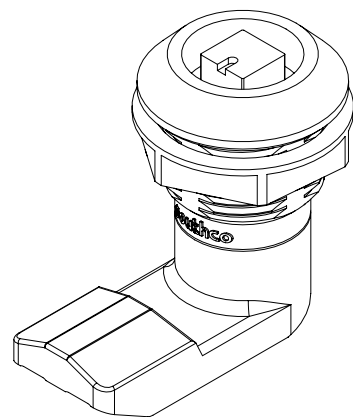
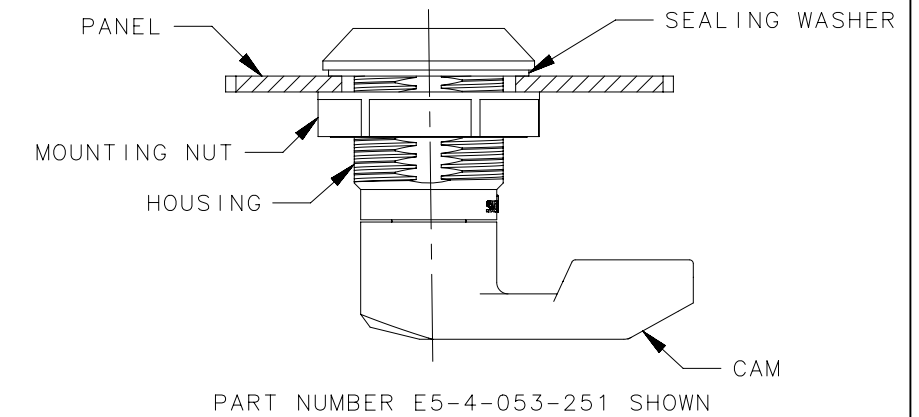
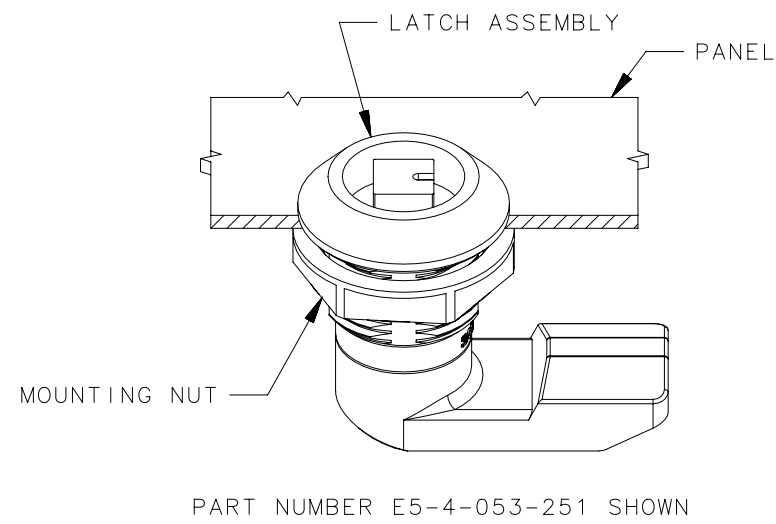
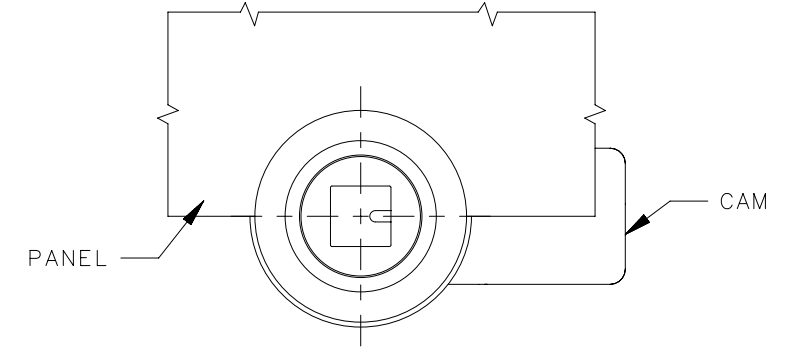

	THIRD ANGLE PROJECTION			southco [®] CONNECT • CREATE • INNOVATE	
	MILLIMETERS [IN]				
SURFACE AREA	TOLERANCES UNLESS OTHERWISE NOTED		DESCRIPTION E5 QUAD LATCH PLASTIC		
VOLUME	ALL DIMENSIONS WITHOUT TOLERANCES ARE FOR REFERENCE ONLY.		SIZE A3	SYSTEM NX	DWG NO. J-E5-4
PROPRIETARY ITEM	PER ASME Y14.5M-1994		DRAWN BY GKW/YGC	DATE 20FEB2015	SCALE 1:1
EXCEPT FOR USES EXPRESSLY GRANTED IN WRITING, INFORMATION DISCLOSED HEREON IS CONFIDENTIAL AND ALL RIGHTS, PATENT AND OTHERWISE, ARE RESERVED BY SOUTHCO, INC.					SHEET 2 OF 2

6

5

4

3

2

1