

**southco**

PROPRIETARY ITEM - EXCEPT FOR USES EXPRESSLY GRANTED IN WRITING INFORMATION DISCLOSED HEREON IS CONFIDENTIAL AND ALL RIGHTS PATENT AND OTHERWISE ARE RESERVED BY SOUTHCO, INC.

ALIGNMENT RECEPTACLE MODULE - (rK1)  
ATCA - REAR TRANSITION MODULE

DATE	DRAWN	CHKD	SCALE	DRAWING NUMBER
10MAY2006	DLH		3:1	J-CN-79

REV	DATE	DRAWN/CHKD	DESCRIPTION	PART NUMBER	MATERIAL	FINISH
B	16JAN2007	DLH/MJS	PRN: P2007-0094	CN-79	SEE NOTE A	SEE NOTE A
C	23JUN2009	MJS/MJS	PRN: P2009-0696			
D	08SEP2014	CMS/NJF	PRN: P2014-1777			

**MILLIMETERS**

ALL DIMENSIONS WITHOUT TOLERANCES ARE FOR REFERENCE ONLY.

THIRD ANGLE PROJECTION  
A3 PAPER SIZE

NOTES:

- A. MATERIAL AND FINISH:  
DIE CAST ZINC, NICKEL PLATE PER SAE-AMS QQ-N-290 CLASS 1 GRADE G.
- B. RECEPTACLE MODULE CONFORMS TO: AdvancedTCA<sup>®</sup> PICMG<sup>®</sup> 3.0 Revision 2.0  
AdvancedTCA<sup>®</sup> Base Specification (March 18, 2005)
- C. COSMETIC SPECIFICATION:  
ALL SURFACES UNLESS OTHERWISE NOTED ARE TO CONFORM TO A CLASS \*C\* DESIGNATION AS DESCRIBED IN SOUTHCO COSMETIC SPECIFICATION: S-121-02 FOR ZINC PLATING
- D. RoHS COMPLIANT.
- E. PACKAGED IN TRAYS OF 70.
- F. PICMG AND THE PICMG LOGO ARE REGISTERED TRADEMARKS OF THE PCI INDUSTRIAL COMPUTERS MANUFACTURERS GROUP.
- G. AdvancedTCA, ATCA AND THE AdvancedTCA AND ATCA LOGOS ARE TRADEMARKS OF THE PCI INDUSTRIAL COMPUTERS MANUFACTURERS GROUP.
- H. CN-79 MATES WITH SOUTHCO PART NUMBERS: CN-81-4, CN-81-6, & CN-81-8.

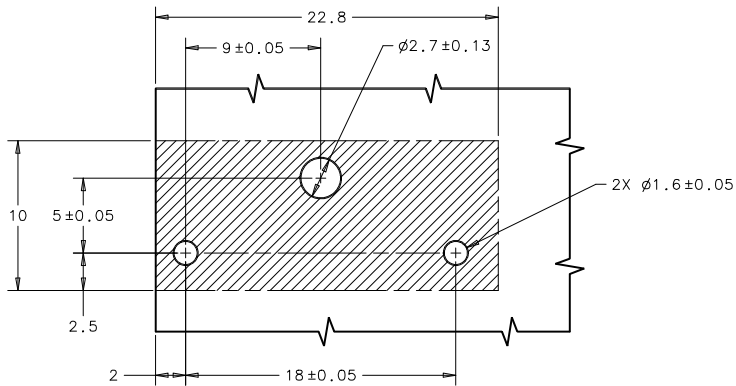
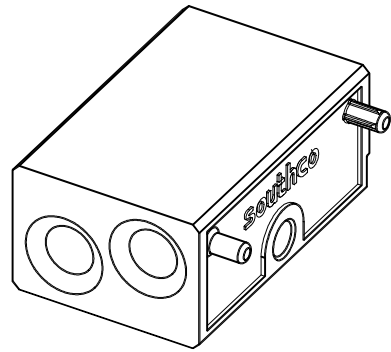

PCB PREPARATION

