



PROPRIETARY ITEM - EXCEPT FOR USES EXPRESSLY GRANTED IN WRITING INFORMATION DISCLOSED HEREON IS CONFIDENTIAL AND ALL RIGHTS PATENT AND OTHERWISE ARE RESERVED BY SOUTHCO, INC.

T-HANDLE ACTUATOR ASSEMBLY

DATE: 27MAY2008
 DRAWN: ACH
 CHKD: LBT
 SCALE: 1:1

DRAWING NUMBER: J-AC-60-101

REV	DATE	DRAWN/CHKD	DESCRIPTION	ITEM	PART NUMBER	MATERIAL	FINISH
A	20AUG2008	ACH/MJS	INITIAL DRAWING RELEASE	ASSEMBLY	AC-60-101-11	-	-
B	16MAR2009	LBT/ACH	PRN: P2009-0264	HOUSING		PC/ABS	BLACK
C	16NOV2010	MJS	PRN: P2010-1120	T-HANDLE		13% GLASS FILLED NYLON	BLACK
				CABLE SLIDE		13% GLASS FILLED NYLON	BLACK
				CABLE CLIP		ACETAL	BLACK
				SPRING		302 STAINLESS STEEL	NATURAL

MILLIMETERS
 ALL DIMENSIONS WITHOUT TOLERANCES ARE FOR REFERENCE ONLY.
 THIRD ANGLE PROJECTION
 A3 PAPER SIZE

INSTALLATION NOTES:

1. PREPARE PANEL AS SHOWN
2. USE M4 OR #8 SCREWS (FASTENERS NOT PROVIDED) TO MOUNT ACTUATOR TO PANEL
3. INSERT BARREL FITTING IN CABLE SLIDE, THEN SNAP THE CABLE SLEEVE INTO ACTUATOR CABLE CLIP TO SECURE THE CABLE

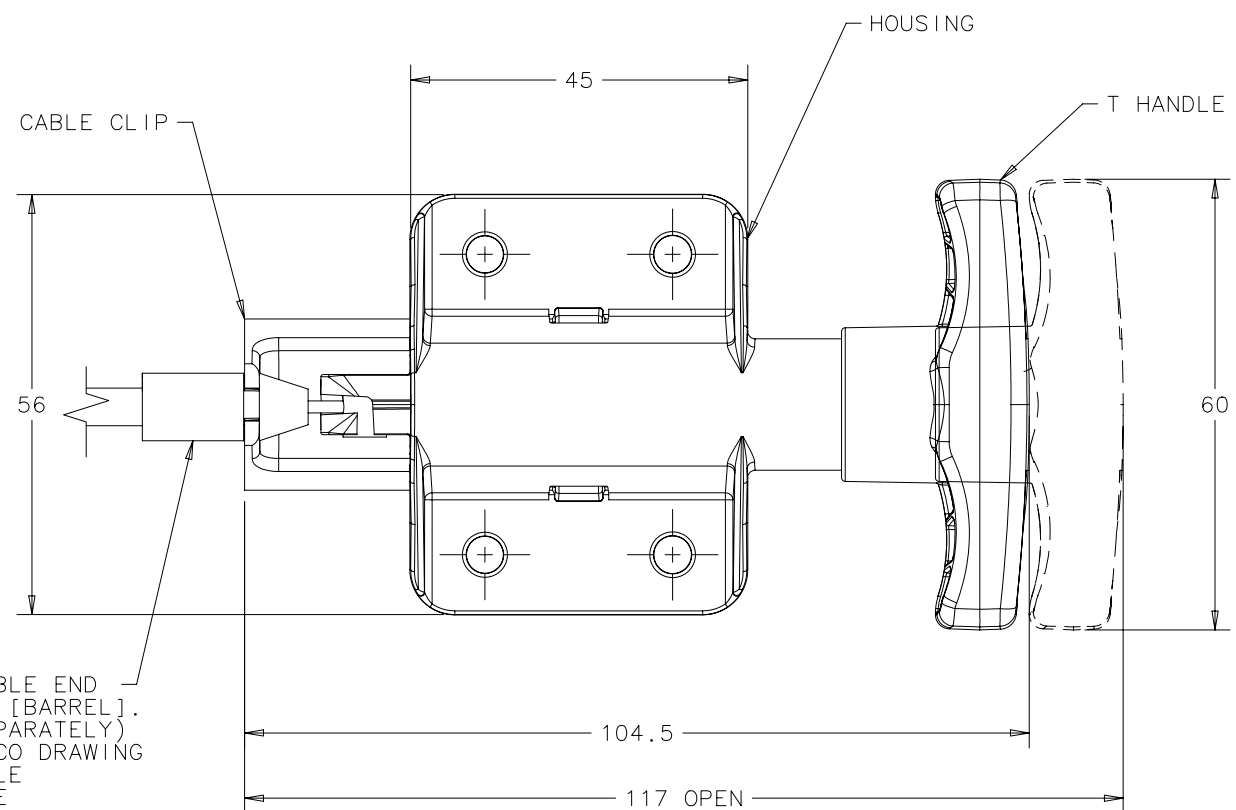
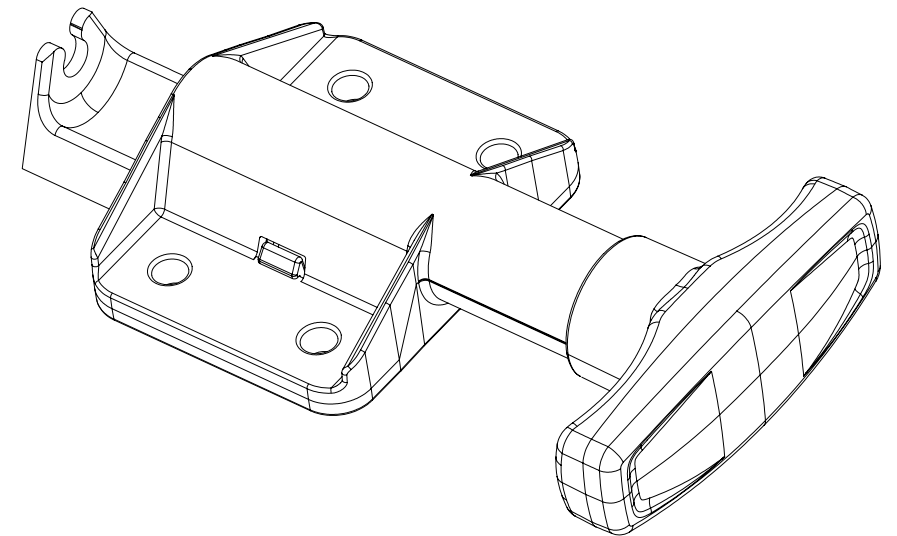
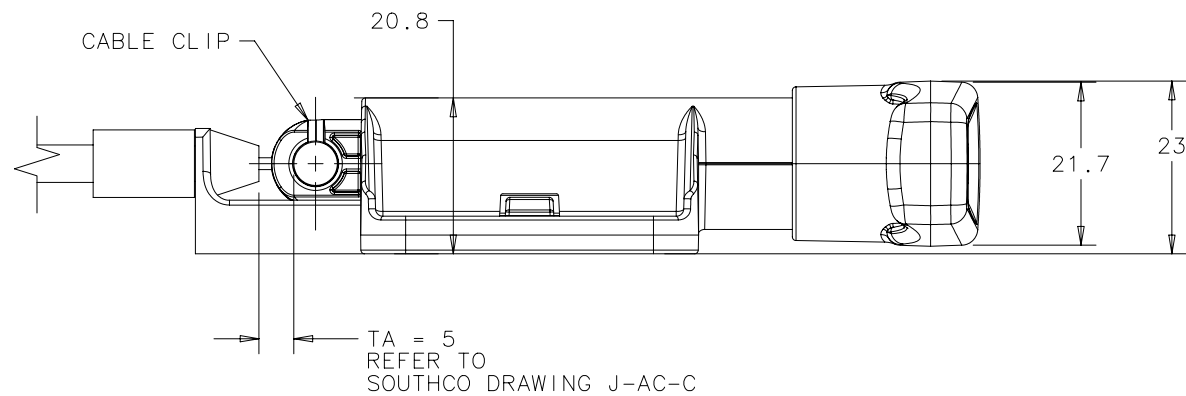

USE SOUTHCO CABLE END FITTING TYPE A [BARREL]. (CABLE SOLD SEPARATELY). REFER TO SOUTHCO DRAWING J-AC-C FOR CABLE SELECTION GUIDE

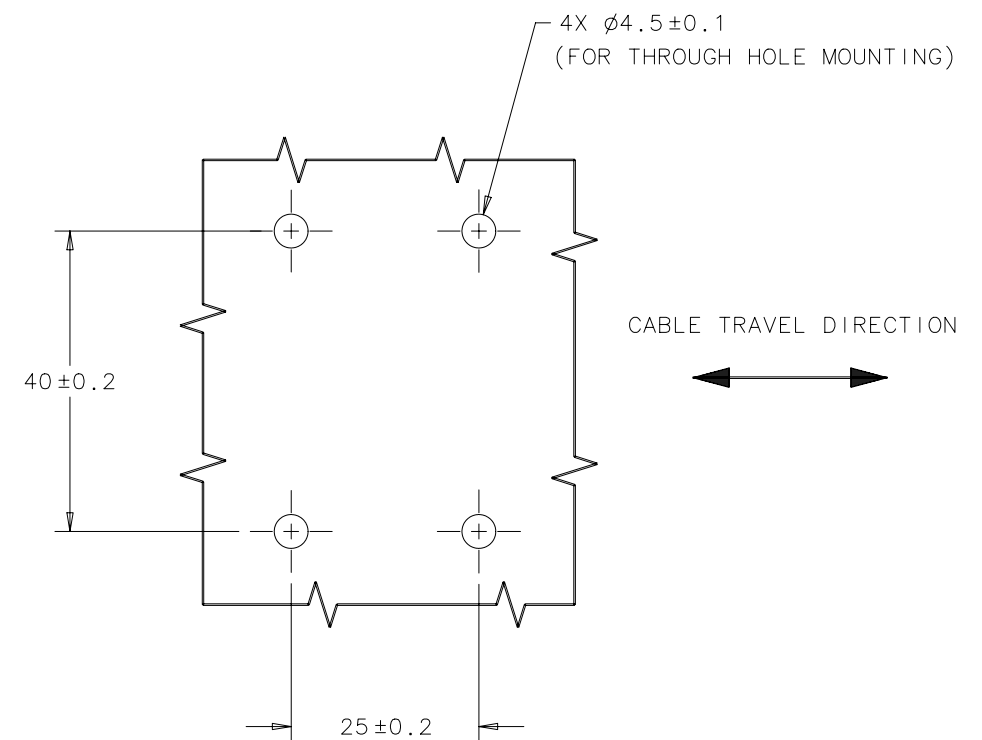

PANEL PREPARATION