



SOUTHCO No.58 SCREW FASTENER
No.10-24 & No.10-32 THREAD - 7/16 DIA. HEAD

DATE	DRAWN	CHKD	SCALE	DRAWING NUMBER
23APR57	A S K		2 : 1	J-58-12

REV.	DATE	BY-CHKD	REVISIONS	PART NUMBERS		"A"	"B"
H	20 JAN 98	JGK	PRN: 58-115	No.10-24 THD.	No.10-32 THD.		
				58-23-309-XX	58-26-309-XX	.56	1.19
				58-23-310-XX	58-26-310-XX	.63	1.25
				58-23-311-XX	58-26-311-XX	.69	1.31
				58-23-312-XX	58-26-312-XX	.75	1.38
				58-23-313-XX	58-26-313-XX	.81	1.44
				58-23-314-XX	58-26-314-XX	.88	1.50
				58-23-315-XX	58-26-315-XX	.94	1.56
				58-23-316-XX	58-26-316-XX	1.00	1.63
				58-23-317-XX	58-26-317-XX	1.06	1.69

FOR THROAT LENGTHS LARGER THAN 1.06 SEE DWG. J-58-44

NOTES

A. FOR AN UNSLOTTED SCREW CHANGE THE THIRD DIGIT OF THE PART No. FROM 2 TO 1. (eg. 58-11-309-XX)

MATERIAL AND FINISH (LAST TWO DIGITS OF PART No.)

-24: 302 STAINLESS STEEL, PASSIVATED.

-26: 302 STAINLESS STEEL, PASSIVATED PLUS BLACK ORGANIC COATING.

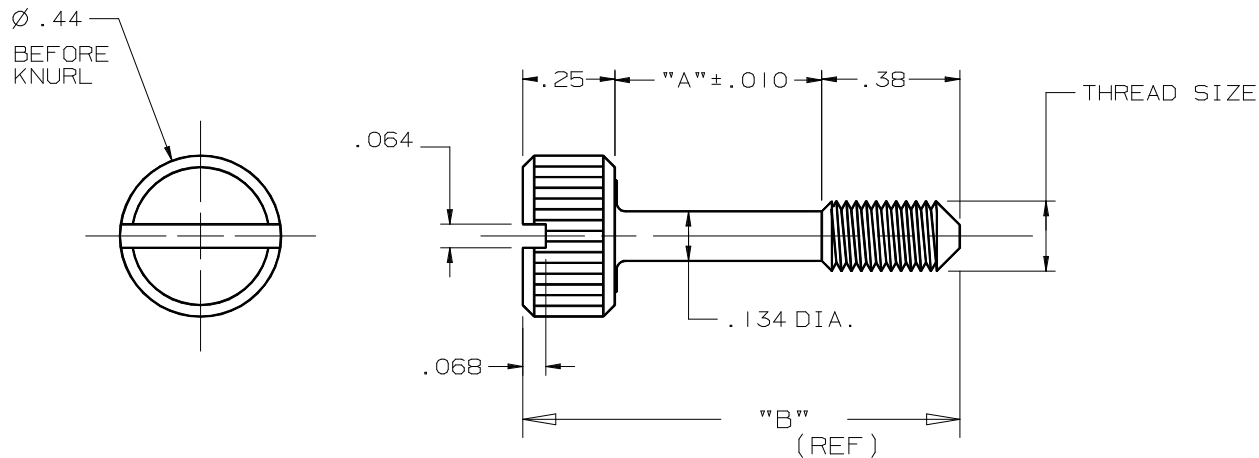

FORMAT A 3/88

PROPRIETARY ITEM - EXCEPT FOR USES EXPRESSLY GRANTED IN WRITING INFORMATION DISCLOSED HEREON IS CONFIDENTIAL AND ALL RIGHTS PATENT AND OTHERWISE ARE RESERVED BY SOUTHCO, INC.

ALL DIMENSIONS WITHOUT TOLERANCES ARE REFERENCE. ALL DIMENSIONS ARE IN INCHES. THIRD ANGLE PROJECTION.

DRAWING NUMBER

J-58-12