

NOTES:

A. INSTALLATION INSTRUCTIONS:

1. DRILL OR PUNCH INSTALLATION HOLE.
2. PLACE FERRULE INTO INSTALLATION HOLE.
3. PROVIDE SOLID BACK-UP BEHIND HOLE WITH CLEARANCE HOLE FOR STUD.
4. PRESS ON HEAD OF STUD UNTIL SHOULDER OF FERRULE IS FIRMLY AGAINST OUTER PANEL. RECOMMENDED LOAD OF 5,000 N FOR 5052-H32 ALUMINUM. RECOMMENDED LOAD OF 8,000 N FOR STEEL, $R_b \leq 60$ MAX.
5. PUNCH CANNOT TOUCH PLASTIC DURING INSTALLATION.

B. MATERIAL AND FINISH:

FERRULE AND ENDCAP: STEEL, ZINC PLATE PLUS SEALER
 SPRING: STAINLESS STEEL, PASSIVATED (NOT SHOWN)
 STUD: HARDENED STEEL, ZINC PLATE PLUS SEALER
 KNOB: PC/ABS UL94 V0 RATED, FLAME RETARDANT; TRIARYLPHOSPHATE (DOES NOT CONTAIN BROMINATED, CHLORINATED, OR HALOGENATED ADDITIVES).

C. GATE NOT ORIENTED WITH FRAME BREAK.

D. COSMETIC SPECIFICATION: ALL SURFACES (UNLESS OTHERWISE SPECIFIED) ARE TO BE PER SOUTHCO SPECIFICATION S-121-02 AND S-121-04, CLASS B (REFER TO SECTION 1.0 FOR CROSS REFERENCE TABLE)

E. PARTS SHIPPED BULK

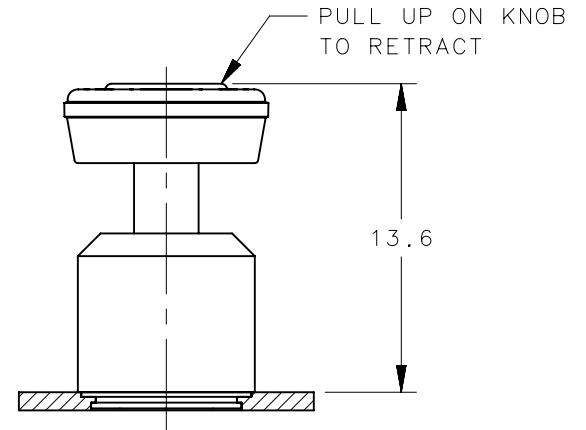
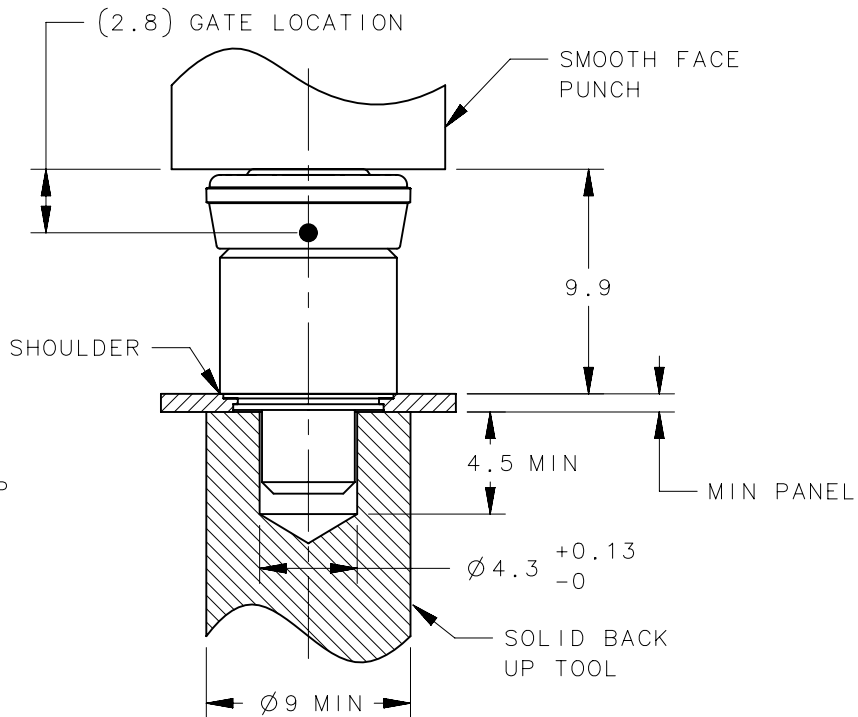

"EEE" KNOB COLOR
 -000 BLACK
 SEE J-47-0-3 FOR DETAILS

56-110-EEE
PART NUMBER

REVISION HISTORY			
REV	DATE	BY	DESCRIPTION
B	09JUL2014	TVA/MJS	PRN: P2014-1050



SCALE 1:1

THIRD ANGLE PROJECTION	
MILLIMETERS [IN]	
TOLERANCES UNLESS OTHERWISE NOTED	
ALL DIMENSIONS WITHOUT TOLERANCES ARE FOR REFERENCE ONLY.	
PROPRIETARY ITEM	
EXCEPT FOR USES EXPRESSLY GRANTED IN WRITING, INFORMATION DISCLOSED HEREON IS CONFIDENTIAL AND ALL RIGHTS, PATENT AND OTHERWISE, ARE RESERVED BY SOUTHCO, INC.	
PER ASME Y14.5M-1994	

southco [®]			
CONNECT • CREATE • INNOVATE			
DESCRIPTION			
Quick Access Fastener			
56 MINI PRESS-IN ASSEMBLY OVERMOLD NON STAY OPEN			
SIZE	SYSTEM	DWG NO.	
A4	NX	J-56-110	
DRAWN BY	DATE	SCALE	SHEET
TVA	07OCT2013	3:1	1 OF 1