

REVISION HISTORY			
REV	DATE	BY	DESCRIPTION
C	22JUN2012	BGL/TVA	PRN: P2012-0860

PART NUMBER 52-29-21-4-EEE SHOWN

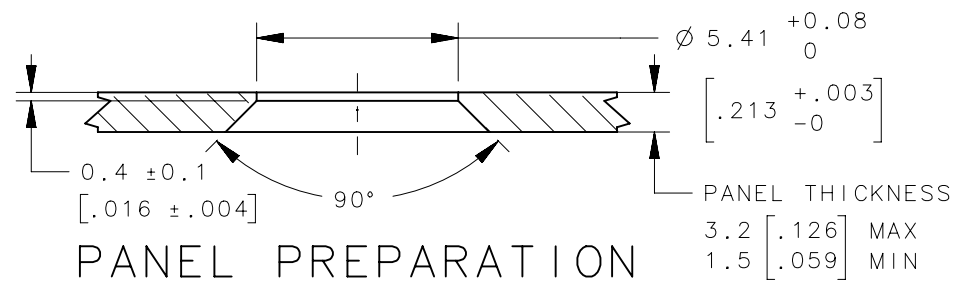
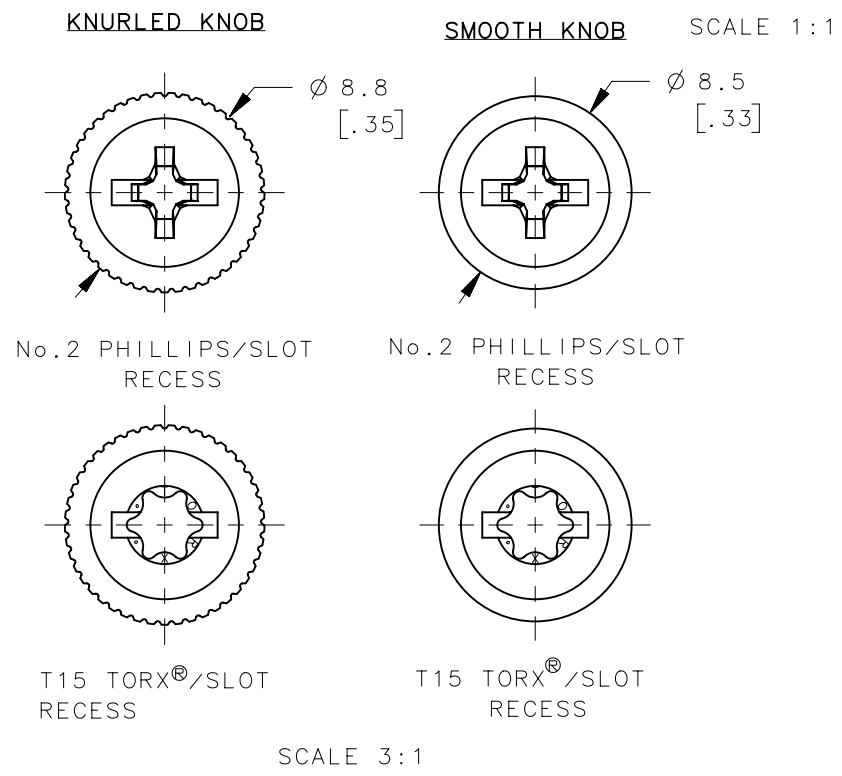
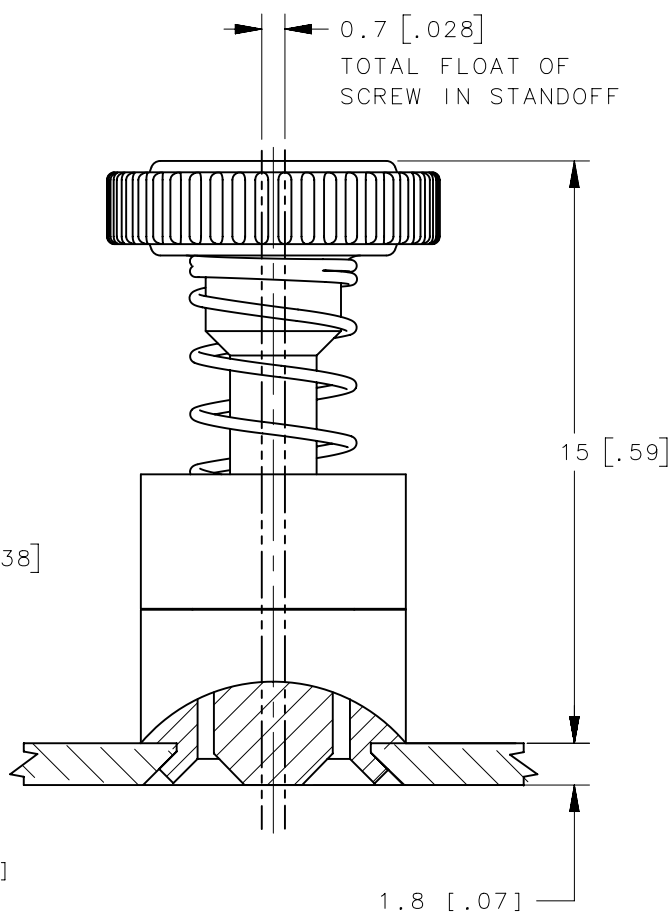
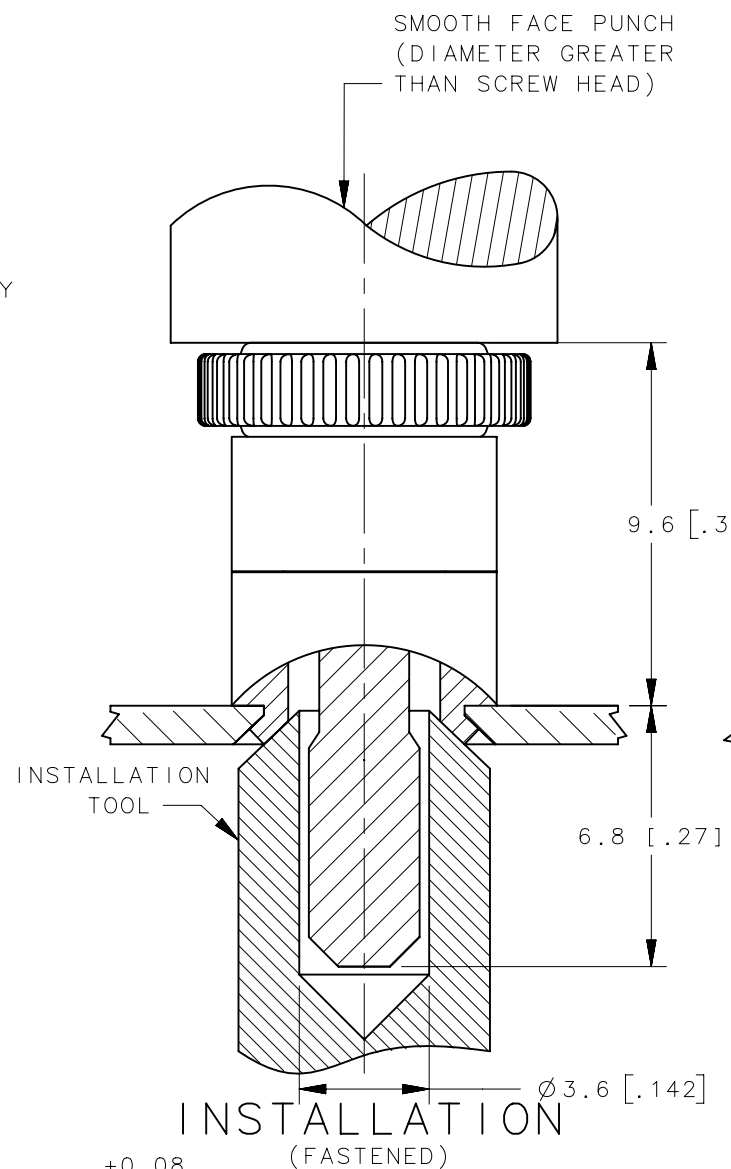
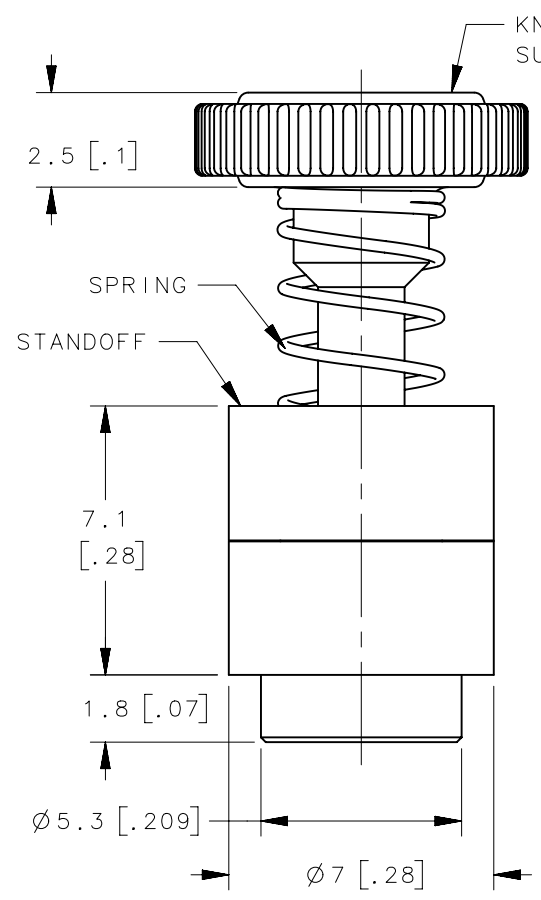
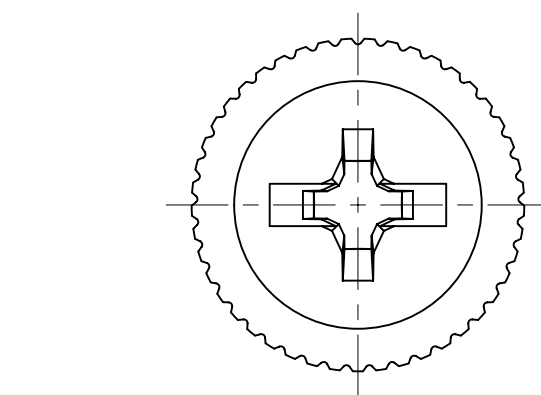
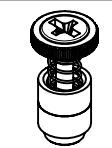

UNFASTENED

INSTALLATION (FASTENED)

**\*B\* SCREW RECESS AND KNOB STYLE**

- 7 - T15 TORX®/SLOT RECESS, KNURLED KNOB
- 8 - T15 TORX®/SLOT RECESS, SMOOTH KNOB
- 9 - No.2. PHILLIPS/SLOT RECESS, KNURLED KNOB
- A - No.2. PHILLIPS/SLOT RECESS, SMOOTH KNOB

**\*EEE\* KNOB COLOR**  
SEE J-47-0-3 FOR DETAIL

- NOTES:
- MATERIAL AND FINISH: RoHS COMPLIANT  
KNOB: PC/ABS UL94 V0 RATED, FLAME RETARDANT; TRIARYLPHOSPHATE (DOES NOT CONTAIN BROMINATED, CHLORINATED, OR HALOGENATED ADDITIVES). "EEE" IN PART NUMBER DENOTES KNOB COLOR.  
SCREW: STEEL, HARDENED, ZINC PLATE PLUS SEALER  
SPRING: 300 SERIES STAINLESS STEEL, PASSIVATED  
STANDOFF: 6000 SERIES ALUMINUM, NATURAL
  - INSTALLATION INSTRUCTIONS:
    - PREPARE THE HOLE IN THE PANEL, COUNTERSINK UNDERSIDE OF THE PANEL AS SHOWN.
    - USE SOUTHCO INSTALLATION TOOL, PART NUMBER IS 47-106, TO FLARE THIS ASSEMBLY.
    - SMOOTH FACE PUNCH SURFACE AND INSTALLATION TOOL MUST REMAIN PARALLEL DURING FLARING OF STANDOFF. ONLY USE LIGHT PRESSURE TO FLARE STANDOFF. RECOMMENDED LOAD OF 3,000N.
  - RECOMMENDED MAXIMUM TORQUE OF 110 N-cm.
  - COSMETIC SPECIFICATION: ALL SURFACES (UNLESS OTHERWISE SPECIFIED) ARE TO BE PER SOUTHCO SPECIFICATION S-121-02 AND S-121-04, CLASS B (REFER TO SECTION 1.0 FOR CROSS REFERENCE TABLE).

52-2B-21-4-EEE		SEE NOTE A	SEE NOTE A
PART NUMBER		MATERIAL	FINISH
THIRD ANGLE PROJECTION			
MILLIMETERS [IN]			
TOLERANCES UNLESS OTHERWISE NOTED		DESCRIPTION	
ALL DIMENSIONS WITHOUT TOLERANCES ARE FOR REFERENCE ONLY.		OVERMOLD 52 ASSEMBLY, 6-32 THREAD FLARE-IN STYLE	
PROPRIETARY ITEM	EXCEPT FOR USES EXPRESSLY GRANTED IN WRITING, INFORMATION DISCLOSED HEREON IS CONFIDENTIAL AND ALL RIGHTS, PATENT AND OTHERWISE, ARE RESERVED BY SOUTHCO, INC.	SIZE A3	SYSTEM NX
PER ASME Y14.5M-1994		DWG NO. J-52-1-632	SCALE 5:1
		DRAWN BY JQ/TVA	DATE 06MAR2011
		SHEET 1 OF 1	