

TORX is a registered trademark of ACUMENT® Intellectual Properties, LLC

REVISION HISTORY			
REV	DATE	BY	DESCRIPTION
A	08DEC2015	ER/LC	PRN: P2015-2473

- NOTES:
- A. GATE NOT ORIENTED WITH RECESS OR FRAME BREAK.
 - B. FLASH HEIGHT GREATER THAN 0.3 NOT ACCEPTABLE.
 - C. SURFACE IMPERFECTIONS: INSPECT PARTS FROM 0.6 METERS FOR 3 SECONDS, FOUR SURFACE IMPERFECTIONS MAX PER PART. SURFACE IMPERFECTIONS NO LARGER THAN 2.3mm DIAMETER, HEIGHT OR WIDTH.
 - D. KNOB AND SCREW ARE SPRING LOAD OUTWARD, AS SHOWN BELOW.

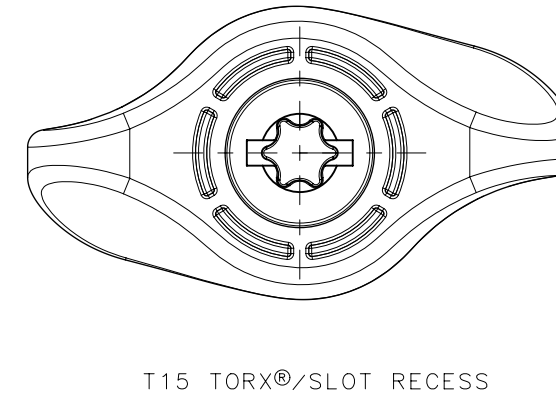
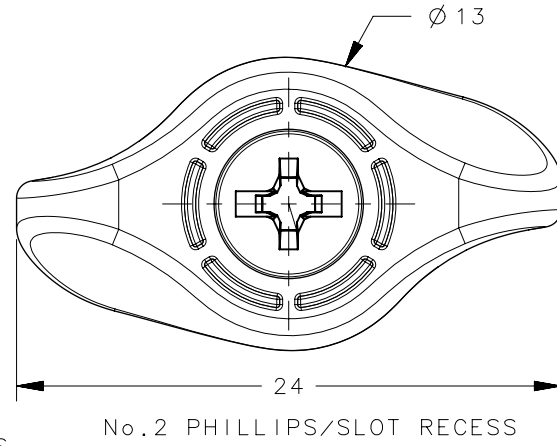

MATERIAL AND FINISH:
 KNOB: PC/ABS UL94 V0 RATED, FLAME RETARDANT TRIARYLPHOSPHATE (DOES NOT CONTAIN BROMINATED CHLORINATED, OR HALOGENATED ADDITIVES)
 SCREW: HEAT TREATED LOW CARBON STEEL ZINC PLATE, CHROMATE PLUS SEALER
 STANDOFF: ALUMINUM, NATURAL
 SPRING: 300 SERIES STAINLESS STEEL, PASSIVATED

- TO INSTALL FASTENER:**
1. DRILL THEN COUNTERSINK AS SHOWN BELOW.
 2. INSERT FASTENER AND FLARE INTO COUNTERSINK WITH INSTALLATION TOOL PART NUMBER 47-106.
 3. PUNCH CANNOT TOUCH PLASTIC DURING INSTALLATION.

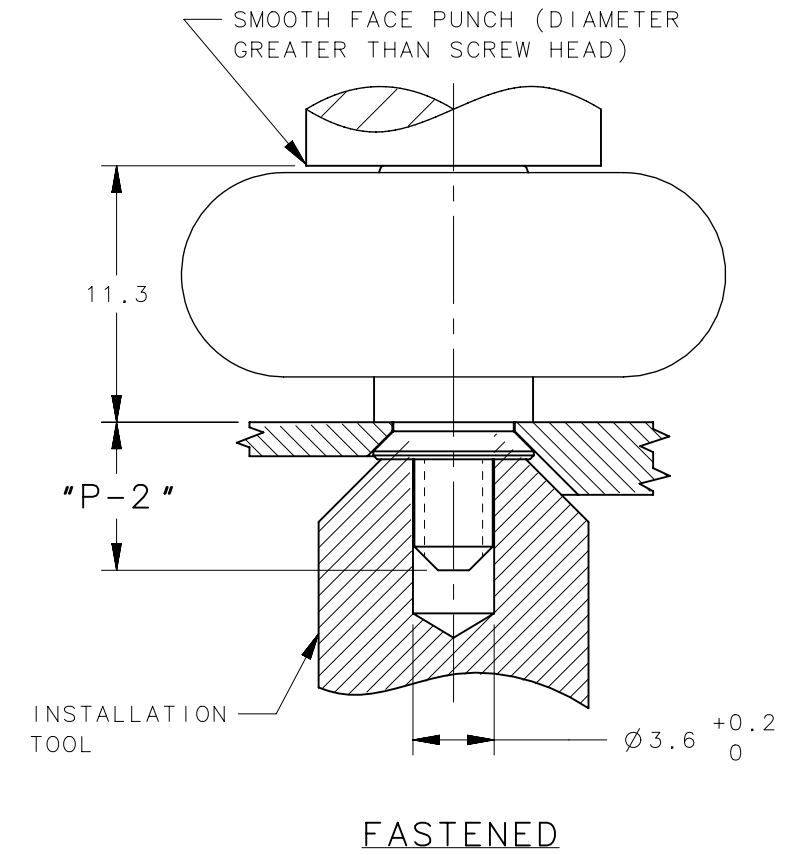
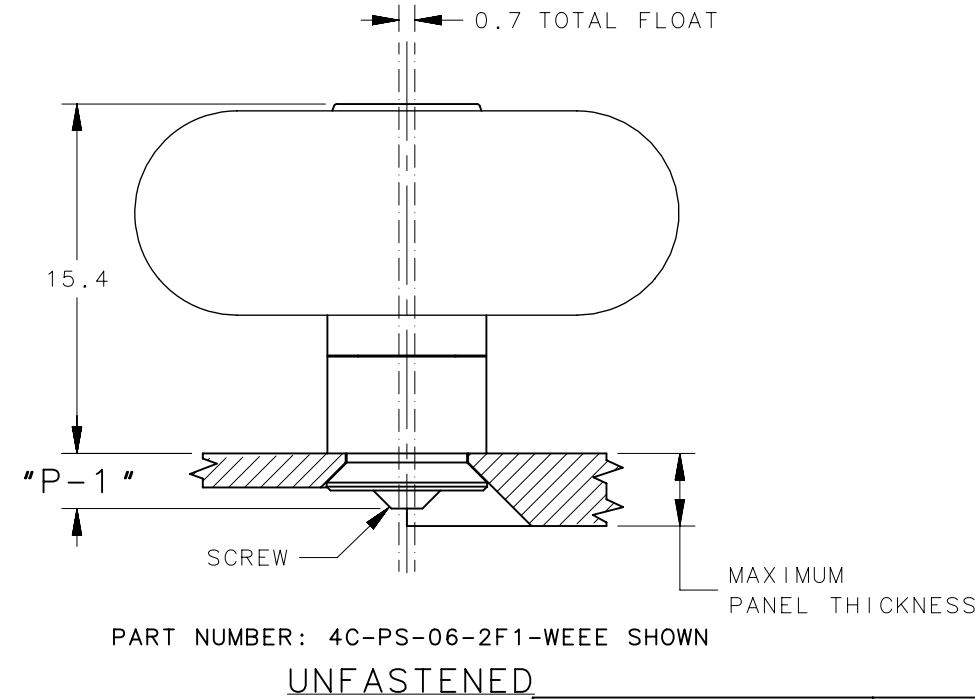
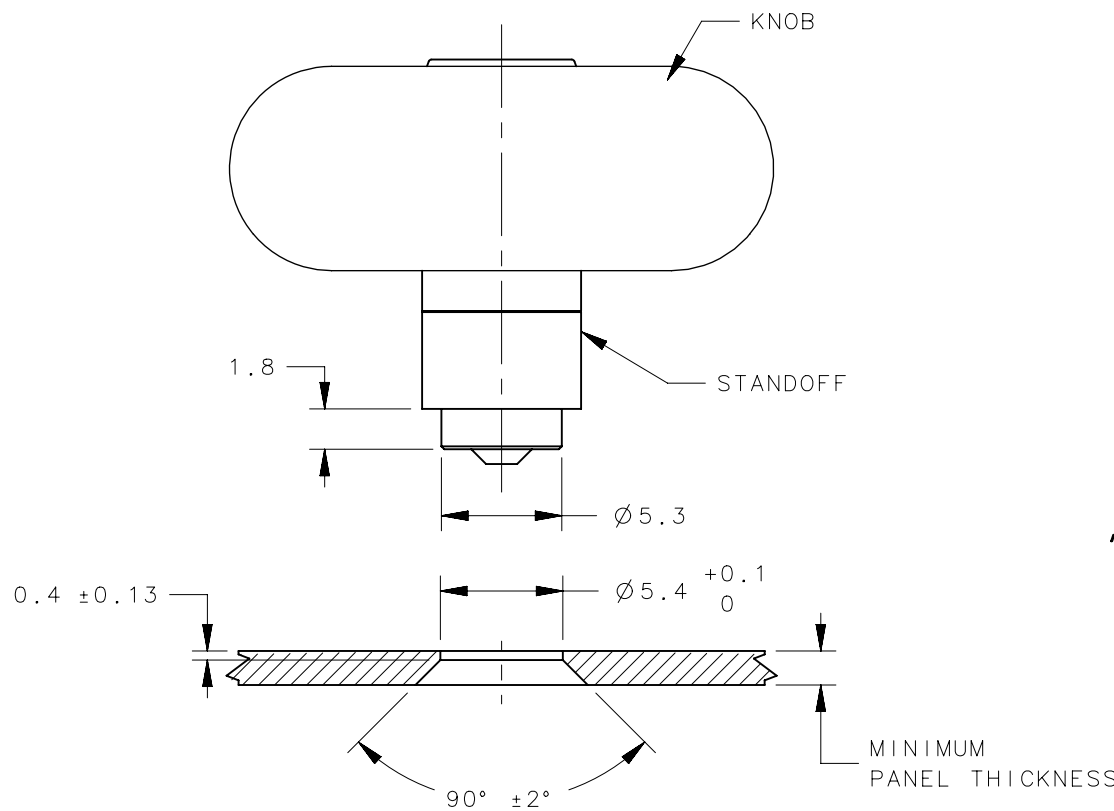

EEE KNOB COLOR
 000 - BLACK
 FOR ADDITIONAL COLORS SEE J-47-0-3

PANEL PREPARATION

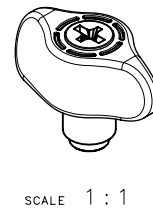

T15 TORX®/SLOT	4C-TS-06-2F1-WEEE		1.5	3.2
	2.1	6.6		
No.2 PHILLIPS/SLOT	4C-TS-06-1F1-WEEE		MIN	MAX
	0.5	5		
SCREW RECESS	4C-PS-06-2F1-WEEE		MIN	MAX
	4C-PS-06-1F1-WEEE			
SCREW RECESS		*P-1*	*P-2*	
		SCREW PROJECTION		PANEL THICKNESS

THIRD ANGLE PROJECTION				
MILLIMETERS [IN]				
SURFACE AREA	TOLERANCES UNLESS OTHERWISE NOTED		DESCRIPTION	
VOLUME	ALL DIMENSIONS WITHOUT TOLERANCES ARE FOR REFERENCE ONLY.		Captive Fastener	
PROPRIETARY ITEM	SIZE	SYSTEM	DWG NO.	
EXCEPT FOR USES EXPRESSLY GRANTED IN WRITING, INFORMATION DISCLOSED HEREON IS CONFIDENTIAL AND ALL RIGHTS, PATENT AND OTHERWISE, ARE RESERVED BY SOUTHCO, INC.	A3	NX	J-4C-1-632-W	
PER ASME Y14.5M-1994	DRAWN BY	DATE	SCALE	SHEET
	ER	08APR2015	3:1	1 OF 1