

Mini compact ejector

SCPM 05 NC A

<https://www.schmalz.com/10.02.02.01071>



Part no.: 10.02.02.01071

Homepage > Vacuum Technology for Automation > Vacuum Components > Vacuum Generators > Compact Ejectors > Compact Ejectors SCPM > SCPM 05 NC A

Mini-pump, compact ejector with minimum size



Nozzle size: 0,5 mm
Suction rate (max): 6 l/min
Air consumption (during evac.):
13 l/min
Control: Normally closed
Shape: Blow-off function

Design Data

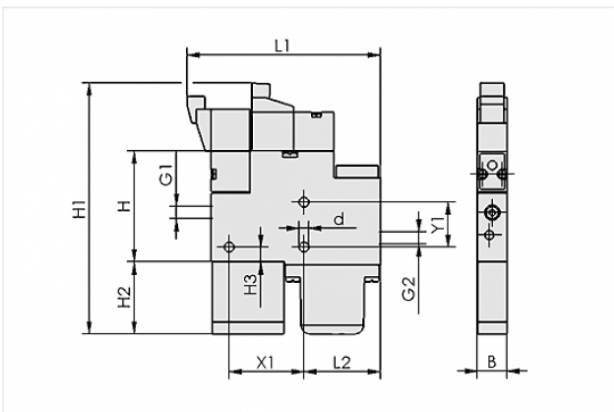

Attribute	Value
-----------	-------

B	10.2 mm
---	---------

d	3.2 mm
---	--------

G1	M5-F
----	------

G2	M5-F
----	------

H	37.5 mm
---	---------

H1	84 mm
----	-------

H2	24 mm
----	-------

H3	5 mm
----	------

L1	64.5 mm
----	---------

L2	25.5 mm
----	---------

X1	25 mm
----	-------

Y1	15 mm
----	-------

Contact to Schmalz

J. Schmalz GmbH | Johannes-Schmalz-Straße, 72293 Glatten, Deutschland | +49 7443 2403-102 | customercenter@schmalz.de

Technical Data

Attribute	Value
Nozzle diameter	0.5 mm
Degree of evacuation	85 %
Suction rate (max)	6 l/min
Suction rate (max)	0.4 m ³ /h
Air consumption (during evac.)	13 l/min
Air consumption (during evac.)	0.8 m ³ /h
Air consumption (blow off) (max)	26 l/min
Air consumption (blow off)	1.6 m ³ /h
Noise level (workp. gripped)	62 dB
Noise level (free)	62 dB
Pressure range (operating pressure)	2.0 ... 6.0 bar
Pressure optimal	4.5 bar
Int. hose diameter (recom.) comp.-air	2 mm
Int. hose diameter (recom.) vacuum side	2 mm
Control	Normally closed
Weight	80 g
Ambient temperature	0 ... 45 °C
Suction rate (max)	0.211 cfm
Air consumption (during evac.)	0.459 cfm
Air consumption (blow off)	0.941 cfm
Pressure range (operating pressure)	29.0 ... 87.0 psi
Pressure optimal	65.2 psi
Product family	SCPM

Note:

- The supply voltage for vacuum switches and solenoid valves is 24V DC
- Air consumption: At optimal operating pressure

Contact to Schmalz

- Hose diameter: For max. length 2 m

Spare Parts



SD 24x9.7x20 SCPM

Part no. 10.02.02.01029

Silencer for vacuum generators

Length L: 24 mm

Width B: 9.7 mm

Height H: 20 mm

for: Compact ejectors SCP



FILT-EINS 21.7 14.5 1.6 1 SCPM

Part no. 10.02.02.01037

Filter für compact ejector SMP

Length L: 21.7 mm

Width B: 14.5 mm

Height H: 1.6 mm

Quantity: 1

for: Compact ejectors SCP

Accessories



ASK B-MIC10 3000 K-2P

Part no. 21.04.06.00086

Connection cable

Interface Connection cable:

Connect. 10mm

Cable length: 3000 mm

Interface Connection cable: Cable 2

Material: PUR-Cable

