

Hose sleeve

ST G1-AG 25 MS-V

Part no.: 10.08.03.00167

<https://www.schmalz.com/10.08.03.00167>



Homepage > Vacuum Technology for Automation > Vacuum Components > Filters and Connections > Hoses and Connectors > Accessories for Screw Unions > ST G1-AG 25 MS-V

Hose sleeve



Thread 1: G1-M
Internal hose diameter: 25 mm
Material: Brass
Surface: nickel plated

Design Data

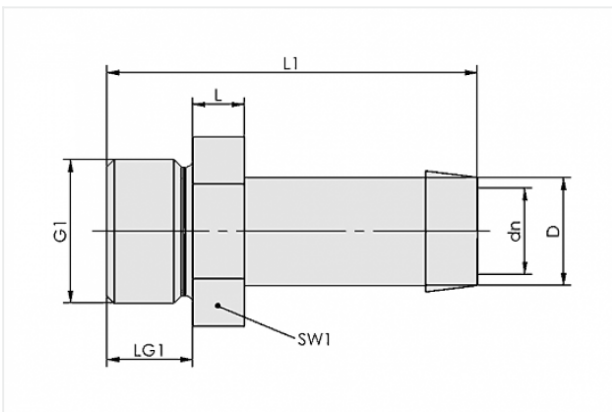

Attribute	Value
dn	22 mm
D	25 mm
G1	G1"-M
L	10.1 mm
L1	62 mm
LG1	15.8 mm
SW1	36 mm

Technical Data

Attribute	Value
Material	Brass

Contact to Schmalz

J. Schmalz GmbH | Johannes-Schmalz-Straße, 72293 Glatten, Deutschland | +49 7443 2403-102 | customercenter@schmalz.de

Attribute	Value
Weight	159 g

Accessories



VSL 33-25 PVC-DS

Part no. 10.07.09.00041

Hose for vacuum and compressed-air systems

External diameter D: 33 mm

Internal diameter d: 25 mm

Length (max): 50 m

Material: PVC, with wire spiral

Installation radius (min): 95 mm

Pressure range (operating pressure):

-0.85 ... 4.00 bar

Ambient temperature: -20 ... 70 °C



VSL 33-25 PU-DS

Part no. 10.07.09.00051

Hose for vacuum and compressed-air systems

External diameter D: 33 mm

Internal diameter d: 25 mm

Length (max): 10 m

Material: PU, with wire spiral

Installation radius (min): 75 mm

Pressure range (operating pressure):

-0.95 ... 4.00 bar

Ambient temperature: -40 ... 90 °C