

Hose sleeve

ST G1-1/2-AG 38 MS-V

Part no.: 10.08.03.00170

<https://www.schmalz.com/10.08.03.00170>



Homepage > Vacuum Technology for Automation > Vacuum Components > Filters and Connections > Hoses and Connectors > Accessories for Screw Unions > ST G1-1/2-AG 38 MS-V

Hose sleeve



Thread 1: G1-1/2-M
Internal hose diameter: 38 mm
Material: Brass
Surface: nickel plated

Design Data

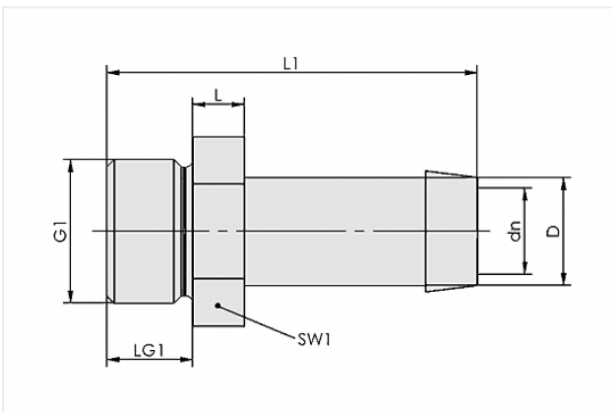

Attribute	Value
-----------	-------

dn	29.9 mm
----	---------

D	38 mm
---	-------

G1	G1-1/2"-M
----	-----------

L	12.2 mm
---	---------

L1	64 mm
----	-------

LG1	15.5 mm
-----	---------

SW1	50 mm
-----	-------

Technical Data

Attribute	Value
-----------	-------

Material	Brass
----------	-------

Contact to Schmalz

J. Schmalz GmbH | Johannes-Schmalz-Straße, 72293 Glatten, Deutschland | +49 7443 2403-102 | customercenter@schmalz.de

Attribute	Value
Weight	400 g

Accessories



VSL 47-38 PU-DS

Part no. 10.07.09.00052
 Hose for vacuum and compressed-air systems
 External diameter D: 47 mm
 Internal diameter d: 38 mm
 Length (max): 10 m
 Material: PU, with wire spiral
 Installation radius (min): 115 mm
 Pressure range (operating pressure):
 -0.94 ... 4.39 bar
 Ambient temperature: -20 ... 90 °C



VSL 48-38 PVC-DS

Part no. 10.07.09.00009
 Hose for vacuum and compressed-air systems
 External diameter D: 48 mm
 Internal diameter d: 38 mm
 Length (max): 30 m
 Material: PVC, with wire spiral
 Installation radius (min): 120 mm
 Pressure range (operating pressure):
 -0.88 ... 7.00 bar
 Ambient temperature: -20 ... 70 °C



VSL 44-38 PU-DS

Part no. 10.07.09.00031
 Hose for vacuum and compressed-air systems
 External diameter D: 44 mm
 Internal diameter d: 38 mm
 Length (max): 10 m
 Material: PU, with wire spiral
 Installation radius (min): 95 mm
 Pressure range (operating pressure):
 -0.82 ... 3.12 bar
 Ambient temperature: -20 ... 90 °C

