

# Bulkhead connector, straight

<https://www.schmalz.com/10.08.03.00320>



## SVS-GE M30x1.5-AG G1/2-IG 40

Part no.: 10.08.03.00320

Homepage > Vacuum Technology for Automation > Vacuum Components > Mounting Elements > Holder for Suction Cups and Spring Plungers >

Bulkhead Connectors SVS-GE > SVS-GE M30x1.5-AG G1/2-IG 40

## Bulkhead connector, straight with Nuts



Thread G1: M30x1.5-M

Thread G2: G1/2-F

Length L: 40 mm

## Design Data

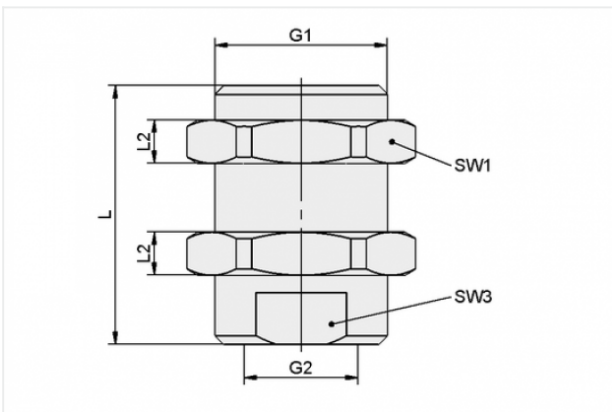

Attribute	Value
-----------	-------

G1	M30x1.5-M
----	-----------

G2	G1/2"-F
----	---------

L	40 mm
---	-------

L2	8 mm
----	------

SW1	36 mm
-----	-------

SW3	27 mm
-----	-------

## Technical Data

Attribute	Value
-----------	-------

Weight	185.1 g
--------	---------

## Contact to Schmalz

J. Schmalz GmbH | Johannes-Schmalz-Straße, 72293 Glatten, Deutschland | +49 7443 2403-102 | [customercenter@schmalz.de](mailto:customercenter@schmalz.de)



---

### Contact to Schmalz

J. Schmalz GmbH | Johannes-Schmalz-Straße, 72293 Glatten, Deutschland | +49 7443 2403-102 |  
customercenter@schmalz.de