

Bulkhead connector, straight

<https://www.schmalz.com/10.08.03.00318>



SVS-GE M20x1.5-AG G3/8-IG 30

Part no.: 10.08.03.00318

Homepage > Vacuum Technology for Automation > Vacuum Components > Mounting Elements > Holder for Suction Cups and Spring Plungers >

Bulkhead Connectors SVS-GE > SVS-GE M20x1.5-AG G3/8-IG 30

Bulkhead connector, straight with Nuts



Thread G1: M20x1.5-M

Thread G2: G3/8-F

Length L: 30 mm

Design Data

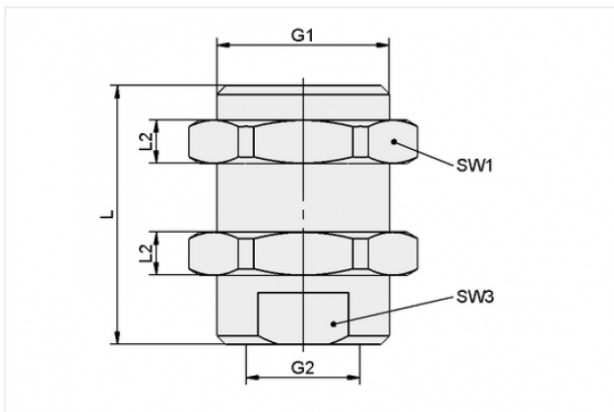

Attribute	Value
-----------	-------

G1	M20x1.5-M
----	-----------

G2	G3/8"-F
----	---------

L	30 mm
---	-------

L2	5 mm
----	------

SW1	24 mm
-----	-------

SW3	19 mm
-----	-------

Technical Data

Attribute	Value
-----------	-------

Weight	46.9 g
--------	--------

Contact to Schmalz

J. Schmalz GmbH | Johannes-Schmalz-Straße, 72293 Glatten, Deutschland | +49 7443 2403-102 | customercenter@schmalz.de

