

Suspension, fixable FST-C 100-HD1-R

Part no.: 10.01.20.01500

<https://www.schmalz.com/10.01.20.01500>



Homepage > Vacuum Technology for Automation > Vacuum Components > Mounting Elements > Suspension, fixable FST-C > FST-C 100-HD1-R

Suspension with height compensation and pneumat. clamping heavy-duty



Shape: Heavy Duty 1 sp. plug
Spring stroke Z: 100 mm
for: Large-area vacuum gripper
Weight: 10.8 kg
Installation position: Right

Design Data

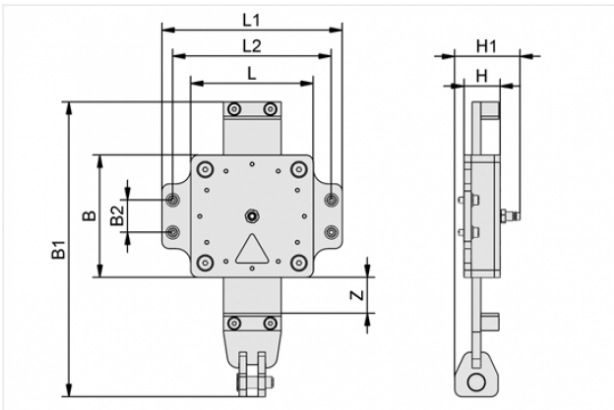

Attribute	Value
Z	100 mm
L1	250 mm
H	50 mm
B1	431.9 mm
H1	120 mm
L	170 mm
L2	220 mm
B	170 mm
B2	45 mm

Accessories

Contact to Schmalz

J. Schmalz GmbH | Johannes-Schmalz-Straße, 72293 Glatten, Deutschland | +49 7443 2403-102 | customercenter@schmalz.de



EMV 5 24V-DC 3/2 NO

Part no. 10.05.01.00068

Solenoid valve EMV for direct control of vacuum and compressed air

Nominal size: 5 mm

Voltage: 24V - DC

Function: 3/2-way valve

Control: Normally open

Connecting thread: G1/4-F

Power consumption (DC): 8 W



STV-GE G1/4-AG 6

Part no. 10.08.02.00205

Screw plug connection, straight

Thread G1: G1/4-M

External hose diameter: 6 mm

Material: Brass

Surface: nickel plated

Ambient temperature: -20 ... 80 °C