

# Hose sleeve

## ST G3/8-AG 12 MS-V

Part no.: 10.08.03.00160

<https://www.schmalz.com/10.08.03.00160>



Homepage > Vacuum Technology for Automation > Vacuum Components > Filters and Connections > Hoses and Connectors > Accessories for Screw Unions > ST G3/8-AG 12 MS-V

## Hose sleeve



Thread 1: G3/8-M  
Internal hose diameter: 12 mm  
Material: Brass  
Surface: nickel plated

## Design Data

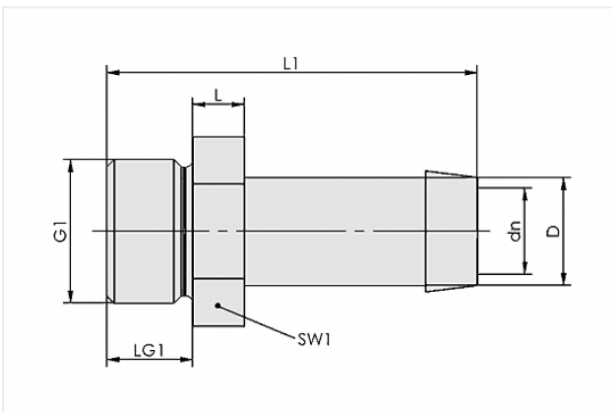

| Attribute | Value |
|-----------|-------|
|-----------|-------|

|    |       |
|----|-------|
| dn | 10 mm |
|----|-------|

|   |       |
|---|-------|
| D | 13 mm |
|---|-------|

|    |         |
|----|---------|
| G1 | G3/8"-M |
|----|---------|

|   |        |
|---|--------|
| L | 5.9 mm |
|---|--------|

|    |       |
|----|-------|
| L1 | 43 mm |
|----|-------|

|     |       |
|-----|-------|
| LG1 | 10 mm |
|-----|-------|

|     |       |
|-----|-------|
| SW1 | 19 mm |
|-----|-------|

## Technical Data

| Attribute | Value |
|-----------|-------|
|-----------|-------|

|          |       |
|----------|-------|
| Material | Brass |
|----------|-------|

## Contact to Schmalz

J. Schmalz GmbH | Johannes-Schmalz-Straße, 72293 Glatten, Deutschland | +49 7443 2403-102 | [customercenter@schmalz.de](mailto:customercenter@schmalz.de)

| Attribute | Value |
|-----------|-------|
| Weight    | 38 g  |

---

## Accessories



### VSL 18-12 PVC-DS

Part no. 10.07.09.00016

Hose for vacuum and compressed-air systems

External diameter D: 18 mm

Internal diameter d: 12 mm

Length (max): 30 m

Material: PVC, with wire spiral

Installation radius (min): 85 mm

Pressure range (operating pressure):

-0.90 ... 5.00 bar

Ambient temperature: -20 ... 70 °C



### VSL 21-12 PVC-G

Part no. 10.07.09.00006

Hose for vacuum and compressed-air systems

External diameter D: 21 mm

Internal diameter d: 12 mm

Length (max): 50 m

Material: PVC, with textile layer

Installation radius (min): 80 mm

Pressure range (operating pressure):

-0.95 ... 10.00 bar

Ambient temperature: -20 ... 70 °C