

Hose sleeve

ST G1/4-AG 12 MS-V

Part no.: 10.08.03.00158

<https://www.schmalz.com/10.08.03.00158>



Homepage > Vacuum Technology for Automation > Vacuum Components > Filters and Connections > Hoses and Connectors > Accessories for Screw Unions > ST G1/4-AG 12 MS-V

Hose sleeve



Thread 1: G1/4-M
Internal hose diameter: 12 mm
Material: Brass
Surface: nickel plated

Design Data

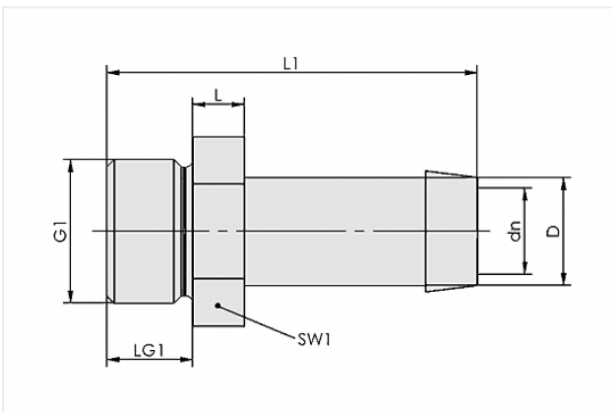

Attribute	Value
-----------	-------

dn	7.5 mm
----	--------

D	13 mm
---	-------

G1	G1/4"-M
----	---------

L	5.5 mm
---	--------

L1	42 mm
----	-------

LG1	10 mm
-----	-------

SW1	17 mm
-----	-------

Technical Data

Attribute	Value
-----------	-------

Material	Brass
----------	-------

Contact to Schmalz

J. Schmalz GmbH | Johannes-Schmalz-Straße, 72293 Glatten, Deutschland | +49 7443 2403-102 | customercenter@schmalz.de

Attribute	Value
Weight	32 g

Accessories



VSL 18-12 PVC-DS

Part no. 10.07.09.00016

Hose for vacuum and compressed-air systems

External diameter D: 18 mm

Internal diameter d: 12 mm

Length (max): 30 m

Material: PVC, with wire spiral

Installation radius (min): 85 mm

Pressure range (operating pressure):

-0.90 ... 5.00 bar

Ambient temperature: -20 ... 70 °C



VSL 21-12 PVC-G

Part no. 10.07.09.00006

Hose for vacuum and compressed-air systems

External diameter D: 21 mm

Internal diameter d: 12 mm

Length (max): 50 m

Material: PVC, with textile layer

Installation radius (min): 80 mm

Pressure range (operating pressure):

-0.95 ... 10.00 bar

Ambient temperature: -20 ... 70 °C