

Solenoid valve EMV for direct control of compressed air

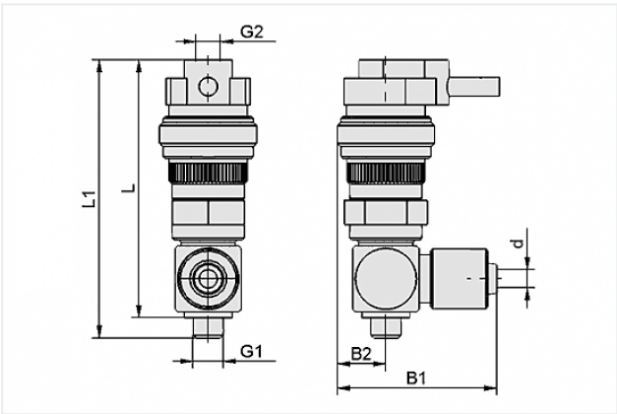

Nominal size: 2.5 mm
Voltage: 24V - DC
Function: 3/2-way valve
Control: Normally closed
Connecting thread: G1/8-M
contains: Cable 2
Cable length: 3 m

Design Data



Attribute	Value
B1	31.7 mm
B2	10.7 mm
d	4 mm
G1	G1/8"-M
G2	M5-F
L	51.7 mm
L1	56.5 mm

Technical Data

Attribute	Value
Nominal size	2.5 mm

Contact to Schmalz

Attribute	Value
Control	Normally closed
Nominal flow rate	135 l/min
Nominal flow rate	8.1 m³/h
Voltage	24V - DC
Weight	0.1 kg