

# Hose sleeve

## ST G1/8-AG 4 MS-V

Part no.: 10.08.03.00153

<https://www.schmalz.com/10.08.03.00153>



Homepage > Vacuum Technology for Automation > Vacuum Components > Filters and Connections > Hoses and Connectors > Accessories for Screw Unions > ST G1/8-AG 4 MS-V

## Hose sleeve



Thread 1: G1/8-M  
Internal hose diameter: 4 mm  
Material: Brass  
Surface: nickel plated

## Design Data

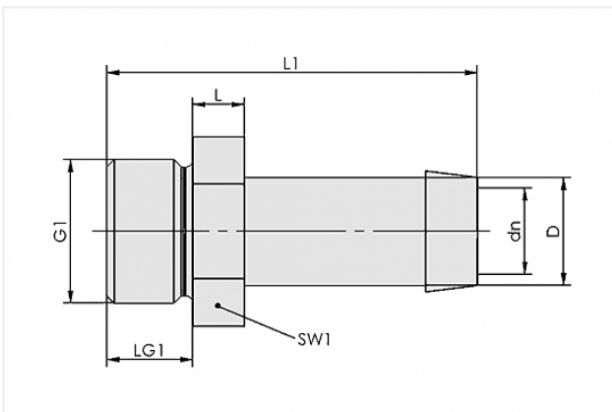

Attribute	Value
-----------	-------

dn	3.5 mm
D	4.5 mm
G1	G1/8"-M
L	5 mm
L1	34 mm
LG1	8 mm
SW1	14 mm

## Technical Data

Attribute	Value
Material	Brass

### Contact to Schmalz

J. Schmalz GmbH | Johannes-Schmalz-Straße, 72293 Glatten, Deutschland | +49 7443 2403-102 | [customercenter@schmalz.de](mailto:customercenter@schmalz.de)

Attribute	Value
Weight	13 g

## Accessories



### VSL 6-4 PTFE

Part no. 10.07.09.00157  
 Hose for vacuum and compressed-air systems  
 External diameter D: 6 mm  
 Internal diameter d: 4 mm  
 Length (max): 50 m  
 Material: Polytetrafluorethylene  
 Installation radius (min): 35 mm  
 Colour: natur  
 Ambient temperature: -190 ... 260 °C

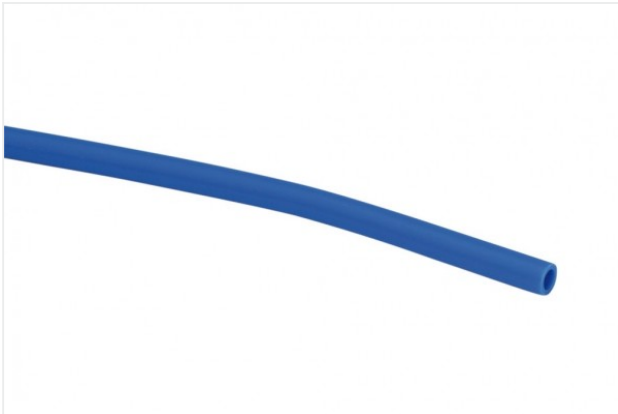

### VSL 6-4 PE

Part no. 10.07.09.00014  
 Hose for vacuum and compressed-air systems  
 External diameter D: 6 mm  
 Internal diameter d: 4 mm  
 Length (max): 100 m  
 Material: PE  
 Installation radius (min): 35 mm  
 Pressure range (operating pressure):  
 -0.95 ... 10.00 bar  
 Ambient temperature: -30 ... 70 °C



### VSL 6-4 PU

Part no. 10.07.09.00002  
 Hose for vacuum and compressed-air systems  
 External diameter D: 6 mm  
 Internal diameter d: 4 mm  
 Length (max): 500 m  
 Material: PU  
 Installation radius (min): 35 mm  
 Pressure range (operating pressure):  
 -0.95 ... 10.00 bar  
 Ambient temperature: -20 ... 90 °C

