

Hose sleeve

ST M5-AG 4 MS-V

Part no.: 10.08.03.00152

<https://www.schmalz.com/10.08.03.00152>



Homepage > Vacuum Technology for Automation > Vacuum Components > Filters and Connections > Hoses and Connectors > Accessories for Screw Unions > ST M5-AG 4 MS-V

Hose sleeve



Thread 1: M5-M
Internal hose diameter: 4 mm
Material: Brass
Surface: nickel plated

Design Data

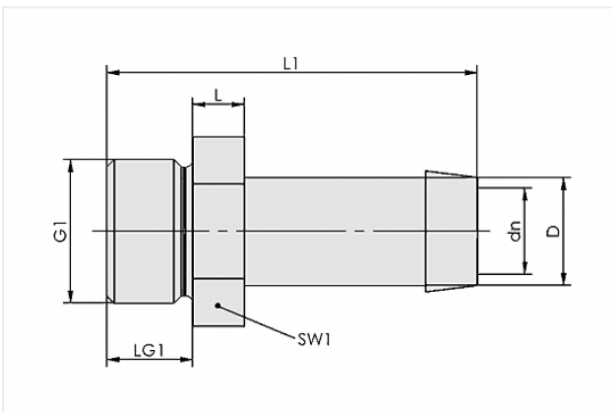

Attribute	Value
-----------	-------

dn	2.2 mm
----	--------

D	4.4 mm
---	--------

G1	M5-M
----	------

L	3.3 mm
---	--------

L1	18.4 mm
----	---------

LG1	4.4 mm
-----	--------

SW1	8 mm
-----	------

Technical Data

Attribute	Value
-----------	-------

Material	Brass
----------	-------

Contact to Schmalz

J. Schmalz GmbH | Johannes-Schmalz-Straße, 72293 Glatten, Deutschland | +49 7443 2403-102 | customercenter@schmalz.de

Attribute	Value
Weight	2 g

Accessories



VSL 6-4 PTFE

Part no. 10.07.09.00157
 Hose for vacuum and compressed-air systems
 External diameter D: 6 mm
 Internal diameter d: 4 mm
 Length (max): 50 m
 Material: Polytetrafluorethylene
 Installation radius (min): 35 mm
 Colour: natur
 Ambient temperature: -190 ... 260 °C

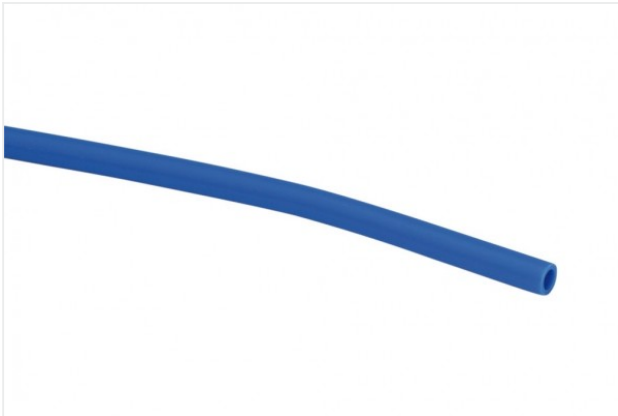

VSL 6-4 PE

Part no. 10.07.09.00014
 Hose for vacuum and compressed-air systems
 External diameter D: 6 mm
 Internal diameter d: 4 mm
 Length (max): 100 m
 Material: PE
 Installation radius (min): 35 mm
 Pressure range (operating pressure):
 -0.95 ... 10.00 bar
 Ambient temperature: -30 ... 70 °C



VSL 6-4 PU

Part no. 10.07.09.00002
 Hose for vacuum and compressed-air systems
 External diameter D: 6 mm
 Internal diameter d: 4 mm
 Length (max): 500 m
 Material: PU
 Installation radius (min): 35 mm
 Pressure range (operating pressure):
 -0.95 ... 10.00 bar
 Ambient temperature: -20 ... 90 °C

