

SECTION A-A

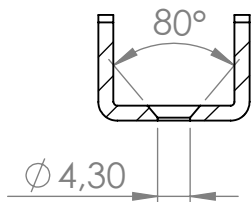

ITEM NO.	PART NUMBER	DESCRIPTION	QTY.
1	728121	Baseplate 701 L/C ZP	1
2	72101	Bracket 701 ZP	1
3	620501	Mid cylinder 701 ZP	1
4	62001	Rivet 701 ZP	2
5	720601	Screw loop 701 ZP	1



FINISH: Zinc Plated

DEBURR AND BREAK SHARP EDGES

REVISION

OJOP Sweden AB

NAME	SIGNATURE	DATE
DRAWN RR		3/5 - 17
CHKD PR		13/7 - 17
APPVD XXXX		XXXX
MFG XXXX		XXXX
Q.A XXXX		XXXX

TITLE: 52012 - 701 LC ZP

MATERIAL: DC01

DWG NO. 52012 - 701 LC ZP

A4

WEIGHT: 0,041 KG

SCALE:1:1

SHEET 1 OF 1