

# PIANO HINGE LH

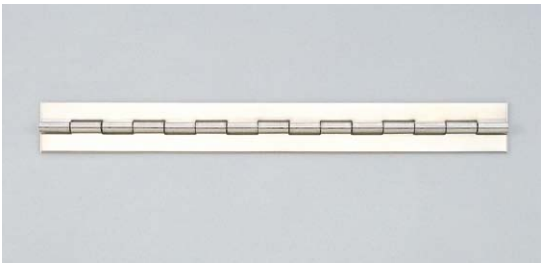

- Can be cut to any length. In case of cutting the hinge, please cut the side without knurling to prevent the shaft from coming off.
- Special dimensions and drilled products also available.

**[Remarks]**

- Load capacity is the value when using one hinges. For calculation conditions, please refer to INDEX 1.

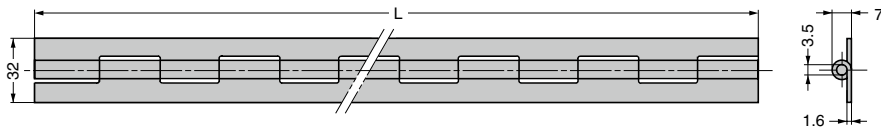

RoHS	CAD	Item Code	Item Name	Material	Finish	L	Load Capacity N/pc	Load Capacity kgf/pc	Weight (g)	Box (pcs)
✔	SD	170-095-505	LH-30A	Steel (SPCC)	Clear Zinc Chromate	300	216	22	175	30
✔	SD	170-095-508	LH-35A			350	255	26	205	30
✔	SD	170-090-507	LH-45A			450	324	33	265	30
✔	SD	170-095-512	LH-60A			600	431	44	350	10
✔	SD	170-095-515	LH-75A			750	539	55	437	10
✔	SD	170-095-518	LH-85A			850	569	58	493	10
✔	SD	170-095-521	LH-90A			900	598	61	522	10
✔	SD	170-095-524	LH-100A			1000	618	63	551	10

Refer to 1 : P.15

TORQUE HINGES

DAMPER HINGES

LIFT ASSIST HINGES

DETENT HINGES

CONCEALED HINGES

BUTT HINGES

PIANO HINGES

STEP HINGES

LIFT-OFF HINGES

# PIANO HINGE LHN



- Length from 1200 to 2100mm suitable for various application.
- Can be cut to any length.

**[Remarks]**

- Size L is slightly shorter. Please check with actual item.
- Mounting hole pitch is actually measured on wooden item. Not suitable for sheet metal and installation with mounting hole pitch limitation.
- Take care not to damage the shaft when cutting.
- Attention should be paid to prevent the shaft from coming off.
- When installing this hinge to sheet metal, be sure to perform thread relief processing (chamfering) on the mounting surface side (cabinet side). In this way, screw head will not protrude when the hinge is fixed.
- Load capacity is the value when using one hinges. For calculation conditions, please refer to INDEX 1.

**[Application Example]**

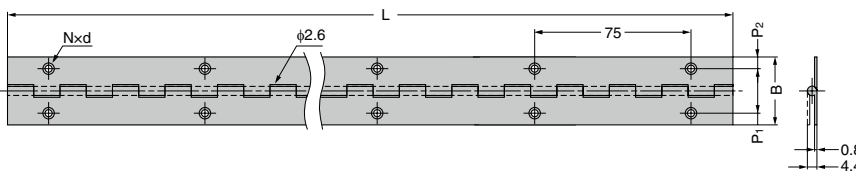
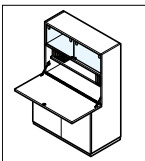

RoHS	CAD	Item Code	Item Name	Material	Finish	L	B	P <sub>1</sub>	P <sub>2</sub>	Qty of Holes N	d	Load Capacity N/pc	Load Capacity kgf/pc	Weight (g)	Box (pcs)
✔	SD	170-097-846	LHN-32-1200	Stainless Steel (SUS304)	Polished	1200	32	20	6	32	φ4	549	56	400	30
✔	SD	170-097-847	LHN-32-1500			1500				40		588	60	400	30
✔	SD	170-097-848	LHN-32-1872			1872				50		745	76	400	30
✔	SD	170-097-849	LHN-32-2100			2100	56	834	85	600	30				
✔	SD	170-097-850	LHN-38-1200			1200	38	22.5	7.75	32	φ4.6	549	56	400	30
✔	SD	170-097-843	LHN-38-1500			1500				40		588	60	400	30
✔	SD	170-097-844	LHN-38-1872			1872				50		745	76	600	30
✔	SD	170-097-845	LHN-38-2100			2100	56	834	85	650	30				

Refer to 1 : P.15

PIVOT HINGES

SPRING HINGES

CLEAN ROOM HINGES

HINGES FOR ALUMINIUM FRAME

DROP HINGES

GLASS DOOR HINGES

SPECIAL HINGES