

FOLDING BRACKET 388-D Built-in Damper



- Can be folded for saving space when not in use.
- The built-in damper allows for soft closing which prevents accidental shutting.
- Made of aluminium alloy for a lighter body.
- Can also be used together with the 388 bracket. (without damper model) **1**

[Recommended Number of Bracket]

- Shelf width is under 600 mm : 1 pc
- Shelf width is 600-1300 mm : 2 pcs
- *See also the [Selection Guide].

[Parts Included]

- Cross-recessed truss head tapping screw ST4.8 x 38
- Cross-recessed truss head tapping screw ST4.8 x 16

[Optional Part]

- Folding hinge 388 H
- Folding bracket 388

[Remarks]

- When folding/unfolding the brackets, please hold both the shelf and brackets with hands.
- Make enough space for the shelf to lift up. See the [How to Use].
- Recommended shelf thickness: 15 - 35 mm
- The load capacity was measured at the position demonstrated in the [Dimensions] drawing below.

[How to Use]

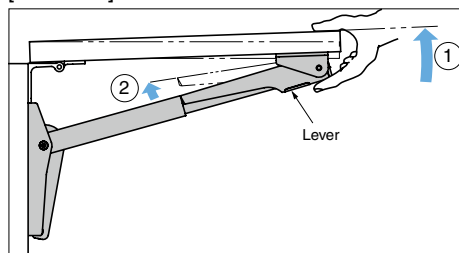

Note: ① Do not lift up the shelf forcibly. It may result in breakage.

[Installation Example]

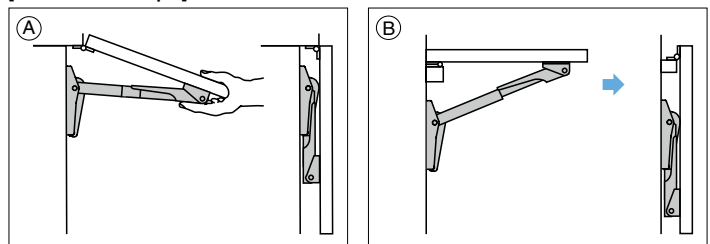

*Installation B: the 388H hinge can not be used.

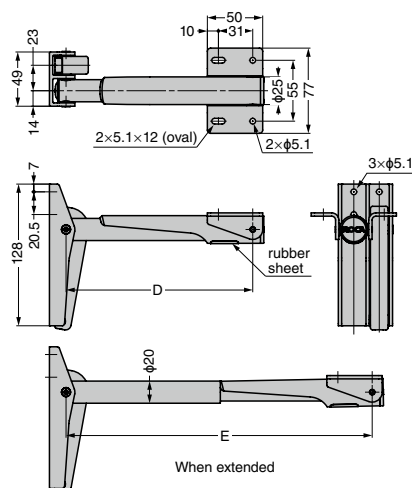
[Recommended Hinge] **2**

[Dimensions]

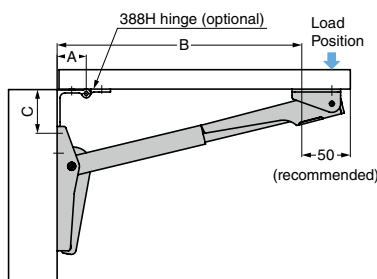
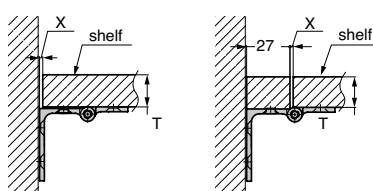
[Installation with the 388H Hinges] **1**

Thickness T and Clearance X	
T	X
< 20	1
20 - 40	2

[Selection Guide] Number of Brackets and Shelf Spec

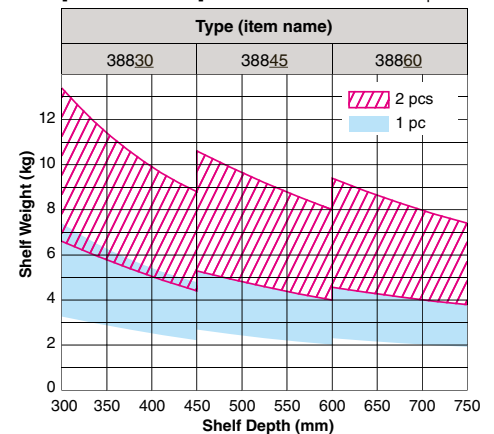

*If 388-D (1pc) is used together with 388 (1pc), please refer to **1 pc** of graph above.

RoHS	CAD	Item Code	Item Name	Material	Finish / Colour	A	B	C	D	E	Load Capacity/pc		Weight (g)	Box	Carton
											N	kgf			
●	●	120-048-966	38830-25-D	Aluminium Alloy	Silver Anodised	28-39	252	45	168	275.9	309	31	341	5	50
●	●	120-048-967	38845-25-D			28-50	402	87	258.5	430.8	330	33	411	5	30
●	●	120-048-968	38860-25-D			28-40	549	137	368.5	585.8	360	36	491	5	30
●	●	120-048-969	38830-25-BL-D		Black Anodised	28-39	252	45	168	275.9	309	31	341	5	50
●	●	120-048-970	38845-25-BL-D			28-50	402	87	258.5	430.8	330	33	411	5	30
●	●	120-048-971	38860-25-BL-D			28-40	549	137	368.5	585.8	360	36	491	5	30

Refer to **1** : No.240A P.160