

MONITOR ARM KA-T100S50-W/P Free Stop and Lock / For Touch Screens

INSTRUCTION

Free Stop

Passed 20,000 private cycle test



KA-T100S50-W3-BL



KA-T100S50-P2-WT

- The robust structure securely holds monitors in position. It prevents touch screens from shaking or causing unintentional inputs.
- Allows for free-stop motion in tilt and swivel directions.
- Comes with auxiliary lock mechanism which prevents sagging.
- The auxiliary lock has a safety function. The lock temporarily releases to avoid breakage to avoid breakage if an unintentional heavy load is applied on it.
- One-touch installation and removal.

[Specification]

- Compliant with the VESA standard. (75x75mm, 100x100mm)
- Available monitor size: 12 - 23 inches (Weight: Max. 10 kg)

[Application]

- Liquid crystal monitors for machine tools, OA equipment and medical equipment

[Remarks]

- Do not forcibly move the monitor after auxiliary lock is activated.
- After installing the monitor, make sure that the release lever is locked.
- Do not operate continuously (repeatedly in a short time).
- Avoid water, oil, and lubricant from getting on the product.

[Parts Included]

- Cable tie

[Optional Parts]

- Rotation Bracket KA-T100S50-PMT **1**

Video Link

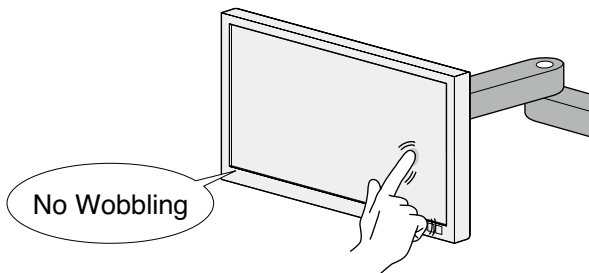
**[Stable Operation]**

Prevents touch screens from shaking or causing unintentional inputs.

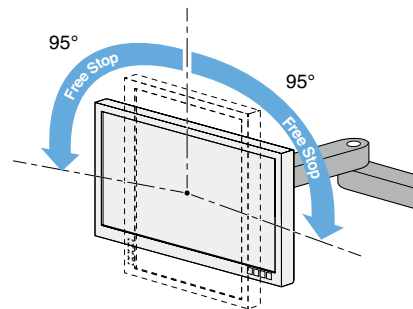
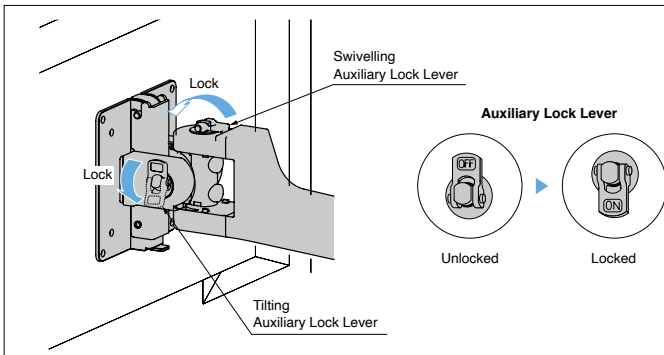
[Rotational Motion]The optional rotation bracket allows for free stop in the rotation direction.
(Free-stop range: 95° on each side)**[Auxiliary Lock Operation]**

The auxiliary lock temporarily releases to avoid breakage if unintentional heavy load is applied to it.



*Do not forcibly move monitors when locked.

[Installation and Removal]**Installation**

- ① Fit the protrusion into the groove of the bracket.
- ② Push the lower part of mounting plate.

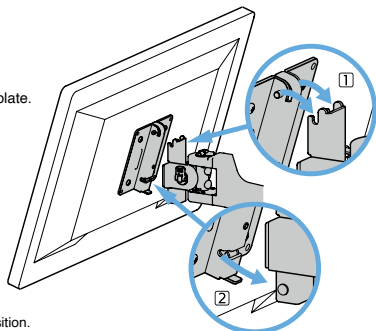

*Make sure the mark is in upward position.

Removal

Push down the release lever and tilt the monitor, then the monitor can be removed.

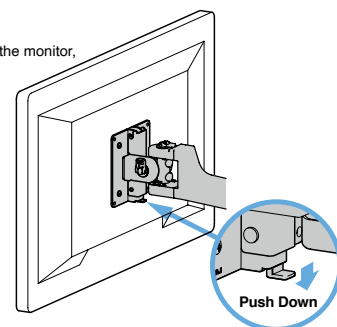
Refer to **1D** :PC8

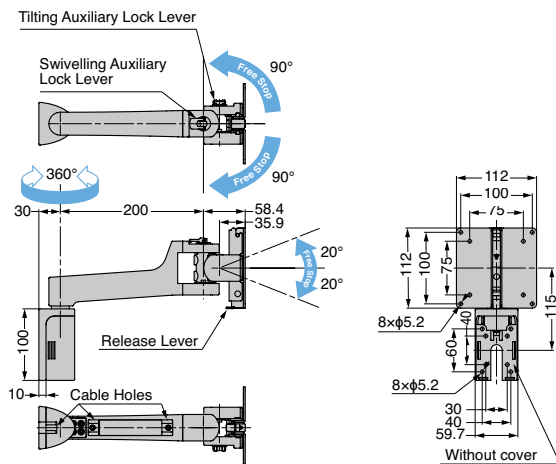
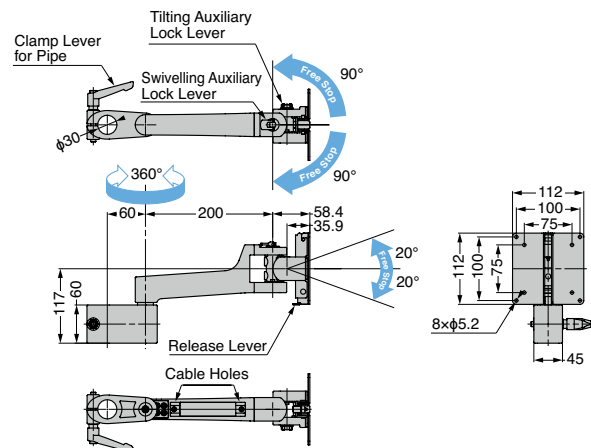
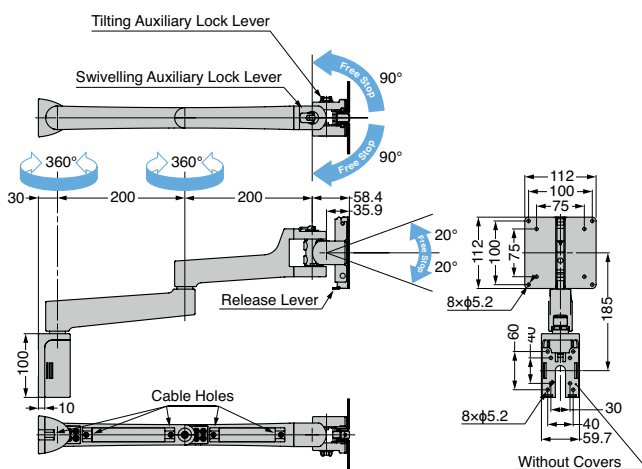
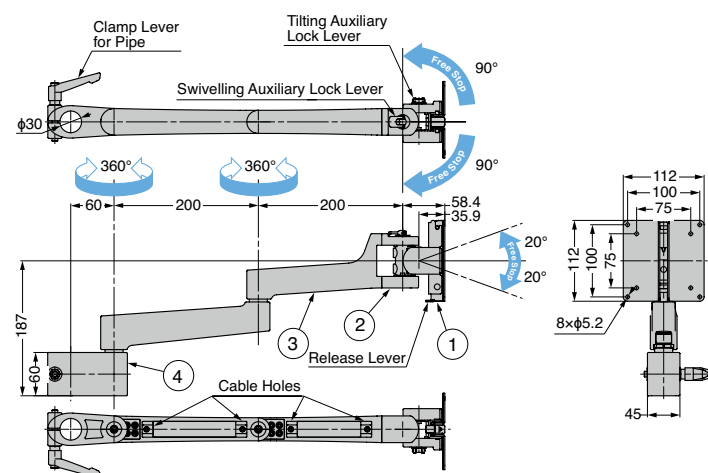
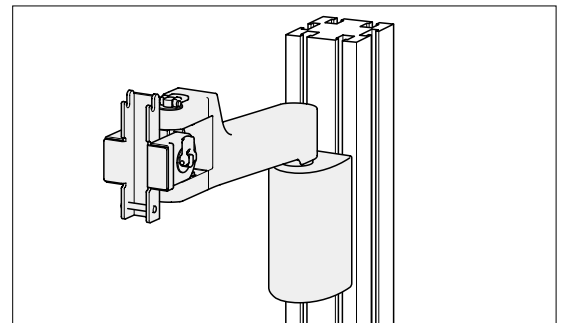
[KA-T100S50-W2] Wall Mount / Single Arm**[KA-T100S50-P2] Pipe Mount (φ30) / Single Arm****[KA-T100S50-W3] Wall Mount / Double Arms****[KA-T100S50-P3] Pipe Mount (φ30) / Double Arms****[Can be mounted on aluminium frame] For wall mount type**

Available Aluminium Frame: 30 x 60 mm or 40 x 80 mm / 2 slots

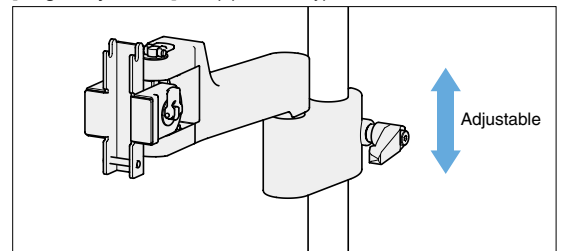
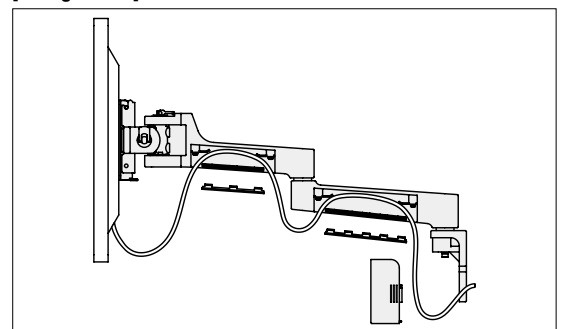
[Height Adjustment] For pipe mount type**[Wiring Cables]**

Comes with covers for cables.

No.	Part Name	Material	Finish
①	Mounting Plate	Steel (SPCC)	Electrodeposition
②	Body	Steel (SPCC) / ABS	
③	Arm	Aluminium Alloy (ADC) / ABS	Matte Anodized
④	Base	Aluminium Alloy (ADC)	

RoHS	CAD	Item Code	Item Name	Type	Colour	Torque N·m (Tilt)	Torque N·m (Rotation)		
							Monitor Part	Center Part	Mounting Part
●	●	210-048-353	KA-T100S50-W2-BL	Wall Mount / Single Arm	Black	10 ±20%	5.0 ±20%	-	8.0 ±20%
●	●	210-048-354	KA-T100S50-W2-WT		White				
●	●	210-048-349	KA-T100S50-P2-BL	Pipe Mount (φ30) / Single Arm	Black				
●	●	210-048-350	KA-T100S50-P2-WT		White				
●	●	210-048-355	KA-T100S50-W3-BL	Wall Mount / Double Arms	Black		4.0 ±20%		
●	●	210-048-356	KA-T100S50-W3-WT		White				
●	●	210-048-351	KA-T100S50-P3-BL	Pipe Mount (φ30) / Double Arms	Black				
●	●	210-048-352	KA-T100S50-P3-WT		White				