

PANEL FIXING MIDDLE BRACKET AS-PTB

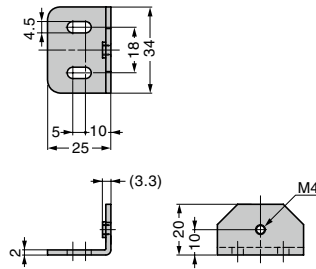

- Used for preventing panel flapping when installed to aluminium frame.
- For corner connector PJ type with screw hole.
- For recommended panel thickness, see panel installation dimensions **1**.
- AS parts set for installing to aluminium frame also available. Content of the parts set is as follows.

[Remarks]

- Mounting screws not included when ordering single bracket. Please prepare mounting screws of appropriate length according to aluminium frames.

MAGNETIC CATCHES

KNUCKLE CATCHES & TENSION CATCHES

TOUCH LATCHES

LEVER LATCHES

SLIDE / BARREL BOLTS

DRAW LATCHES

PUSH LOCK FASTENERS & KNOB FASTENERS

ALUMINIUM FRAME CORNER CONNECTORS

DOOR DAMPERS

RoHS	CAD	Item Code	Item Name	Material	Finish	Weight (g)	Box (pcs)	Carton (pcs)
☑	3D	210-010-541	AS-PTB	Stainless Steel (SUS430)	Barrel Polishes	20	50	400

Refer to **1** : P.704

Parts Set for Installing to Aluminium Frame

Please refer to the series introduction page **1** for details about AS series.

[Dimensions]

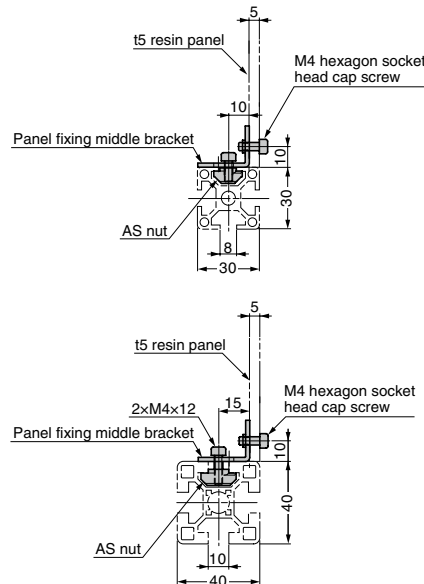

[Installation]

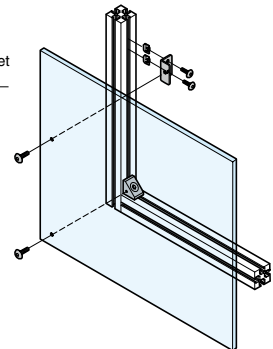

[AS Parts Set] Parts set of screws and AS nuts

RoHS	CAD	Item Code	Item Name	Aluminium Frame	Parts	Weight (set)
☑	-	210-041-815	AS-PTB-30-6	30 × 30 Groove Width 6 mm	Panel Fixing Middle Bracket AS-PTB : 1 pc AS Nut AS-6M4 : 2 pcs M4 × 10 Hexagon Socket Head Cap Screw : 3 pcs	29
☑	-	210-041-816	AS-PTB-40-8	40 × 40 Groove Width 8 mm	Panel Fixing Middle Bracket AS-PTB : 1 pc AS Nut AS-8M4 : 2 pcs M4 × 12 Hexagon Socket Head Cap Screw : 2 pcs M4 × 10 Hexagon Socket Head Cap Screw : 1 pc	34
☑	-	210-041-817	AS-PTB-30-8	30 × 30 Groove Width 8 mm	Panel Fixing Middle Bracket AS-PTB : 1 pc AS Nut AS-8M4 : 2 pcs M4 × 10 Hexagon Socket Head Cap Screw : 3 pcs	35
☑	-	210-041-818	AS-PTB-40-10	40 × 40 Groove Width 10 mm	Panel Fixing Middle Bracket AS-PTB : 1 pc AS Nut AS-10M4 : 2 pcs M4 × 12 Hexagon Socket Head Cap Screw : 2 pcs M4 × 10 Hexagon Socket Head Cap Screw : 1 pc	40

Refer to **1** : FRONT P.20, **2** : P.706