

# STAINLESS STEEL AS NUT Post-installation Type

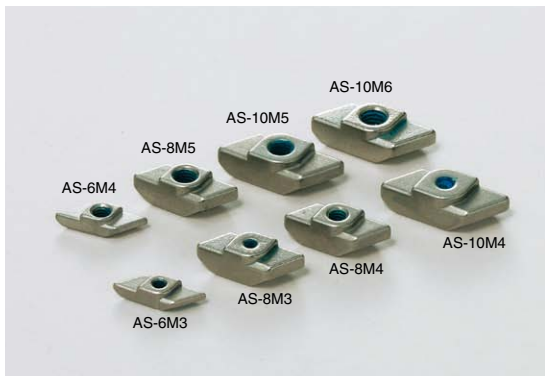

- Used for fixing a part to aluminium frame and makes post-installation possible.
- With coating to prevent looseness of screw.
- Can fix aluminium frame and hardware securely.
- Improved work efficiency with few installation mistakes.
- Widely applied to various aluminium frames.
- Refer to the product page [1](#) for details on AS series.

**[Remarks]**

- Install with the recommended tightening torque. AS nut not included in the parts set of AS series (for installing to aluminium frame).
- The effect of anti-looseness coating weakens when used repeatedly. Please use at most 2~3 times as a guide.
- Mounting screws not included when ordering single AS nut. Please prepare mounting screws of appropriate length according to aluminium frames.

**[Applicable Groove Width]**

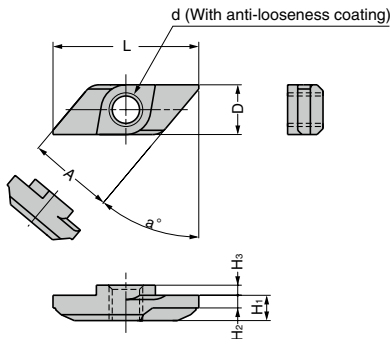
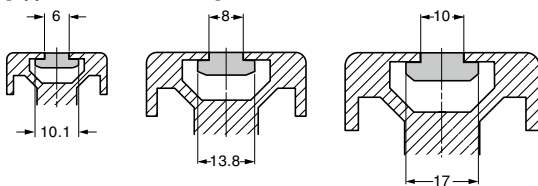

RHS	CAD	Item Code	Item Name	Type	d	L	D	A	H <sub>1</sub>	H <sub>2</sub>	H <sub>3</sub>	a	Material	Finish	Recommended Tightening Torque		Weight (g)	Box (pcs)	Carton (pcs)
															N·m	kgf·cm			
		120-040-676	AS-6M3	For 6 mm Groove	M3	17.3	5.9	10.1	3	1.5	1.2	40	Stainless Steel (SUS316)	Barrel Polished	0.63~1.14	6.4~11.6	1.9	1000	10000
		120-040-684	AS-6M4		M4										1.5~2.7	15.3~27.5			
		120-040-677	AS-8M3	For 8 mm Groove	M3	20	7.9	13.8	6	3	1.5	32	Stainless Steel (SUS316)	Barrel Polished	0.63~1.14	6.4~11.6	4.3	500	3000
		120-040-685	AS-8M4		M4										1.5~2.7	15.3~27.5			
		120-040-686	AS-8M5	For 10 mm Groove	M5	24	9.8	17	6	3	1.8	32	Stainless Steel (SUS316)	Barrel Polished	3~5.4	30.6~55.1	3.9	500	3000
		120-040-678	AS-10M4		M4										1.5~2.7	15.3~27.5			
		120-040-687	AS-10M5	For 10 mm Groove	M5	24	9.8	17	6	3	1.8	32	Stainless Steel (SUS316)	Barrel Polished	3~5.4	30.6~55.1	7	250	1500
		120-040-679	AS-10M6		M6										5.2~9.2	53~93.8			

**[Installation]**

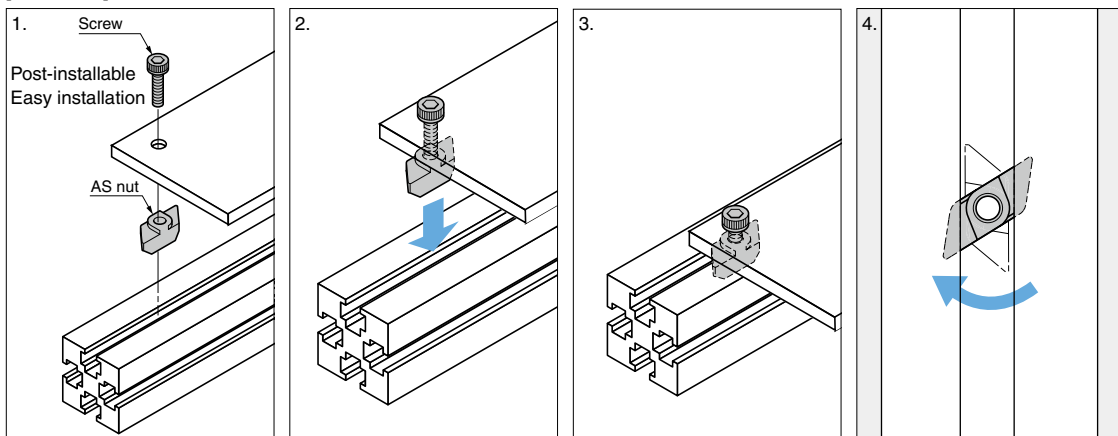

1. Temporarily fix the AS nut to the functional hardware with mounting screw.
2. Insert the AS nut into the groove of the aluminium frame.
3. Make sure that the AS nut is in the groove, and then tighten the screw.
4. When tightening the screw, AS nut rotates and is caught on the aluminium frame and fixes the functional hardware securely.

Refer to [1](#) : FRONT P.20