

MAGNETIC CATCH MS

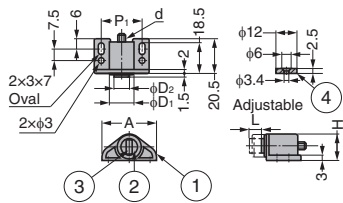

- Yoke position adjustable back and forward.

[Remarks]

- Be sure to read the "Cautions" 1.
- Screws not included.
- Magnet yoke without surface finish may rust.

[Parts Included]

- Counter plate W4 2

No.	Part Name	Material	Finish / Colour
①	Body	Plastic	White, Brown
②	Yoke	Steel	Plain
③	Magnet	Ferrite	—
④	Counter Plate W4	Steel (SPHC)	Coloured Zinc Chromate (Trivalent)

RoHS	CAD	Item Code	Item Name	Colour	A	P ₁	D ₁	D ₂	d	H	L	Magnetic Force N	Magnetic Force kgf	Weight (g)	Box (pcs)	Carton (pcs)
—	SD	140-050-506	MS4WP	White	33	25.5	14	9	M4	16.5	5	23.5	2.4	11.7	—	1000
—	SD	140-050-507	MS4BRP	Brown	33	25.5	14	9	M4	16.5	5	23.5	2.4	11.7	—	1000
—	SD	140-050-508	MS6WP	White	36.5	28	17	11	M5	19	3	39.2	4	17.7	—	1000
—	SD	140-050-509	MS6BRP	Brown	36.5	28	17	11	M5	19	3	39.2	4	17.7	—	1000

Refer to 1 : P.607, 2 : P.639

MAGNETIC CATCH MC-125

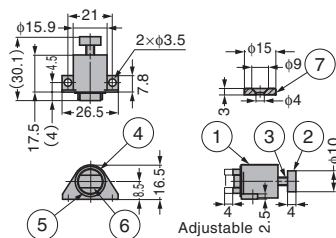

- Yoke position adjustable 4mm back and forward.
- Yoke position adjustable back and forward by turning the knob on the back side of the body.

[Remarks]

- Be sure to read the "Cautions" 1.
- Screws not included.

[Parts Included]

- Counter plate W12 2

No.	Part Name	Material	Finish / Colour
①	Body	ABS	White, Black
②	Knob	Brass	Nickel
③	Bolt	ABS	White, Black
④	Tube	Brass	Nickel
⑤	Yoke	Steel (SS)	Clear Zinc Chromate
⑥	Magnet	Ferrite	—
⑦	Counter Plate W12	Steel (SUM)	Nickel

RoHS	CAD	Item Code	Item Name	Colour	Magnetic Force N	Magnetic Force kgf	Weight (g)	Box (pcs)	Carton (pcs)
—	SD	140-021-954	MC-125WTP	White	24.5	2.5	14.5	20	1000
—	SD	140-021-955	MC-125BLP	Black				20	1000

Refer to 1 : P.607, 2 : P.639

MAGNETIC CATCH MC800

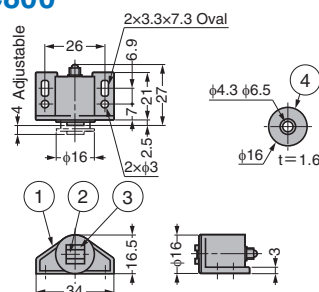

- Yoke position adjustable 4mm back and forward.

[Remarks]

- Be sure to read the "Cautions" 1.

[Parts Included]

- Counter plate

No.	Part Name	Material	Finish / Colour
①	Body	PP	Brown
②	Magnet	Ferrite	—
③	Yoke	Steel (SPCC)	Bronze
④	Counter Plate	—	—

RoHS	CAD	Item Code	Item Name	Magnetic Force N	Magnetic Force kgf	Weight (g)	Box (pcs)	Carton (pcs)
—	SD	140-058-048	MC800	19.6	2	8	100	1000

Refer to 1 : P.607