

FULL EXTENSION SOFT-CLOSE SLIDE 4670 Gold Finish

INSTRUCTION

Self and Soft Closing



- Gold-plated version of the 4670 slide.
- Full extension (3 members).
- Slides smoothly even if cabinet is slightly deformed due to shock absorbing effect of the outer member.
- The drawer can be detached by lifting the lever.

[Specification]

- Self and soft closing position:
 - 300-350 type: 20 mm distance from closed position
 - 400-500 type: 36 mm distance from closed position
- The maximum width of the drawer is the slide length + 200mm.

[Remarks]

- Do not push with a strong force to prevent oil leakage when soft-closing mechanism is in operation.
- Scratches on gold plating may become conspicuous. Please handle it with care during installation.

[Parts Included]

- Truss head tapping screw 4 x 12 (Gold plating)

Application



Self and Soft Closing

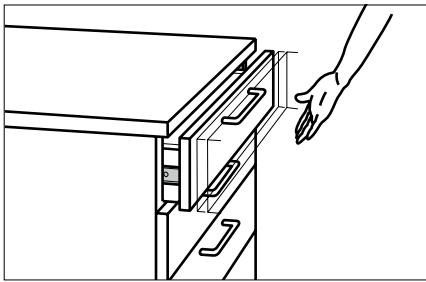

Full Extension (3 Members)

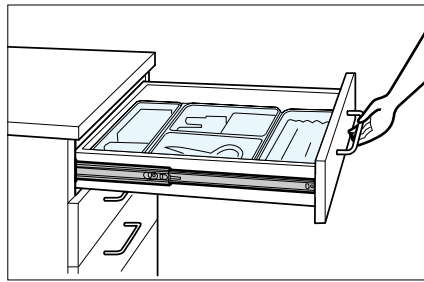

Easy to Detach

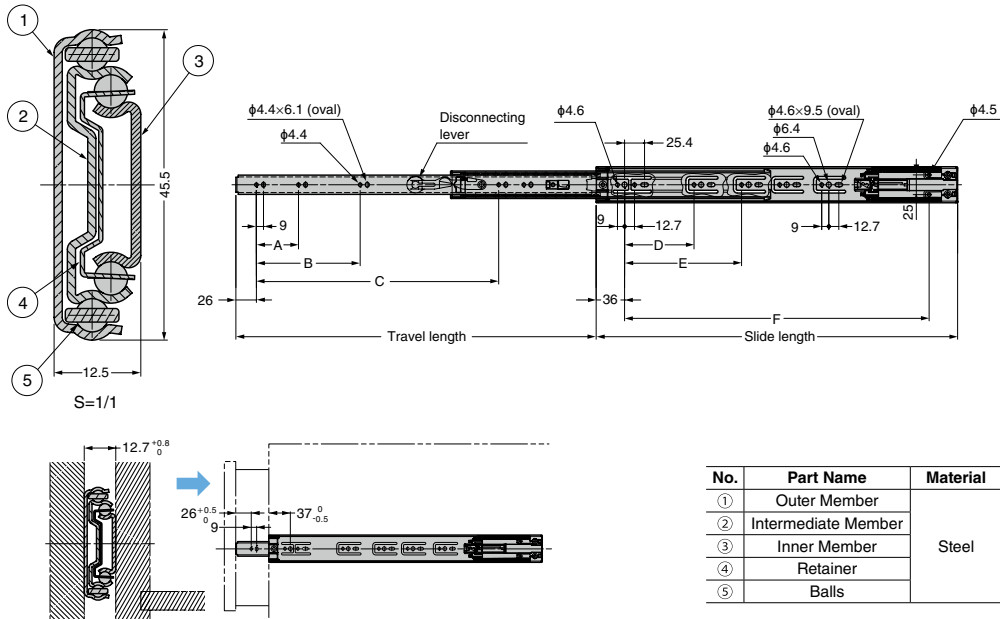
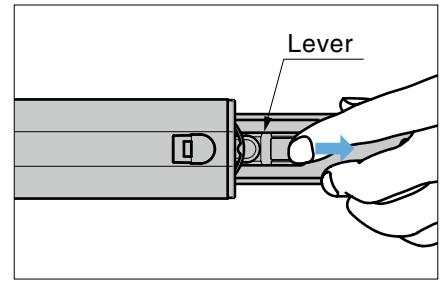

No.	Part Name	Material	Finish / Colour
①	Outer Member	Steel	Gold Plating
②	Intermediate Member		
③	Inner Member		(Zinc Chromate Steel)
④	Retainer		
⑤	Balls		

Sold in pairs (2 pcs)

RoHS	CAD	Item Code	Item Name	Slide Length	Travel Length	A	B	C	D	E	F	Load Capacity / pair		Weight / pair (g)	Box (set)
												N	kgf		
-	●	190-037-617	4670-300GA	300	275	-	-	174	-	-	229	196	20	850	10
-	●	190-037-618	4670-350GA	350	353	96	-	224	119	183	279	245	25	990	10
-	●	190-037-619	4670-400GA	400	404			254		199	329			1130	10
-	●	190-037-620	4670-450GA	450	455			128		247	379			294	30
-	●	190-037-621	4670-500GA	500	505	96	160	344	-	295	429	343	35	1440	10