

BUTT HINGE HG-P100



- PVC material, with excellent chemical resistance.
- No metal powder generated because all parts (except shaft) are made of resin.
- Clear type does not affect appearance even on transparent door.
- Lead-free.

[Applications]

- Semiconductor manufacturing equipment, liquid crystal manufacturing equipment, etc.

[Remarks]

- Screw may become loose, depending on use situation. Please check appropriately.
- Use washers when fixing with screws.
- When installing to aluminium frame, over-tightening may damage mounting screws.
- Load capacity is the value when using two hinges. For calculation conditions, please refer to INDEX 1.

[Recommended Screws]

- M5 screw (Recommended tightening torque 2.0N · m)

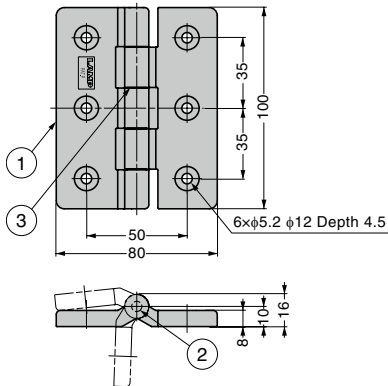

No.	Part Name	Material	Finish / Colour
①	Leaf	PVC	Clear
②	Shaft	Titanium Alloy	Plain
③	Washer	PEEK	—

Reference door weight: 8kg
(In case of door size W600×H800, using 2 pcs vertically)

RHS	CAD	Item Code	Item Name	Load Capacity N/2 pcs	Load Capacity kgf/2 pcs	Weight (g)	Box (pcs)	Carton (pcs)
		170-020-836	HG-P100	98	10	74	30	240

Refer to 1 : P.15

BUTT HINGE FOR ALUMINIUM FRAME AS-HG-IS

SUS



- Can be installed to aluminium frame.
- All parts made of polished stainless steel.

[Remarks]

- Load capacity is the value when using two hinges. For calculation conditions, please refer to INDEX 1.

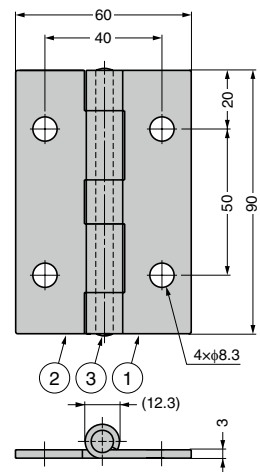
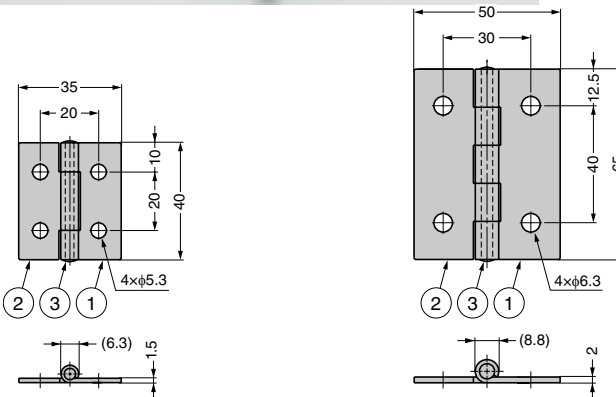

RHS	CAD	Item Code	Item Name	Load Capacity N/2 pcs	Load Capacity kgf/2 pcs	Weight (g)	Box (pcs)	Carton (pcs)
		170-098-116	AS-HG-IS40	69	7	21	400	—
		170-098-117	AS-HG-IS65	157	16	99	50	200
		170-098-118	AS-HG-IS90	333	34	169	10	80

Refer to 1 : P.15

No.	Part Name	Material	Finish
①	Body 1	Stainless Steel (SUS304)	Mirror
②	Body 2		
③	Shaft		—