

FOLDING POCKET DOOR SYSTEM (INSET)



ALT-F



WARDROBE & CABINET DOOR HARDWARE

	2 rail system	3 rail system
Door Width	Max. 450 mm	
Door Height	Max. 1830 mm	1831 - 2400 mm
Door Thickness	23 - 30 mm	
Door Weight	Max. 10 kg/Door	

Features

- Combines folding doors for wider door spaces.
- Folding doors retract into cabinet interior, full access (besides pocket) to the interior.
- Great solution for home and residential in-suite storage including laundry rooms.
- Max door width: 450mm per door. 2 doors per folding side. Total 1800mm wide cabinet entrance.

Installation

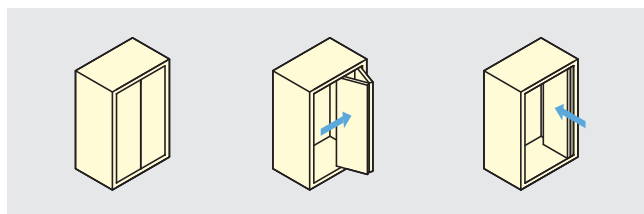
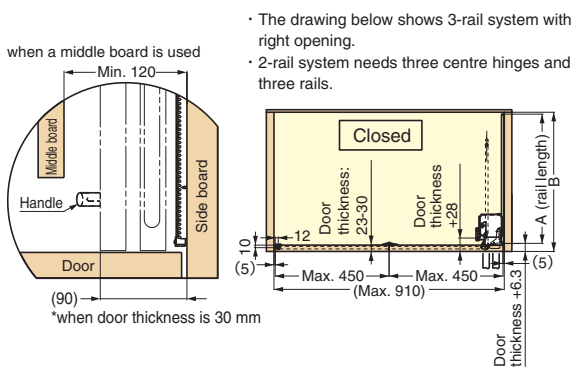

Top View

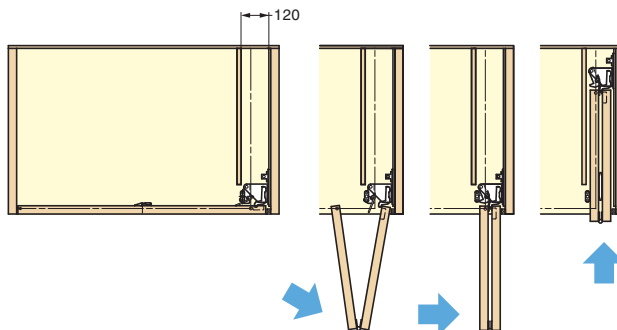

Rail Dimensions

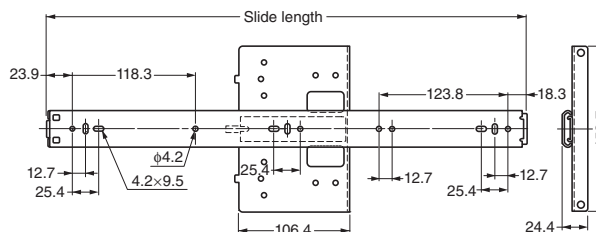

FOLDING POCKET DOOR SYSTEM (INSET)

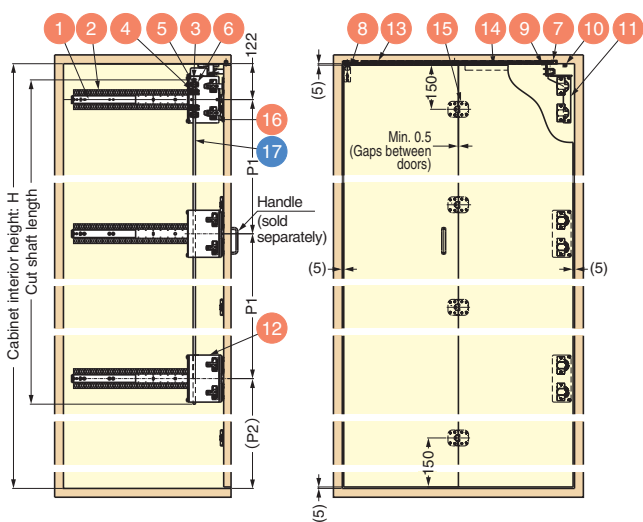

	2 rail system	3 rail system	
Door height	Max. 1830	1831~1903	1904~2400
Cabinet interior height	Max. 1840	1841~1913	1914~2410
Cut shaft length	H-110		1803
P1	H-250	(H-250)/2	831
(P2)	128		H-1784

Item Name	Rails	Opening	Rail Length	Door Storing	Cabinet Depth
ALT-F18LV2	2	Left Opening	460.4	355.6	466.7 + Door Thickness
ALT-F18RV2		Right Opening			
ALT-F20LV2	2	Left Opening	511.2	406.4	517.5 + Door Thickness
ALT-F20RV2		Right Opening			
ALT-F18LV3	3	Left Opening	460.4	355.6	466.7 + Door Thickness
ALT-F18RV3		Right Opening			
ALT-F20LV3		Left Opening	511.2	406.4	517.5 + Door Thickness
ALT-F20RV3	3	Right Opening			



Parts Set		Necessary Parts		
Please refer to "Qty [a] - [h]" for parts included in each set.				
Set Name		Item Code	Item Name	
a	2 Rail System	Left Opening (Door Storing 355.6)	180-035-215	ALT-F18LV2
		Right Opening (Door Storing 355.6)	180-035-216	ALT-F18RV2
		Left Opening (Door Storing 406.4)	180-035-217	ALT-F20LV2
		Right Opening (Door Storing 406.4)	180-035-218	ALT-F20RV2
e	3 Rail System	Left Opening (Door Storing 355.6)	180-034-370	ALT-F18LV3
		Right Opening (Door Storing 355.6)	180-034-371	ALT-F18RV3
		Left Opening (Door Storing 406.4)	180-034-372	ALT-F20LV3
		Right Opening (Door Storing 406.4)	180-034-373	ALT-F20RV3

Parts Included

No.	Qty			Part Name	Dimensions	Description
	a	b	e, f			
1	2 pcs	3 pcs		Rail	See P.614	<ul style="list-style-type: none"> Material Steel Finish Black Chromate
2	2 pcs	3 pcs		Rack		<ul style="list-style-type: none"> Material ABS Finish Black
3	1 pc	1 pc		Cap		<ul style="list-style-type: none"> Material Steel Finish Black Chromate
4	4 pcs	6 pcs		Gear		<ul style="list-style-type: none"> Material POM Finish Black
5	4 pcs	6 pcs		Bush		<ul style="list-style-type: none"> Material POM Finish Black
6	4 pcs	6 pcs		Stationary Block		<ul style="list-style-type: none"> Material POM Finish Black Screw : Binding Head Self Tapping Screw UNC8-32
7	1 pc	1 pc		Upper Rail Joint		<ul style="list-style-type: none"> Material POM Finish White
8	1 pc	1 pc		End Guide		<ul style="list-style-type: none"> Material Steel (SPCC) / POM Finish Yellow Zinc Chromate / Natural
9	1 pc	1 pc		Angle Stopper		<ul style="list-style-type: none"> Material Steel (SPCC) Finish Nickel

No.	Qty			Part Name	Dimensions	Description
	a	b	e, f			
10	1 pc	1 pc		Inner Guide		<ul style="list-style-type: none"> Material POM Finish White
11	1 pc	1 pc		Interlock		<ul style="list-style-type: none"> Material Steel / POM Finish Black / White Right type shown.
12	1 pc	2 pcs		Hinge Cover Bracket		<ul style="list-style-type: none"> Material Steel (SPCC) Finish Black Paint
13	1 pc	1 pc		Upper Rail (1820 mm)		<ul style="list-style-type: none"> Material Aluminium Finish Anodized Silver Bore Pitch : Approx. 300 mm Pitch End : Approx. 30 mm
14	1 pc	1 pc		Bottom Guide Rail (1500 mm)		<ul style="list-style-type: none"> Material Aluminium Finish Anodized Silver
15	3 pcs	4 pcs		Centre Hinge		<ul style="list-style-type: none"> Material Steel Finish Black Screw : Countersunk Head Tapping Screw 3.5x16
16	4 pcs	6 pcs		Hinge Set		Item Code : 180-026-432 Item Name : ALT-F-8086HKEZX <ul style="list-style-type: none"> Material Steel / Zinc Alloy Finish Yellow Zinc Chromate / Black
Included Screws	8 pcs	12 pcs		Cross-recessed pan head tapping screw 4x20 (for ⑥)		
	18 pcs	27 pcs		Cross-recessed truss head tapping screw 4x20 (for ①)		
	8 pcs	8 pcs		Cross-recessed countersunk screw 4x20 (for ⑦⑩⑭)		
	4 pcs	6 pcs		Cross-recessed pan head screw M6x8 (for ⑪⑫)		
	2 pcs	2 pcs		Cross-recessed binding head tapping screw 4.5x20 (for ⑨)		
	2 pcs	2 pcs		Hexagon head tapping screw with flange 4x16 (for ⑧)		
	2 pcs	2 pcs		Spring washer 4 (for ⑧)		
	10 pcs	10 pcs		Cross-recessed countersunk tapping screw 3.5x16 head diameter 6 (for ⑬)		
8 pcs	12 pcs		Cross-recessed countersunk tapping screw 3.5x20 (for ⑮)			

Shaft		Necessary Parts				
1 pc is necessary for a pair of doors.						
No.	Length	Qty	Item Code	Part Name	Dimensions	Description
17	902±13 mm	1 pc	180-121-047	Shaft		<ul style="list-style-type: none"> Material Steel Finish Black Chromate
	1207±13 mm	1 pc	180-121-048			
	1816±13 mm	1 pc	180-121-049			
			Item Name 29475-36			
			Item Name 29475-48			
			Item Name 29475-72			