

## HINGE INSTALLATION JIG HES3D-120-JIG



- Specially designed for the HES3D-120 , 3-way adjustable concealed hinge.
- Keeps hinge angle at 90° for easy installation.

**[Remarks]**

- Please do not open or close the hinge while the jig is attached.  
This may cause unintentional damage to the hinge and the door.

**[How to Use]**

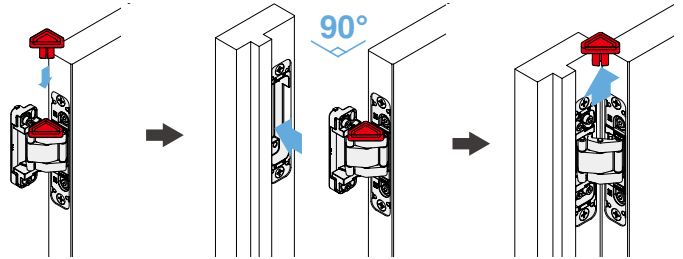

\*Please do not detach the jig until the hinge is installed.

Sold in sets of three pieces.

RoHS	CAD	Item Code	Item Name	Material	Colour	Weight (g)
		170-044-186	HES3D-120-JIG	POM	Red	4

Refer to : No.240A P.471