

Compact ejector

SCPi-FS 15 NO RP M12-5

Part no.:10.02.02.05436

<https://www.schmalz.com/10.02.02.05436>

Homepage > Vacuum Technology for Automation > Vacuum Components > Vacuum Generators > Compact Ejectors > Compact Ejectors SCPb / SCPi FS RP > SCPi-FS 15 NO RP M12-5

Compact ejector



Nozzle size: 1,5 mm
 Suction rate (max): 75 l/min
 Air consumption (during evac.):
 115 l/min
 Noise level (free): 76 dB
 at operating press.: 4.0 ... 7.0 bar
 Vacuum (max): -850 mbar
 Control: Normally open
 Design: Pneumatic control
 Electrical connection:
 Male connect M12, 5 pol
 Switching point: - 550 mbar
 Switching point 2: - 680 mbar
 Switch-on value regulation: -630 mbar
 Protection: IP 65 (with plug)

Design Data

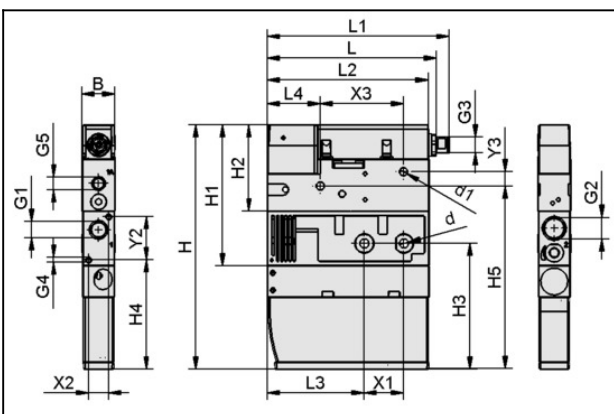

Attribute	Value
B	22.8 mm
d	6.4 mm
d1	5.5 mm
G1	G1/4"-F
G2	G3/8"-F
G3	M12x1-M
G4	M4-F
G5	G1/8"-F
H	170 mm

Contact to Schmalz

J. Schmalz GmbH | Johannes-Schmalz-Straße, 72293 Glatten, Deutschland | +49 7443 2403-102 | customercenter@schmalz.de

Compact ejector

SCPi-FS 15 NO RP M12-5

Part no.:10.02.02.05436

<https://www.schmalz.com/10.02.02.05436>



Attribute	Value
H1	98 mm
H2	60 mm
H3	87.5 mm
H4	76 mm
H5	127.5 mm
L	118 mm
L1	126.5 mm
L2	112.5 mm
L3	67.5 mm
L4	36.75 mm
X1	27.5 mm
X2	14 mm
X3	58 mm
Y2	30 mm
Y3	10 mm

Technical Data

Attribute	Value
Nozzle diameter	1.5 mm
Suction rate (max.)	75 l/min
Suction rate (max.)	4.5 m ³ /h
Suction rate (max.)	2.648 cfm
Max. vacuum	-25.1 inHg
Degree of evacuation	85 %
Air consumption suction	115 l/min

Contact to Schmalz

J. Schmalz GmbH | Johannes-Schmalz-Straße, 72293 Glatten, Deutschland | +49 7443 2403-102 | customercenter@schmalz.de

Compact ejector

SCPi-FS 15 NO RP M12-5

Part no.:10.02.02.05436

<https://www.schmalz.com/10.02.02.05436>



Attribute	Value
Air consumption suction	6.9 m³/h
Air consumption suction	4.061 cfm
Max. air consumption blow off	310 l/min
Air consumption blow off	10.947 cfm
Pressure range (operating pressure)	4.0 ... 7.0 bar
Pressure range (operating pressure)	58.0 ... 101.5
Recomm. internal hose diameter compressed air	6 mm
Recomm. internal hose diameter vacuum	6 mm
Sound level free	76 dB(A)
Control valve	Normally open
Weight	0.615 kg
Operating temperature	0 ... 50 °C
Product family	SCPi

Spare Parts



SD 111x21x45 SMPi/SCPi

Part no.10.02.02.03381

Silencer for vacuum generators

Length L: 111 mm

Width B: 21 mm

Height H: 45 mm

for: Compact ejectors SMPi/SCPi

Accessories

Contact to Schmalz

J. Schmalz GmbH | Johannes-Schmalz-Straße, 72293 Glatten, Deutschland | +49 7443 2403-102 | customercenter@schmalz.de

Compact ejector

SCPi-FS 15 NO RP M12-5

Part no.:10.02.02.05436

<https://www.schmalz.com/10.02.02.05436>



ASK B-M12-5 5000 K-5P

Part no.21.04.05.00080

Connection cable

Interface Connection 1:

Fem connect M12, 5 pol

Cable length: 5000 mm

Interface Connection 2: Cable 5

Material: PUR-Cable

Shape: Straight



ASK B-M12-5 1000 S-M12-5

Part no.21.04.05.00158

Connection cable

Interface Connection 1:

Fem connect M12, 5 pol

Cable length: 1000 mm

Interface Connection 2:

Male connect M12, 5 pol

Material: PUR-Cable