

## DOWEL

TEST  
METHOD 9

SS-318



## Installation

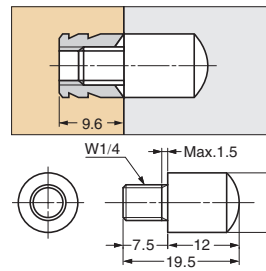

## Recommended Mounting Hole

φ10

Item Code	Item Name	Material	Finish	Load Capacity		Weight	Box
120-041-334	SS-318M (Dowel)	Brass	Nickel	294 N/4 pcs	30 kgf/4 pcs	8.8 g	500 pcs
120-041-335	SS-318W (Catch)	Brass	Nickel	294 N/4 pcs	30 kgf/4 pcs	3.3 g	1000 pcs

## DOWEL

TEST  
METHOD 9

SS-322



## Installation

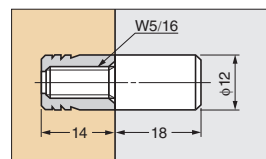

## Recommended Mounting Hole

φ12

Item Code	Item Name	Material	Finish	Load Capacity		Weight	Box	Carton
120-041-356	SS-322M (Dowel)	Brass	Nickel	441 N/4 pcs	45 kgf/4 pcs	20 g	200 pcs	800 pcs
120-041-357	SS-322W (Catch)	Brass	Nickel	441 N/4 pcs	45 kgf/4 pcs	7.5 g	500 pcs	2500 pcs

## DOWEL

TEST  
METHOD 9

SS-320

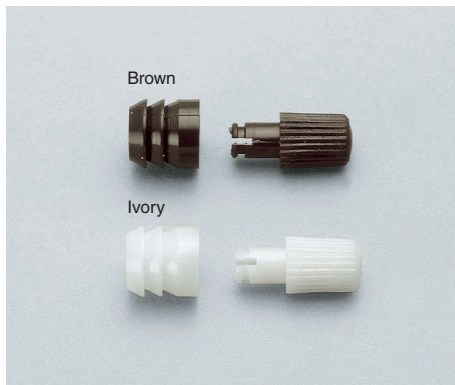

## Installation

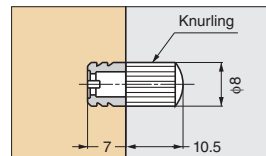

## Features

- One touch easy detachment

## Recommended Mounting Hole

φ8

## Remarks

Dowel: 1 pack includes 1,000 pieces

Catch: 1 pack includes 2,000 pieces

Item Code	Item Name	Material	Colour	Load Capacity		Weight	Box	Carton
120-038-202	SS-320IM-P1000 (Dowel)	ABS	Ivory	98 N/4 pcs	10 kgf/4 pcs	0.6 g	1 pack	20 packs
120-038-203	SS-320IW-P2000 (Catch)	ABS	Ivory	98 N/4 pcs	10 kgf/4 pcs	0.2 g	1 pack	20 packs
120-038-200	SS-320BRM-P1000 (Dowel)	ABS	Brown	98 N/4 pcs	10 kgf/4 pcs	0.6 g	1 pack	20 packs
120-038-201	SS-320BRW-P2000 (Catch)	ABS	Brown	98 N/4 pcs	10 kgf/4 pcs	0.2 g	1 pack	20 packs

## DOWEL

TEST  
METHOD 9

SS-321

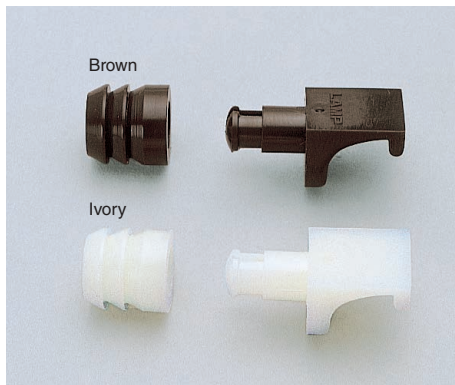

## Installation

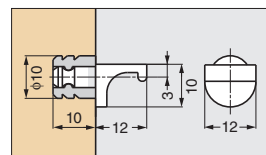

## Features

- One touch easy detachment

## Recommended Mounting Hole

φ10

## Remarks

Dowel: 1 pack includes 500 pieces

Catch: 1 pack includes 1,000 pieces

Item Code	Item Name	Material	Colour	Load Capacity		Weight	Box	Carton
120-038-206	SS-321IM-P500 (Dowel)	ABS	Ivory	196 N/4 pcs	20 kgf/4 pcs	1.0 g	1 pack	20 packs
120-038-207	SS-321IW-P1000 (Catch)	ABS	Ivory	196 N/4 pcs	20 kgf/4 pcs	0.4 g	1 pack	20 packs
120-038-204	SS-321BRM-P500 (Dowel)	ABS	Brown	196 N/4 pcs	20 kgf/4 pcs	1.0 g	1 pack	20 packs
120-038-205	SS-321BRW-P1000 (Catch)	ABS	Brown	196 N/4 pcs	20 kgf/4 pcs	0.4 g	1 pack	20 packs