

STAINLESS STEEL HANDLE



XL-CUR



Features

Exquisite combination of satin and mirror finishes

Parts Included

Truss head screw M5x25

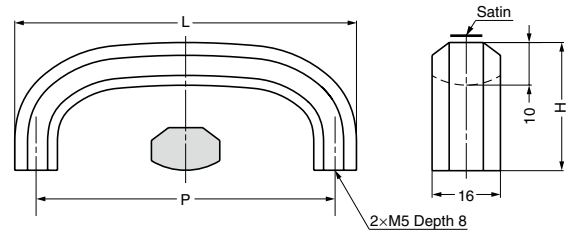

Item Code	Item Name	Material	Finish	L	H	P	Weight	Box	Carton
100-012-825	XL-CUR 80TT	Stainless Steel (SUS303)	Mirror and Satin Combination	80	30	70	115 g	10 pcs	150 pcs
100-012-826	XL-CUR100TT	Stainless Steel (SUS303)	Mirror and Satin Combination	100	32	90	137 g	10 pcs	150 pcs
100-012-827	XL-CUR120TT	Stainless Steel (SUS303)	Mirror and Satin Combination	120	34	110	160 g	10 pcs	100 pcs
100-012-828	XL-CUR150TT	Stainless Steel (SUS303)	Mirror and Satin Combination	150	36	140	196 g	5 pcs	75 pcs

STAINLESS STEEL HANDLE



DL-SUS304



Parts Included

Truss head screw M4x28 (SUS)

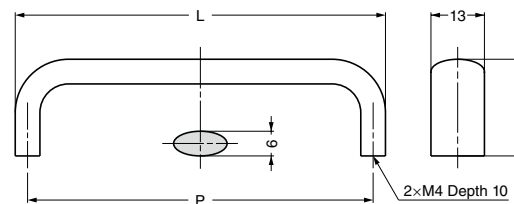

Item Code	Item Name	Material	Finish	L	H	P	Weight	Box	Carton
100-904-563	DL- 70S-SUS304	Stainless Steel (SUS304)	Satin	70	23	64	51 g	20 pcs	200 pcs
100-904-562	DL- 70M-SUS304	Stainless Steel (SUS304)	Mirror	70	23	64	51 g	20 pcs	200 pcs
100-904-565	DL- 90S-SUS304	Stainless Steel (SUS304)	Satin	90	23.5	84	61 g	20 pcs	200 pcs
100-904-564	DL- 90M-SUS304	Stainless Steel (SUS304)	Mirror	90	23.5	84	61 g	20 pcs	200 pcs
100-904-567	DL-110S-SUS304	Stainless Steel (SUS304)	Satin	110	24	104	73 g	15 pcs	150 pcs
100-904-566	DL-110M-SUS304	Stainless Steel (SUS304)	Mirror	110	24	104	73 g	15 pcs	150 pcs
100-904-569	DL-130S-SUS304	Stainless Steel (SUS304)	Satin	130	24.5	124	83 g	15 pcs	150 pcs
100-904-568	DL-130M-SUS304	Stainless Steel (SUS304)	Mirror	130	24.5	124	83 g	15 pcs	150 pcs
100-904-571	DL-150S-SUS304	Stainless Steel (SUS304)	Satin	150	25	144	93 g	15 pcs	150 pcs
100-904-570	DL-150M-SUS304	Stainless Steel (SUS304)	Mirror	150	25	144	93 g	15 pcs	150 pcs