

LEVELLING GLIDE AD-502-P

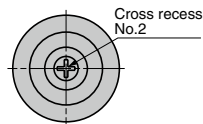
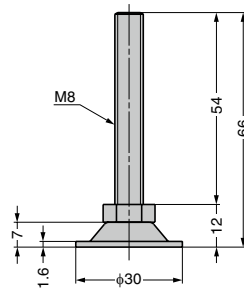
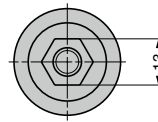

[Base]

LOAD CAPACITY 2744 N

TEST METHOD 14

- Cross-recessed bottom allows easy installation with electric screwdriver.
- Cover **1** installed at the bottom to prevent from scratching the floor available.

[Sold Separately]

- Wrench for AD-502: AD-502-SP

[Wrench for AD-502: AD-502-SP] Sold Separately

RoHS	CAD	Item Code	Item Name	Material	Finish	Weight (g)	Box (pcs)	Carton (pcs)
-	-	200-936-204	AD-502-SP	Steel	Coloured Zinc Chromate	14	1	-

[Body]

RoHS	CAD	Item Code	Item Name	Material	Finish	Load Capacity N/pc	Load Capacity kgf/pc	Weight (g)	Box (pcs)	Carton (pcs)
		200-024-440	AD-502P	Steel	Coloured Zinc Chromate (Trivalent)	2744	280	30	100	400
		200-024-441	AD-502P-BZC		Black Chromate (Trivalent)				100	400

 Refer to **1** : P.831

LEVELLING GLIDE AD-502

LOAD CAPACITY 2744 N

TEST METHOD 14

- Cover **1** installed at the bottom to prevent from scratching the floor available.

[Sold Separately]

- Wrench for AD-502: AD-502-SP

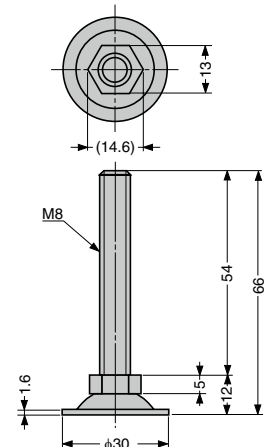
[Wrench for AD-502: AD-502-SP] Sold Separately

RoHS	CAD	Item Code	Item Name	Material	Finish	Weight (g)	Box (pcs)	Carton (pcs)
-	-	200-936-204	AD-502-SP	Steel	Coloured Zinc Chromate	14	250	1000

[Body]

RoHS	CAD	Item Code	Item Name	Material	Finish	Load Capacity N/pc	Load Capacity kgf/pc	Weight (g)	Box (pcs)	Carton (pcs)
		200-140-059	AD-502	Steel	Coloured Zinc Chromate (Trivalent)	2744	280	30	100	400
-		200-149-237	AD-502BZC		Black Chromate				100	400

 Refer to **1** : P.831