

SLIDING DOOR ROLLER **JC140** Flat Type w/ Bracket

Made to Order

**LOAD CAPACITY****3430~24500 N**

- For wheel diameter above  $\phi 75$ , bearing with rubber seal (dustproof seal type) provides excellent water resistance.
- Ideal for exterior application.
- 2 bearings are used for wheel diameter above  $\phi 75$ , providing smooth movement even for heavy doors.
- Gap between bracket and wheel absorbs deformation and allows for smooth movement.

**[Applications]**

- Gates, etc.

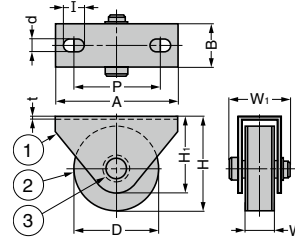

No.	Part Name	Material	Finish
①	Bracket	Steel (SPHC)	Clear Zinc Chromate
②	Wheel	Ductile Cast Iron	Black Enamel Finish
③	Bearing	-	-

RoHS	CAD	Item Code	Item Name	D	W	W <sub>1</sub>	H	H <sub>1</sub>	A	B	d	l	P	t	Load Capacity N/2 pcs	Load Capacity kgf/2 pcs	Weight (kg)	Box (pcs)	Carton (pcs)
-	SD	200-024-817	JC140-50F	50	20	41	64	60	100	33	11	70			3430	350	0.5	1	30
-	SD	200-024-818	JC140-60F	60			67	58		38					4410	450	0.7	1	30
G	SD	200-024-819	JC140-75F	75	26	46	88	76.5	120	37	11	94	3.2		5880	600	1.1	1	20
G	SD	200-024-820	JC140-90F	90			95.5					15			6860	700	1.4	1	20
G	SD	200-024-821	JC140-100F	105	28	50	118	93.5	145	39.5		115			7840	800	2	1	20
G	SD	200-024-822	JC140-120F	120			125.5								9800	1000	2.2	1	16
G	SD	200-024-823	JC140-150F	150	43	88	165	137	250	60	20	35	185	6	19600	2000	7	1	4
G	SD	200-024-824	JC140-200F	200	50	105	215	160	290	70		35	216	6	24500	2500	12.5	1	2

SLIDING DOOR ROLLER **JC150** Flat Type w/o Bracket

Made to Order



- Non-bracket type of JC140 **1**.
- For wheel diameter above  $\phi 75$ , bearing with rubber seal (dustproof seal type) provides excellent water resistance.
- Ideal for exterior application.
- 2 bearings are used for wheel diameter above  $\phi 75$ , providing smooth movement even for heavy doors.

**[Applications]**

- Gates, etc.

**[Remarks]**

- Core rod for wheel diameter  $\phi 50 \sim \phi 120$  is not grooved for E-ring. Core rod for  $\phi 150 \sim \phi 200$  consists of one bolt and one nut.
- The shape of core rod varies depending on its size. Please confirm with the figure below.

**[Parts Included]**

- Wheel shaft

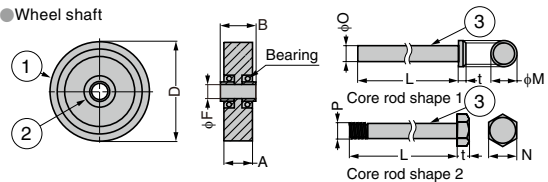

No.	Part Name	Material	Finish
①	Wheel	Ductile Cast Iron	Black Enamel Finish
②	Bearing	-	-
③	Core Rod	Steel (SWCH)	-

RoHS	CAD	Item Code	Item Name	D	A	B	F	L	M	N	O	P	t	Weight (kg)	Core Rod Shape	Box (pcs)	Carton (pcs)
-	SD	200-024-825	JC150-50F	50	20	25								0.3	1	1	40
-	SD	200-024-826	JC150-60F	60		30								0.4		1	40
G	SD	200-024-827	JC150-75F	75	26	29	13	75	19	-	12.9		4	0.7		1	20
G	SD	200-024-828	JC150-90F	90										1		1	20
G	SD	200-024-829	JC150-100F	105	28	32	16		24		15.9		5	1.3	1	20	
G	SD	200-024-830	JC150-120F	120										1.6	1	20	
-	SD	200-024-831	JC150-150F	150	43	48	20	100	-	30		M20	13	4.2	2	1	4
-	SD	200-024-832	JC150-200F	200	50	58	24	120	-	36		M24	15	8.5		1	2

Refer to **1** : P.799