

TWIN WHEEL CASTER (PLATE TYPE)

BU-25P



Features

Wheels are coated in polyurethane which absorbs vibration, gives an extra smooth and quiet ride. Also, unlikely to slip.

Cross-section Drawing

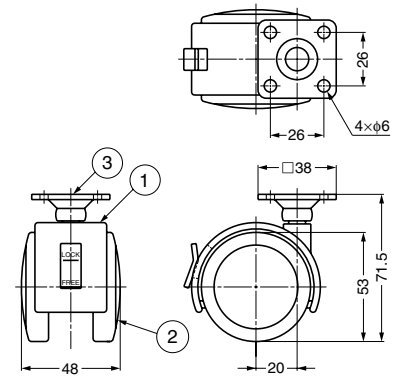
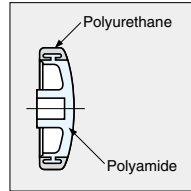

Item Code	Item Name	Type	Load Capacity N	Load Capacity kgf	Weight	Carton
200-132-047	BU-25PS	With Brake	392 N	40 kgf	157 g	120 pcs
200-132-040	BU-25P	Without Brake	392 N	40 kgf	150 g	120 pcs

No.	Part Name	Material	Finish/Colour
①	Body	Polyamide (PA)	Black
②	Wheel	Polyamide (PA)	Black
②	Wheel	Polyurethane (PUR)	Black
③	Plate	Steel	Clear Zinc Chromate

TWIN WHEEL CASTER (THREADED BOLT TYPE)

BU-25N



Features

Wheels are coated in polyurethane which absorbs vibration and gives an extra smooth and quiet ride. Also, unlikely to slip.

Cross-section Drawing

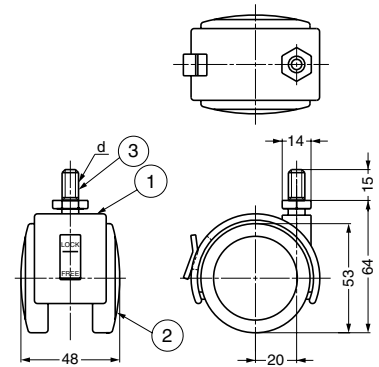
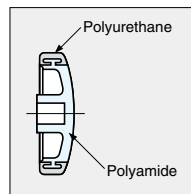

Item Code	Item Name	Type	d	Load Capacity N	Load Capacity kgf	Weight	Carton
200-132-045	BU-25N8S	With Brake	M8	392 N	40 kgf	125 g	150 pcs
200-132-042	BU-25N8	Without Brake	M8	392 N	40 kgf	118 g	150 pcs
200-132-046	BU-25N3S	With Brake	W3/8	392 N	40 kgf	126 g	150 pcs
200-132-043	BU-25N3	Without Brake	W3/8	392 N	40 kgf	119 g	150 pcs

No.	Part Name	Material	Finish/Colour
①	Body	Polyamide (PA)	Black
②	Wheel	Polyamide (PA)	Black
②	Wheel	Polyurethane (PUR)	Black
③	Threaded Bolt	Steel	Clear Zinc Chromate

TWIN WHEEL CASTER (INSERT BOLT TYPE)

BU-25S



Features

Wheels are coated in polyurethane which absorbs vibration and gives an extra smooth and quiet ride. Also, unlikely to slip.

Parts Included

Socket

Cross-section Drawing

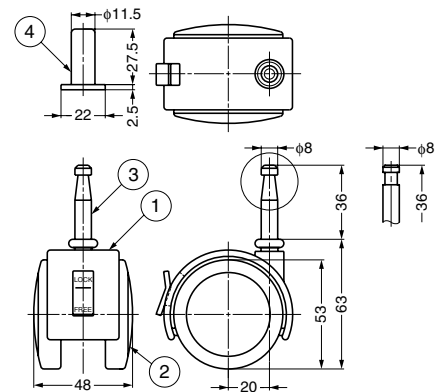
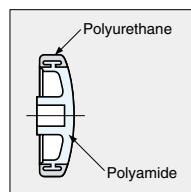

Item Code	Item Name	Type	Load Capacity N	Load Capacity kgf	Weight	Carton
200-132-048	BU-25SS	With Brake	392 N	40 kgf	132 g	140 pcs
200-132-044	BU-25S	Without Brake	392 N	40 kgf	125 g	140 pcs

No.	Part Name	Material	Finish/Colour
①	Body	Polyamide (PA)	Black
②	Wheel	Polyamide (PA)	Black
②	Wheel	Polyurethane (PUR)	Black
③	Insert Bolt	Steel	Clear Zinc Chromate
④	Socket	Polyethylene (PE)	-