

MILLION LOCK PUSH LOCK 2300M



- For wooden double sliding doors. Can also be used for metal-framed glass doors and sheet metal double sliding doors when mounting plate is removed.
- 1 million key changes available. Master Key system available at surcharge. (Max. 2,520 key changes/Master Key.)
- Keys can be shared with Million Lock Series 1.

[Remarks]

- Be sure to read the "Cautions" 2.

[Parts Included]

- Countersunk head wood screw 2.7 × 16 (SUS)

[Lock]

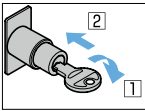

Turn key 90° to the right, push in.

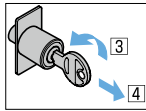

Turn key 90° to the left, and remove.

[Installation]

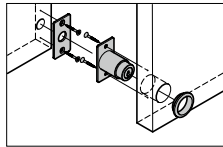

[Unlock]

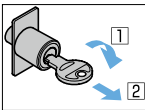

Turn key 90° to the right and lock will automatically disengage.

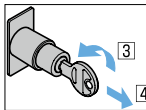

Turn the key 90° back and remove.

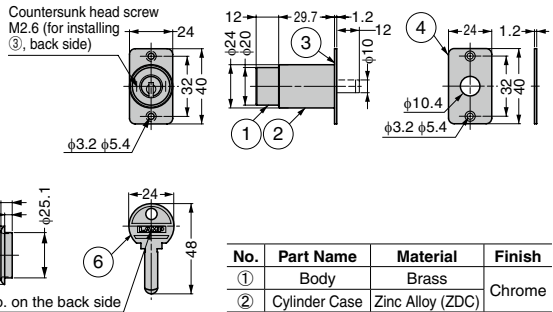

No.	Part Name	Material	Finish
①	Body	Brass	Chrome
②	Cylinder Case	Zinc Alloy (ZDC)	Chrome
③	Mounting Plate	Stainless Steel	Barrel
④	Strike	(SUS304)	Polished
⑤	Ring	Brass	Chrome
⑥	Key		Nickel

RoHS	CAD	Item Code	Item Name	Key Type	Cylinder Diameter	Door Thickness	Weight (g)	Box (pcs)	Carton (pcs)
-	3D	150-022-924	2300M-B	Key Different	16	30	100	12	60
-	3D	150-001-232	2300M-D	Key Alike				12	60

Refer to 1 : P.719, 2 : P.718

PUSH LOCK 2110M 2100 Lock Series



- Ideal for wooden double sliding doors. 2100M 1 of the same type without need of key also available.
- To Lock: Insert key and turn 60° clockwise. Push-in the cylinder with key and turn 60° back.
- To Unlock: Insert the key and turn 60° clockwise. Turn the key 60° back and remove.
- 12 key changes available.
- Keys can be shared with 2100 Lock Series 2.

[Remarks]

- Be sure to read the "Cautions" 3.

[Installation]

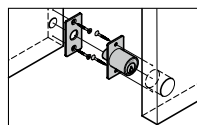

[Parts Included]

- Countersunk head wood screw 2.7 × 16

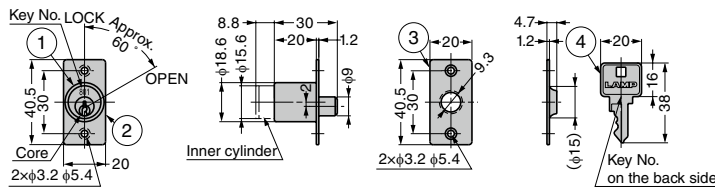

No.	Part Name	Material	Finish
①	Body	Zinc Alloy (ZDC)	Satin Nickel (Core: Buffing Nickel Coating)
②	Mounting Plate	Brass	Nickel
③	Strike		
④	Key		
-	Key Ring	Steel	

RoHS	CAD	Item Code	Item Name	Key Type	Cylinder Diameter	Door Thickness	Weight (g)	Box (pcs)	Carton (pcs)
G	3D	150-060-889	2110M-B	Key Different	18.6	20	60	12	240
G	-	150-001-045	2110M-D	Key Alike				12	240

Refer to 1 : P.736, 2 : P.719, 3 : P.718