

Caratteristiche: PIASTRINE INOX A SALDARE

Features: ST STEEL WELDING PLATES

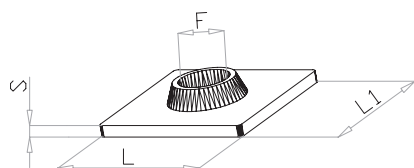

CODICE - CODE	L	L1	S	F
PI17489	35	35	3	M12
PI17490	35	35	3	M16
PI17491	35	35	3	M20
PI17499	40	40	3	M12
PI17500	40	40	3	M16
PI17501	40	40	3	M20
PI17509	50	50	3	M12
PI17510	50	50	3	M16
PI17511	50	50	3	M20
PI17519	60	60	3	M12
PI17520	60	60	3	M16
PI17521	60	60	3	M20
PI17529	60	40	3	M12
PI17530	60	40	3	M16
PI17531	60	40	3	M20
PI17539	80	40	3	M12
PI17540	80	40	3	M16
PI17541	80	40	3	M20
PI17549	100	40	3	M12
PI17550	100	40	3	M16
PI17551	100	40	3	M20
PI17559	100	50	3	M12
PI17560	100	50	3	M16
PI17561	100	50	3	M20

PIASTRINA IN INOX A SALDARE TONDA
ROUND STAINLESS STEEL WELDING PLATE

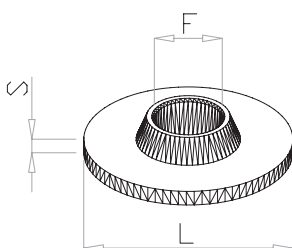

CODICE - CODE	L	S	F
PI17564	40	3	M12
PI17565	40	3	M16
PI17566	40	3	M20
PI17569	42	3	M12
PI17570	42	3	M16
PI17571	42	3	M20
PI17579	48	3	M12
PI17580	48	3	M16
PI17581	48	3	M20
PI17589	50	3	M12
PI17590	50	3	M16
PI17591	50	3	M20
PI17599	60	3	M12
PI17600	60	3	M16
PI17601	60	3	M20