

CODICE - CODE	descrizione description	DIMENSIONI PRINCIPALI - MAIN DIMENSIONS							CARICO STATICO STATIC LOAD NEWTON
		B	D	F	A	H	G	CH	
31150/Z	M10x50	50	80	M10	24	74	15	10	3000
31150/I	M10x50	50	80	M10	24	74	15	10	3000
31152/Z	M10x100	100	80	M10	24	124	15	10	3000
31152/I	M10x100	100	80	M10	24	124	15	10	3000
31154/Z	M12x50	50	80	M12	24	74	15	12	3000
31154/I	M12x50	50	80	M12	24	74	15	12	3000
31156/Z	M12x100	100	80	M12	24	124	15	12	3000
31156/I	M12x100	100	80	M12	24	124	15	12	3000

• Base in poliammide con sede cacciavite per avvitamento automatico, stelo snodato zincato

• Polyamide base with screwdriver seat for automatic screwing. Galvanized steel screw

Assieme Plastica per tubo Ø 50x1,5

Caratteristiche: BASE Ø 80, STELO ARTICOLATO 30°

Features: BASE Ø 80, 30° ARTICULATED STEM

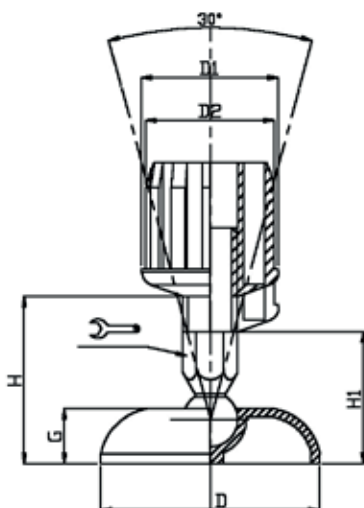

CODICE - CODE	DIMENSIONI PRINCIPALI - MAIN DIMENSIONS							CARICO STATICO STATIC LOAD NEWTON
	D	D1	D2	G	H	H1	CH	
31400	80	50	47	20	65	48	17	1000

• Base, stelo e tappo in poliammide

• Polyamide base, screw and plug