

STAINLESS STEEL TORQUE HINGE HG-TAS

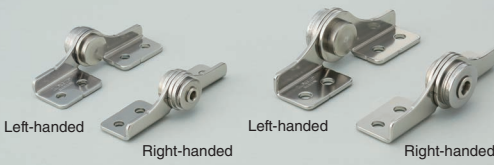

Passed 40,000 open/close private cycle test

Free stop



● Stainless steel construction suitable for corrosive environments.

[Specifications]

● Operating temperature: 0°C ~ 40°C

[Applications]

● LCD, monitoring camera, etc.

[Remarks]

● Be sure to read the "Cautions" .
 ● For pair using: Please use the same torque in both hinges.

● When installing, ensure that both hinge shafts are levelled and aligned.

Selection Tool
Sasuga-kun
 Applicable Products
 Used for Product Selection & Simulation.
 Available on Web!

Video Link



[Application Example]

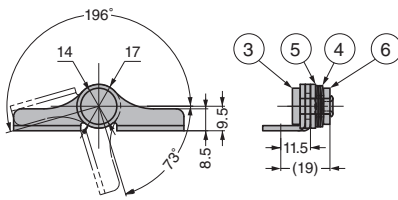
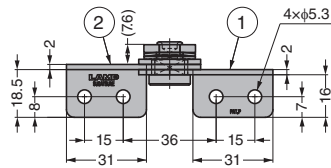
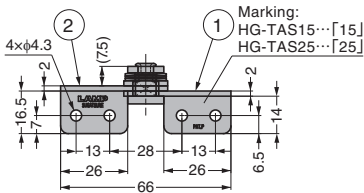
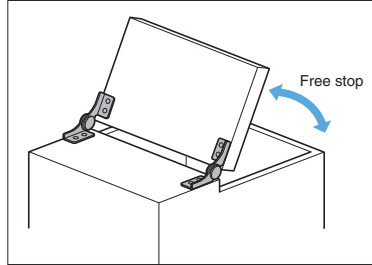

HG-TAS15L, 25L

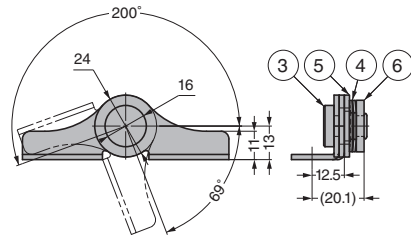

HG-TAS40L

Left-handed type shown. Right-handed type is symmetrical.

No.	Part Name	Material	Finish
①	Body	Stainless Steel (SUS304)	Barrel Polished
②	Base		
③	Shaft	Stainless Steel (SUS303)	-
④	Spring Washer	Stainless Steel (SUS304)	Barrel Polished
⑤	Plate		
⑥	Washer		

RHS	CAD	Item Code	Item Name	Type	Torque N·m/pc	Torque kgf·cm/pc	Weight (g)	Box (pcs)	Carton (pcs)
		170-037-294	HG-TAS15R	Right	1.5 ± 20%	15.3 ± 20%	37	40	320
		170-037-295	HG-TAS15L	Left			37	40	320
		170-037-296	HG-TAS25R	Right	2.5 ± 20%	25.5 ± 20%	38	40	320
		170-037-297	HG-TAS25L	Left			38	40	320
		170-037-298	HG-TAS40R	Right	4.0 ± 20%	40.8 ± 20%	64	20	160
		170-037-299	HG-TAS40L	Left			64	20	160

Refer to : P.15