

## GLASS DOOR BRACKET



## HES3D-G90BKT



## Features

- Glass door bracket for HES3D-90 series (P.470).
- Screw covers match the bracket with the finish. For the black type, please use the covers which are included with the HES3D-90 hinge.

## Parts Included

- Hexagon socket countersunk head screw M5 x 12
- Countersunk head screw M4 x 12
- Hex key size 3

HINGES

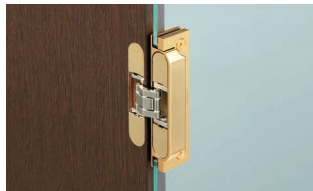

## Door Dimensions and Number of Hinges

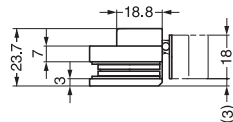
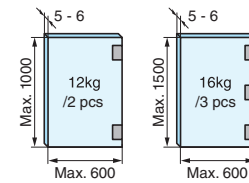

## Cut Out Dimensions

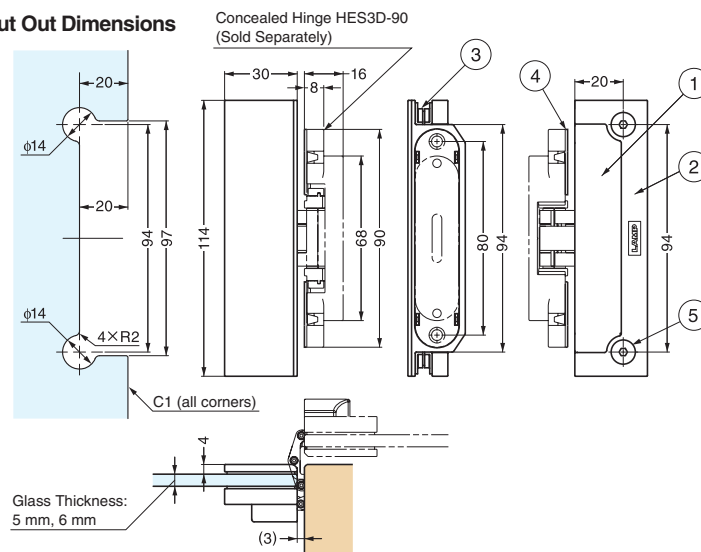

GLASS DOOR BRACKET

No.	Part Name	Material	Finish		
			CR	GP	BL
①	Body	Zinc Alloy (ZDC)	Chrome	24K Gold plating	Black Enamel Finish
②	Back Plate				
③	Gasket	Chloroprene Rubber (CR)	-	-	-
④	Screw Cover	ABS	Chrome	24K Gold plating	-
⑤	Hexagon Socket Countersunk Head Screw M5 x 12	Steel	-	-	Black Enamel Finish

CAD	Item Code	Item Name	Colour	Weight (g)	Box (pcs)	Carton (pcs)
2D/3D	170-035-802	HES3D-G90BKT-CR	Silver	245	2	24
2D/3D	170-035-803	HES3D-G90BKT-GP	Gold	245	2	24
2D/3D	170-035-804	HES3D-G90BKT-BL	Black	245	2	24