

BUTT HINGE FHS

SUS



[Applications]

- Ship, kitchen equipment

[Remarks]

- Load capacity is the value when using two hinges. For calculation conditions, please refer to INDEX 1.

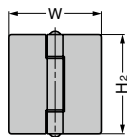

FHS-50, FHS-60, FHS-75

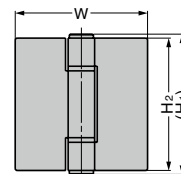

FHS-100, FHS-125, FHS-150

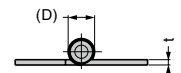
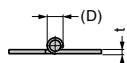
TORQUE
HINGESDAMPER
HINGESLIFT
ASSIST
HINGESDETENT
HINGESCONCEALED
HINGESBUTT
HINGESPIANO
HINGESSTEP
HINGESLIFT-
OFF
HINGES

RoHS	CAD	Item Code	Item Name	Material	Finish	H ₁	H ₂	W	D	t	Knuckles	Load Capacity N/2 pcs	Load Capacity kgf/2 pcs	Weight (g)	Box (pcs)	Carton (pcs)
CE	3D	170-090-479	FHS-50	Stainless Steel (SUS304)	Satin	-	50	50	12	3	3	186	19	90	-	-
CE	3D	170-090-478	FHS-60				60	64				226	23	130	-	-
CE	3D	170-090-477	FHS-75				75	70				275	28	170	-	-
CE	3D	170-090-476	FHS-100			110	100	100	20	4	5	490	50	520	-	40
CE	3D	170-090-475	FHS-125			135	125					569	58	635	-	-
CE	3D	170-090-474	FHS-150			160	150					120	637	65	850	-

Refer to 1 : P.15

PIVOT
HINGESSPRING
HINGESCLEAN
ROOM
HINGESHINGES FOR
ALUMINIUM
FRAMEDROP
HINGESGLASS
DOOR
HINGESSPECIAL
HINGES

BUTT HINGE LSK-1157

SUS



- Additional drilling is also possible. For further details, please contact local representatives.

[Applications]

- Power distribution box, control board, vehicle, ship, etc.

[Remarks]

- Load capacity is the value when using two hinges. For calculation conditions, please refer to INDEX 1.

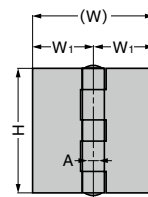

RoHS	CAD	Item Code	Item Name	Material	Finish	H	W ₁	W	A	B	t	Load Capacity N/2 pcs	Load Capacity kgf/2 pcs	Weight (g)	Box (pcs)	Carton (pcs)	
CE	3D	170-090-445	LSK-1157-1	Stainless Steel (SUS304)	Satin	51	25	50	6	6	2.5	127	13	76	10	250	
CE	3D	170-090-446	LSK-1157-2			64	32	64	7	7		3	235	24	141	10	150
CE	3D	170-090-447	LSK-1157-3			76	37	74					284	29	188	10	100
CE	3D	170-090-448	LSK-1157-4			89	43.5	87	8	8	4		333	34	257	10	80
CE	3D	170-090-449	LSK-1157-5			101.6	49.5	99				500	51	417	10	50	
CE	3D	170-090-450	LSK-1157-6			127	59.5	119	11	11		579	59	681	6	30	
CE	3D	170-090-451	LSK-1157-7			152	71.5	143	12	12	647	66	928	4	20		

Refer to 1 : P.15