

WIRE PULL

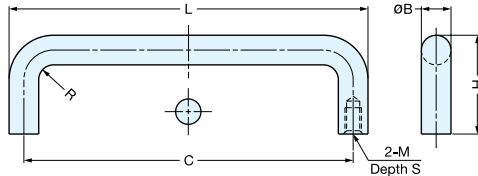

H-42-C



Material	Finish
304 Stainless Steel	Mirror

Item No.	L	H	B	C	S	M	R	Weight (g)	Box (pcs)	Carton (pcs)
H-42-C-8	66 (2-19/32")	22 (55/64")	6	60 (2-23/64")	7	M4 x 0.70	3.0	18	100	500
H-42-C-14	86 (3-25/64")			80 (3-5/32")				25		
H-42-C-1	75 (2-61/64")	30 (1-3/16")	7	68 (2-43/64")	8	M5 x 0.80	3.5	30	50	250
H-42-C-2	109 (4-19/64")			9				100 (3-15/16")		
H-42-C-3	120 (4-23/32")	40 (1-37/64")	10	110 (4-21/64")	8	M6 x 1.00	5.0	100	30	150
H-42-C-4	130 (5-1/8")			120 (4-23/32")				105		
H-42-C-15	162 (6-3/8")	50 (1-31/32")	12	150 (5-29/32")	10	M8 x 1.25	6.0	185	20	40
H-42-C-5	200 (7-7/8")			188 (7-13/32")				220		
H-42-C-6	250 (9-27/32")			238 (9-3/8")				265		
H-42-C-7	300 (11-13/16")			288 (11-11/32")				300		

WIRE PULL



H-42-B

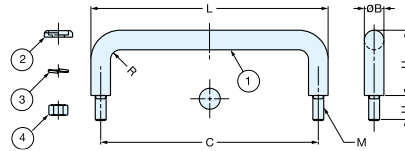

No.	Part Name	Material	Finish
①	Handle	304 Stainless Steel	Mirror
②	Washer		Polished
③	Spring Washer		Plain
④	Nut		

Item No.	L	H ₁	H ₂	B	C	R	M	Weight (g)	Box (pcs)	Carton (pcs)
H-42-B-9	46 (1-13/16")	22 (55/64")	8.5	6	40 (1-37/64")	-	M4 x 0.70	15	50	500
H-42-B-8	66 (2-19/32")		7.0		60 (2-23/64")	3.0		20		
H-42-B-14	86 (3-25/64")	30 (1-3/16")	10.0	7	80 (3-5/32")	3.5	M5 x 0.80	27	50	250
H-42-B-1	75 (2-61/64")				68 (2-43/64")			40		
H-42-B-2	109 (4-19/64")	40 (1-37/64")	11.0	9	100 (3-15/16")	4.5	M6 x 1.00	80	30	150
H-42-B-3	120 (4-23/32")				110 (4-21/64")			120		
H-42-B-4	130 (5-1/8")	50 (1-31/32")	20.0	12	120 (4-23/32")	6.0	M8 x 1.25	125	20	40
H-42-B-15	162 (6-3/8")				150 (5-29/32")			235		
H-42-B-5	200 (7-7/8")				188 (7-13/32")			270		
H-42-B-6	250 (9-27/32")				238 (9-3/8")			320		
H-42-B-7	300 (11-13/16")				288 (11-11/32")			365		

WIRE PULL



H-75-BL-100

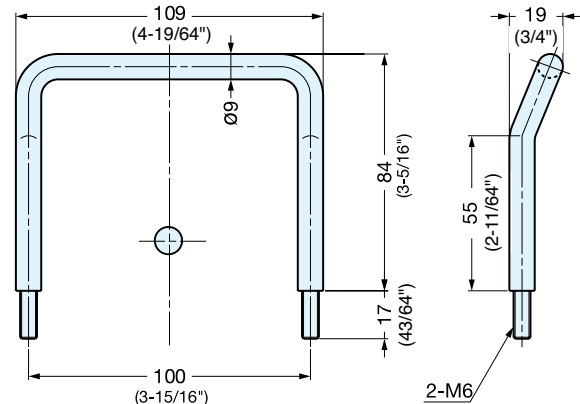

Item No.	Weight (g)	Box (pcs)	Carton (pcs)	Material	Finish
H-75-BL-100	130	80	-	304 Stainless Steel	Mirror