

# DESIGN DOOR HANDLE MDH



- Brackets and pipes can be combined freely.
- Two types of brackets available: In-line type and offset type.
- Pipes are made of stainless steel or carbon fibre reinforced plastic, either has 5 lengths available. By cutting the pipe, the total length can be changed freely.
- Carbon fibre reinforced plastic pipes are subject to UV-cut treatment to prevent discoloration.
- ※ Features of Carbon fibre reinforced plastic.
  - It is a light weight, high-strength materials also widely used for aircraft, etc., contributing to the weight reduction of structure.
  - Also, the delicate mesh pattern brings a unique texture and high-quality feeling.
- Pipes may be sold separately.
- Latch handle MDHL 1 of the same design used for sliding doors also available.

**[Applications]**

- Machine tools and large doors, etc.

**[Remarks]**

- Brackets and pipes have separate item numbers. Please order together by indicating each specification.
- Bracket is sold in pairs.

**[How to Install]**

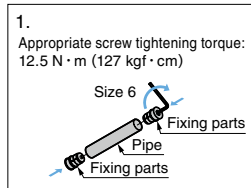

Insert the fixing parts (attached to the bracket) into both ends of the pipe until their flanges contact the pipe ends, and then tighten the screws with a hex key size 6 (not included).

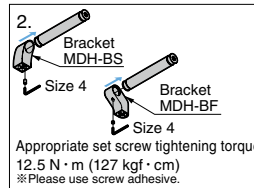

Insert one bracket into the pipe, and tighten the set screws (attached to the bracket) with a hex key size 4 (not included).

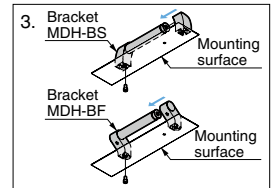

Install one bracket to the mounting surface with M8 screws (not included). Install the other bracket in the same procedure after being preliminarily assembled.

**[Installation of Bracket and Pipe]**

Bracket MDH-BS (Straight type)

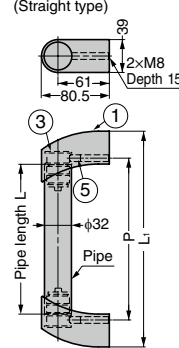

Bracket MDH-BF (Offset type)

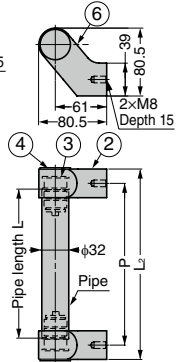

**[Bracket]**



**[Fixing Parts]**

Attached to the bracket



**[Application Example]**

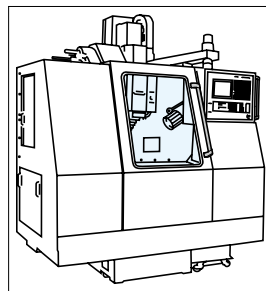

**[Bracket]**

No.	Part Name	Material	Finish/Colour
①	Bracket (Straight)	Zinc Alloy (ZDC)	Matte Chrome
②	Bracket (Offset)		Chrome
③	Fixing Parts		Plain
④	Cover	POM	Black
⑤	Hexagon Socket Set Screw M8 x 15	Stainless	Plain
⑥	Hexagon Socket Set Screw M8 x 8	Steel	

**[Bracket]**

RoHS	CAD	Item Code	Item Name	Type	Parts	Weight (g)	Box (sets)	Carton (sets)
☑	☑	100-022-158	MDH-BS	Straight	①③⑤ (Each 2 pcs)	1010	1	1
☑	☑	100-022-159	MDH-BF	Offset	②③④⑥ (Each 2 pcs)	1122	1	1

**[Pipe]**

RoHS	CAD	Item Code	Item Name	Material	Finish	Pipe Length L	L <sub>1</sub>	L <sub>2</sub>	P	Pipe Thickness	Load capacity N	Load capacity kgf	Weight (g)	Box (pcs)	Carton (pcs)
☑	☑	100-022-161	MDH-PS192	Stainless Steel (SUS304)	Satin	177	256	226	192	2	490	50	384	1	10
☑	☑	100-022-162	MDH-PS350			335	414	384	350				727	1	10
☑	☑	100-022-163	MDH-PS500			485	564	534	500				1050	1	10
☑	☑	100-022-164	MDH-PS800			785	864	834	800				1700	1	10
☑	☑	100-022-165	MDH-PS1200			1185	1264	1234	1200				2570	1	7
☑	☑	100-022-166	MDH-PC192	Carbon Fibre Reinforced Polymer (CFRP)	Paint/Clear	177	256	226	192	2.5	490	50	70	1	1
☑	☑	100-022-167	MDH-PC350			335	414	384	350				132	1	1
☑	☑	100-022-168	MDH-PC500			485	564	534	500				191	1	1
☑	☑	100-022-169	MDH-PC800			785	864	834	800				309	1	1
☑	☑	100-022-170	MDH-PC1200			1185	1264	1234	1200				467	1	1

Refer to 1 : P.536