

LATCH HANDLE MDHL



LARGE HANDLES

HANDLES (FRONT SCREW MOUNT)

HANDLES (BACK SCREW MOUNT)

RECESSED PULLS

PULLS & KNOBS

LATCH HANDLES

- Latch handle for sliding doors of machine tools, etc.
 - Latch is released when pulling the handle.
 - Brackets and pipes can be combined freely.
 - Two types of brackets available: In-line type and offset type.
 - Pipes are made of stainless steel or carbon fibre reinforced plastic, either has 6 lengths available. By cutting the pipe, the total length can be changed freely.
 - Carbon fibre reinforced plastic pipes are subject to UV-cut treatment to prevent discoloration.
- What is carbon fibre reinforced plastic?
- It is a light weight, high-strength materials also widely used for aircraft, etc., contributing to the weight reduction of structure. Also, the delicate mesh pattern brings a unique texture and high-quality feeling.
- Pipes may be sold separately.
 - Linear rail for sliding doors with latch handles also available.
 - Design door handle MDH 1 of the same appearance without latch also available.

[Remarks]

- Brackets and pipes have separate item numbers. Please order together by indicating each specification.
- Bracket is sold by piece.
- Hold the centre of handle for operation. Otherwise, the latch may not operate properly.

[Bracket]



DESIGN DOOR HANDLE MDH 1

[Installation Direction of Bracket]

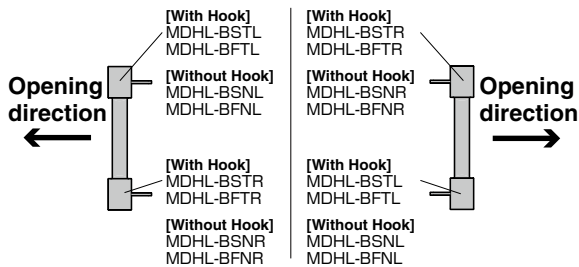

[How to Install]

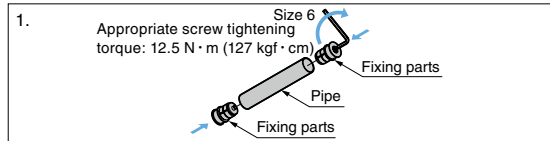

Insert the fixing parts (attached to the bracket) into both ends of the pipe until their flanges contact the pipe ends, and then tighten the screws with a hex key size 6 (not included).

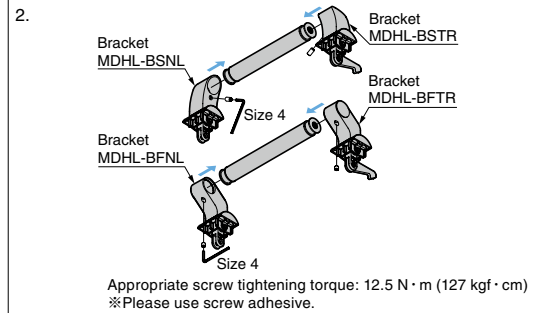

Insert the brackets on both sides into the pipe, and tighten the set screws (attached to the bracket) with a hex key size 4 (not included).

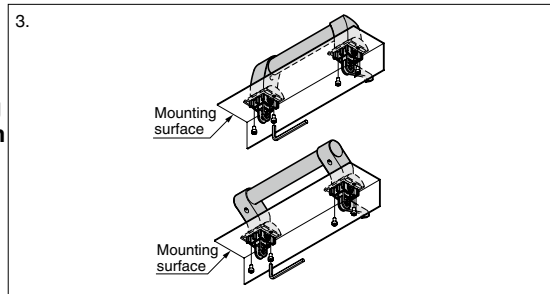

Refer to 1 : P.462

