

**HANDLE**

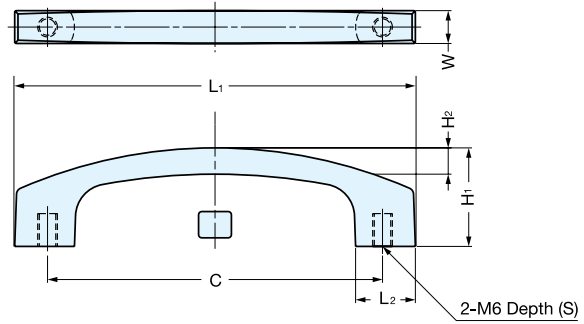

**SAZ**



Item No.	L <sub>1</sub>	L <sub>2</sub>	C	S	W	H <sub>1</sub>	H <sub>2</sub>	Weight (g)	Box (pcs)	Carton (pcs)	Material	Finish
SAZ-121	121 (4-49/64")	17.5	102 (4-1/64")	9	10	28 (1-3/32")	5	85	40	400	Zinc Alloy	Chrome

**HANDLE**



**936 SERIES**

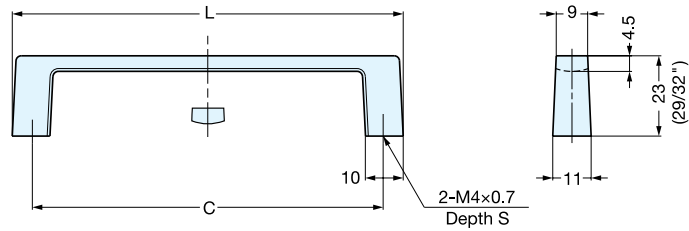

Item No.	L	C	S	Weight (g)	Box (pcs)	Carton (pcs)	Screw	Material	Finish
936-55-SCR	66.5 ( 2-5/8" )	55.0 (2-11/64")	8	40	50	200	M4x25	Zinc Alloy	Satin Chrome (SCR)
936-100-DC	112.0 (4-13/32")	100.5 (3-61/64")	10	52			M4x28		Dull Chrome (DC)

**HANDLE**



**XLA-HA**

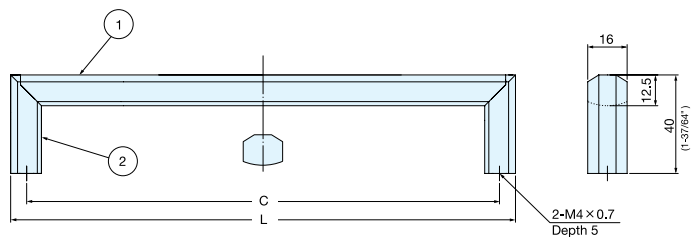

Item No.	L	C	Weight (g)	Box (pcs)	Carton (pcs)
XLA-HA96	109 ( 4-19/64" )	96 ( 3-25/32" )	132	20	80
XLA-HA128	141 ( 5-35/64" )	128 ( 5-1/32" )	142		
XLA-HA192	205 ( 8-5/64" )	192 ( 7-9/16" )	144		
XLA-HA256	269 ( 10-19/32" )	256 ( 10-5/64" )	180	10	60
XLA-HA320	333 ( 13-7/64" )	320 ( 12-19/32" )	200		

No.	Part Name	Material	Finish
①	Body	Aluminum Alloy	Anodized
②	Leg	Zinc Alloy	Matte Silver