

# INSET DOOR PIVOT HINGE



PH



Left (for left-lower / right-upper)

**Remarks**

Sold in pairs.

**Parts Included**

- Countersunk head wood screw 3.1x20 (SUS) (PH-50, 60)
- Countersunk head wood screw 3.8x25 (SUS) (PH-80, 90)

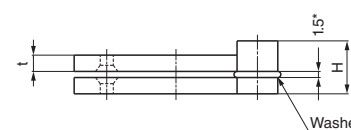
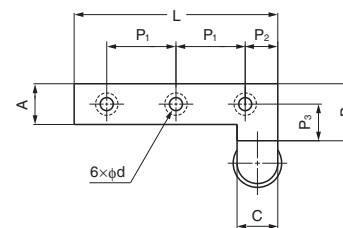
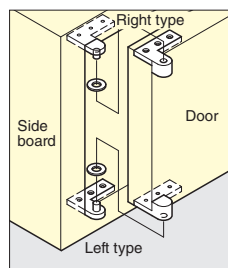

Right type shown.

\* Only PH-50 comes with 0.8 mm thick washer.

Item Code	Item Name	Material	Finish	L	t	H	A	B	C	P <sub>1</sub>	P <sub>2</sub>	P <sub>3</sub>	d	Door				Weight	Box	Carton
														Width	Height	Thickness	Weight			
170-090-984	PH-50	Brass	Satin Nickel	50	4	13.3	10	14	10	17	8	9	3.2	Max. 450	Max. 700	Min. 14 mm	Max. 2.6 kg/pair	40 g	10 pairs	200 pairs
170-090-976	PH-60	Brass	Satin Nickel	60	4.5	15	12	16	12	21	9	9	3.2	Max. 450	Max. 700	Min. 16 mm	Max. 2.6 kg/pair	60 g	10 pairs	200 pairs
170-090-985	PH-80	Brass	Satin Nickel	80	6	21	16	20	15	30	10	12	4.2	Max. 450	Max. 700	Min. 20 mm	Max. 4 kg/pair	170 g	8 pairs	32 pairs
170-090-986	PH-95	Brass	Satin Nickel	95	6.5	23	19	28	16	35	12.5	18.5	4.2	Max. 450	Max. 700	Min. 28 mm	Max. 4 kg/pair	250 g	6 pairs	24 pairs

# INSET DOOR PIVOT HINGE

TTS-902

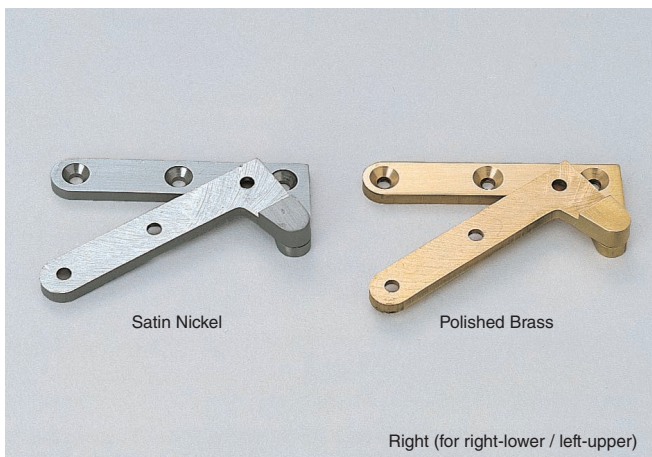

Satin Nickel

Polished Brass

Right (for right-lower / left-upper)

**Remarks**

Sold by piece.

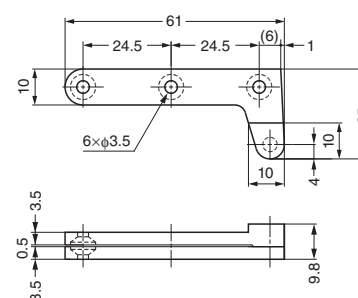
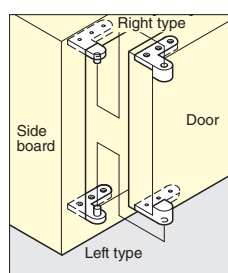

Right type shown.

Item Code	Item Name	Type	Material	Finish	Weight	Box
170-090-126	TTS-902WBL	Left (for left-lower / right-upper)	Brass	Satin Nickel	41 g	20 pairs
170-090-125	TTS-902WBR	Right (for right-lower / left-upper)	Brass	Satin Nickel	41 g	20 pairs
170-090-128	TTS-902ML	Left (for left-lower / right-upper)	Brass	Polished	43 g	20 pairs
170-090-127	TTS-902MR	Right (for right-lower / left-upper)	Brass	Polished	43 g	20 pairs

