

160° Opening **18 mm Overlay** **Overlay 9 - 18 mm** **Cup Dia Φ 40 Bore Depth 15 mm Door Thickness 18 - 34 mm** **Mounting Plate 100 Series (P.389-392)**

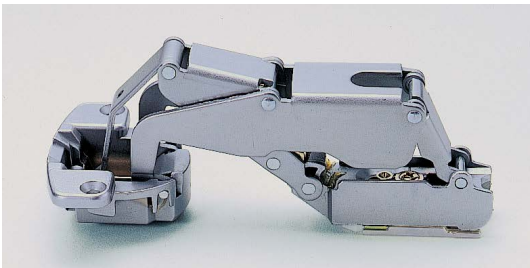

Picture above is the combination of concealed hinge and mounting plate.

CONCEALED HINGE H160

Item Code	Item Name	Type	Material	Finish	Weight	Carton
160-073-622	H160-34/18	w/o Catch	Zinc Alloy (ZDC)	Chrome	193 g	100 pcs
160-073-632	H160-C34/18	w/ Catch	Zinc Alloy (ZDC)	Chrome	205 g	100 pcs

Features

Screw mount.

Sold Separately

100 series mounting plate (P.389-392).

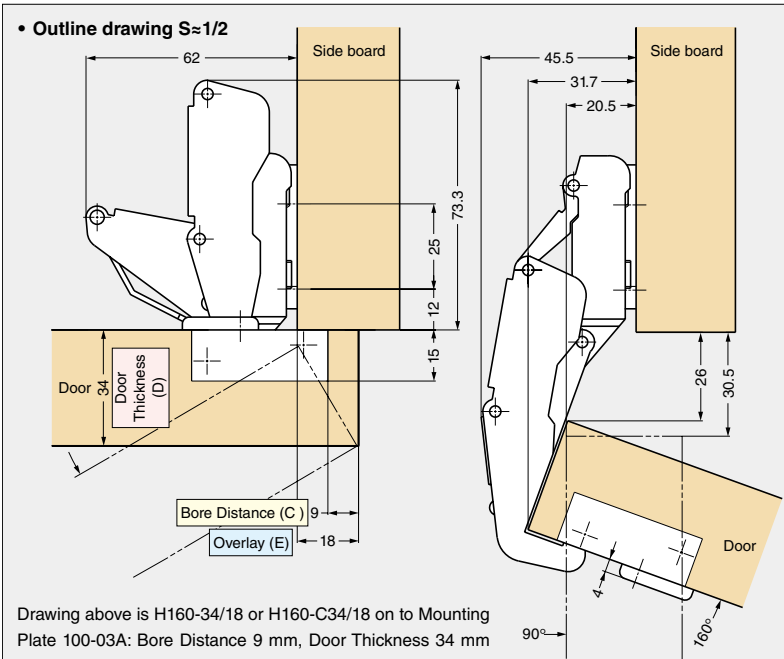

Drawing above is H160-34/18 or H160-C34/18 on to Mounting Plate 100-03A: Bore Distance 9 mm, Door Thickness 34 mm and 18 mm Overlay.

• **Locus chart S≈1/1**

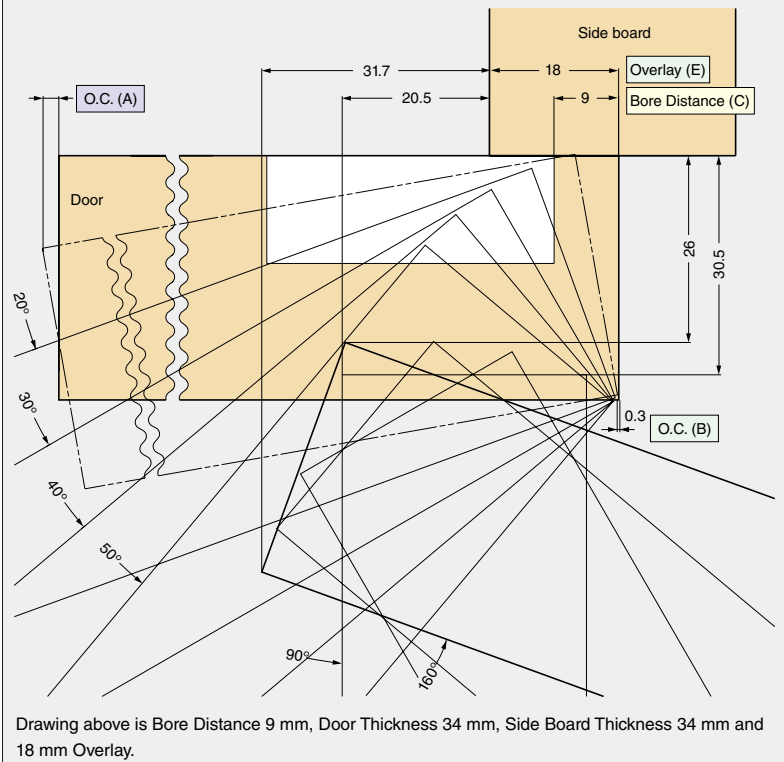

Drawing above is Bore Distance 9 mm, Door Thickness 34 mm, Side Board Thickness 34 mm and 18 mm Overlay.

Bore Distance (C)

Bore Distance (C)	3	4	5	6	7	8	9
Overlay (E)	12	13	14	15	16	17	18

For standard type mounting plate 0 mm thickness.

Turning the overlay adjustment screw or using distance plate (2 mm thickness) to adjust overlay (Max. - 6 mm).

Opening Clearance (O.C.)

Clearances for door edge O.C. (A) and hinge side O.C. (B) are necessary. O.C. (A) and (B) change depending on door thickness and bore distance (C). Refer to locus chart and tables below when designing cabinets.

O.C. (B)

Door Thickness (D)	Bore Distance (C)						
	3	4	5	6	7	8	9
Max. 33	Max. 0.2						
34	0.3	0.3	0.3	0.3	0.3	0.3	0.3
35	0.7	0.7	0.7	0.7	0.7	0.6	0.5
36	3.2	3.0	2.7	2.3	1.6	1.3	0.9
37	5.0	4.4	3.8	3.2	2.6	2.1	1.6
38	6.2	5.5	4.8	4.2	3.5	2.9	2.4
39	7.2	6.4	5.7	5.1	4.4	3.9	3.3
40	8.3	7.3	6.6	6.0	5.4	4.7	4.2
O.C. (B)							

Please refer to the locus chart if door thickness is over 34 mm.

O.C. (A)

Door Thickness (D)	Door Width			
	300	400	500	600
20	1.4	1.1	0.8	0.7
30	1.8	1.3	1.0	0.8
34	1.8	1.3	1.0	0.8
O.C. (A)				

Cut Out Dimensions

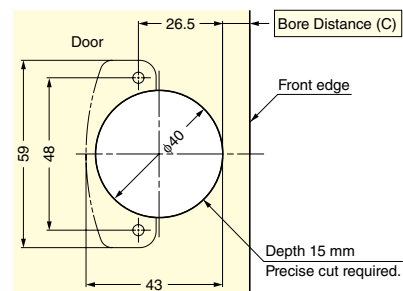

• **Recommended screw**

Size 3.5 raised countersunk head tapping screw or wood screw.

Door Dimensions and Number of Hinges

Please refer to P.394.