

160° Opening

Inset

Cup Dia Φ 40 Bore Depth 15 mm
Door Thickness 18 - 34 mm

Mounting Plate 100 Series
(P.389-392)

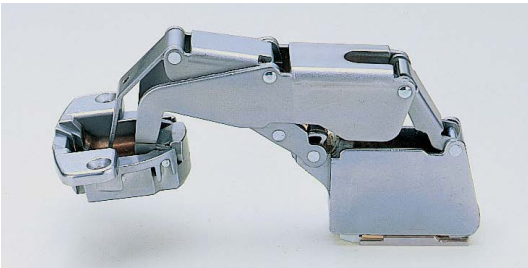

CONCEALED HINGE

H160

Item Code	Item Name	Type	Material	Finish	Weight	Carton
160-073-623	H160-34/0	w/o Catch	Zinc Alloy (ZDC)	Chrome	234 g	100 pcs
160-073-633	H160-C34/0	w/ Catch	Zinc Alloy (ZDC)	Chrome	242 g	100 pcs

Option

100 series mounting plate (P.389-392).

Picture above is the combination of concealed hinge and mounting plate.

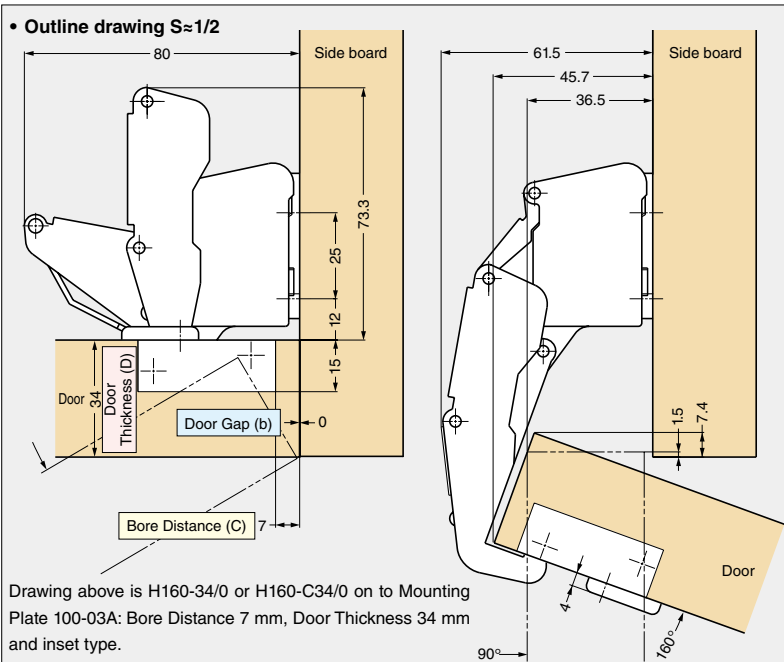

• Locus chart $S \approx 1/1$

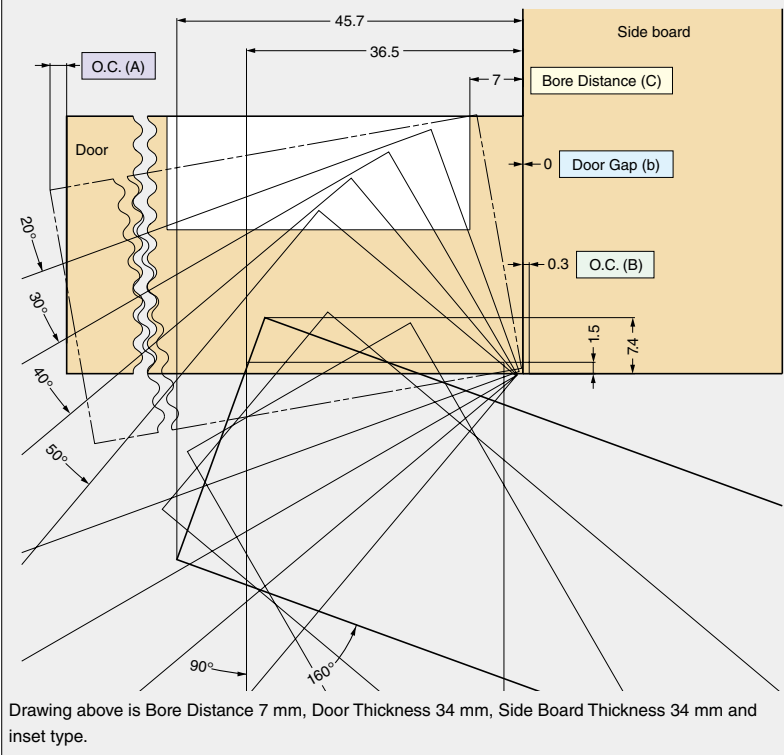

Bore Distance (C)

Bore Distance (C)	3	4	5	6	7
Door Gap (b)	4	3	2	1	0

For standard type mounting plate 0 mm thickness.

Turning the overlay adjustment screw to adjust the gap.

Opening Clearance (O.C.)

Clearances for door edge O.C. (A) and hinge side O.C. (B) are necessary. O.C. (A) and (B) change depending on door thickness and bore distance (C). Refer to locus chart and tables below when designing cabinets.

O.C. (B)

Door Thickness (D)	Bore Distance (C)				
	3	4	5	6	7
Max. 30	Max. 0.1				
31	0.1	0.1	0.1	0.1	0.1
32	0.2	0.2	0.2	0.2	0.2
33	0.2	0.2	0.2	0.2	0.2
34	0.3	0.3	0.3	0.3	0.3
35	0.9	0.9	0.9	0.8	0.8
36	3.4	3.1	2.8	2.2	1.6
O.C. (B)					

Please refer to the locus chart if door thickness is over 34 mm.

O.C. (A)

Door Thickness (D)	Door Width			
	300	400	500	600
20	1.4	1.1	0.8	0.7
30	1.7	1.3	1.0	0.8
34	1.7	1.3	1.0	0.8
O.C. (A)				

Cut Out Dimensions

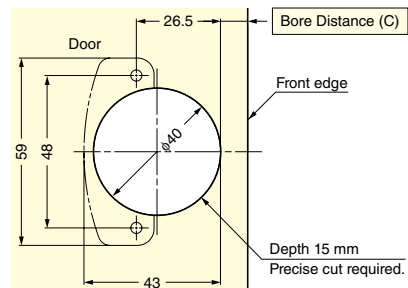

Recommended screw

Size 3.5 raised countersunk head tapping screw or wood screw.

Door Dimensions and Number of Hinges

Please refer to P.394.